

平面锁型号说明

Panel lock model description

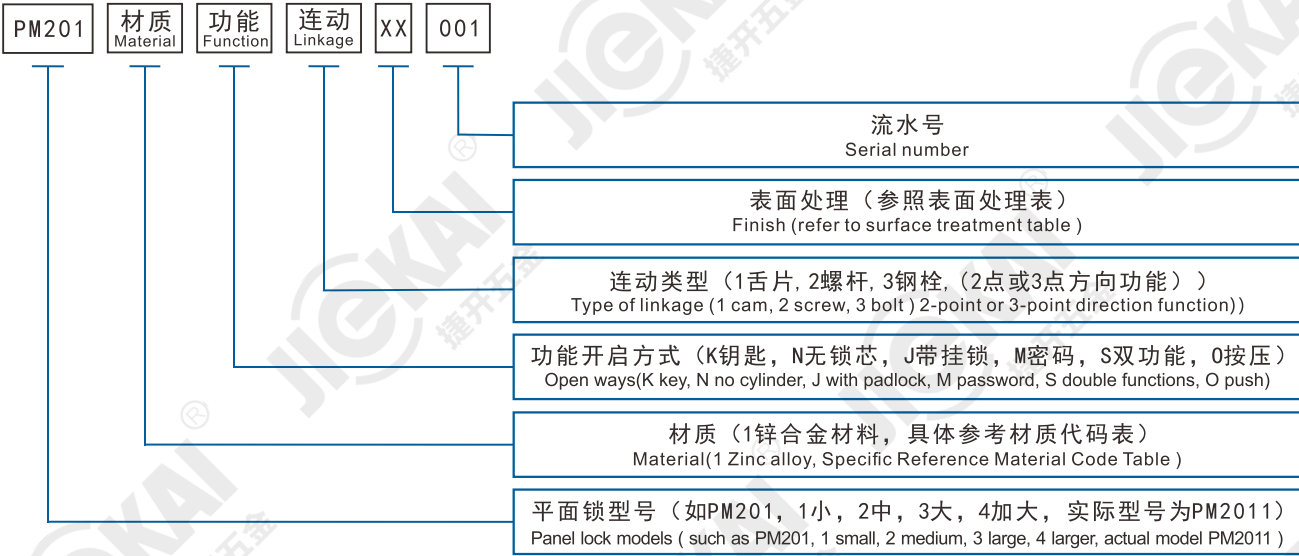

举例说明:一款PM223的平面锁,为加大款,开启方式为钥匙,锌合金材质,表面处理为喷漆哑光银,带舌片
型号编码为: PM2234-1K1-P0
注:如产品无规格大小区分,直接PM223
注: S双功能 S=(K+J K+M K+O J+M M+O)
For example : a PM223 plane lock, is enlarged, opened by key, zinc alloy material, surface treatment is painting matte silver, with a cam.
Model code : PM2234-1K1-P0
Note : If the product has no specification size distinction, direct Pm223
Note : S double functions S=(K+J K+M K+O J+M M+O)

平面锁安装示意图

Panel lock installation diagram

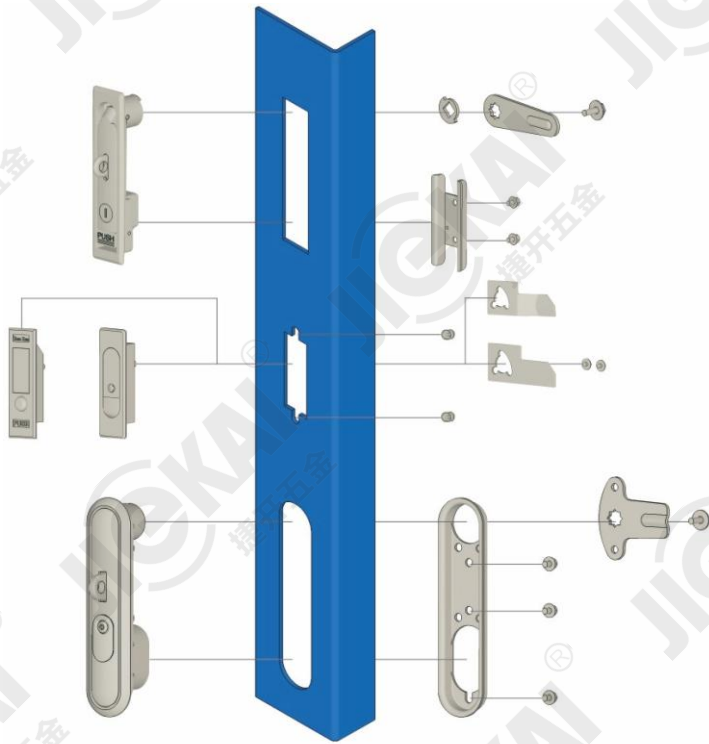

PM201系列

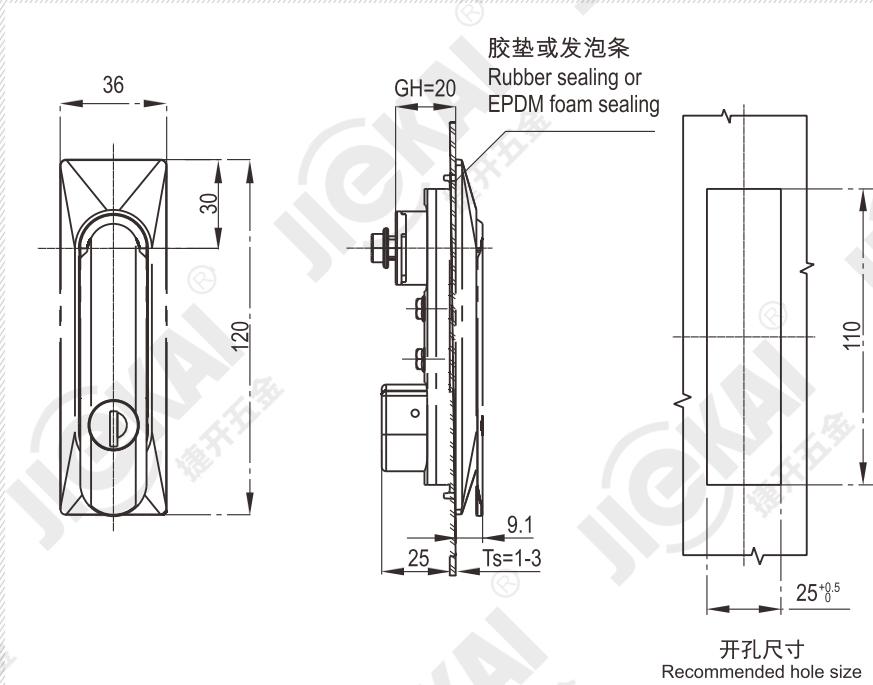

类型 Type	总长 Total length	开孔 Opening	锌合金手柄, 塑料座 Zinc die handle, PA housing	全锌合金 Zinc die	全塑料 PA
小型 Small size	120mm	110mm	PM2011-7K1-P2	PM2011-1K1-P2	PM2011-7K1-XX
大型 Large size	160mm	150mm	PM2013-7K1-P2		
带挂 Padlock able	160mm	150mm	PM2013-7S1-P2	PM2013-1S1-P2	



产品说明

Description

- ◆ 黑色PA塑料锁座或锌合金锁座, 锌合金锁柄、转轴, 镀锌钢安装紧固件
Black PA or zinc die lock housing, zinc die handle black powder coated, zinc die shaft and m.s. zinc plated fixing parts.

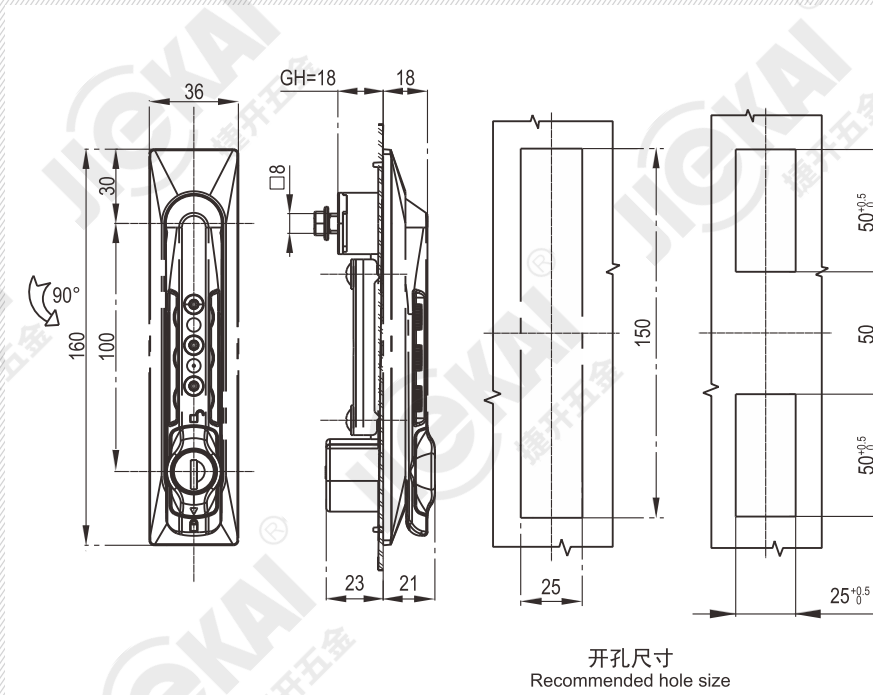

密码型 Code mode	锌合金手柄, 塑料座 Zinc die handle, PA housing
	PM201-7M1-XX

PM202系列



产品说明

- ◆ 镀锌钢螺栓、螺杆, 锌合金黑色锁座、锁柄、
锌合金镀铬挂锁扣
- Galvanized steel locking tongue, screw bar, zinc alloy black
coated lock body, lock handle, chrome plated padlock-ring

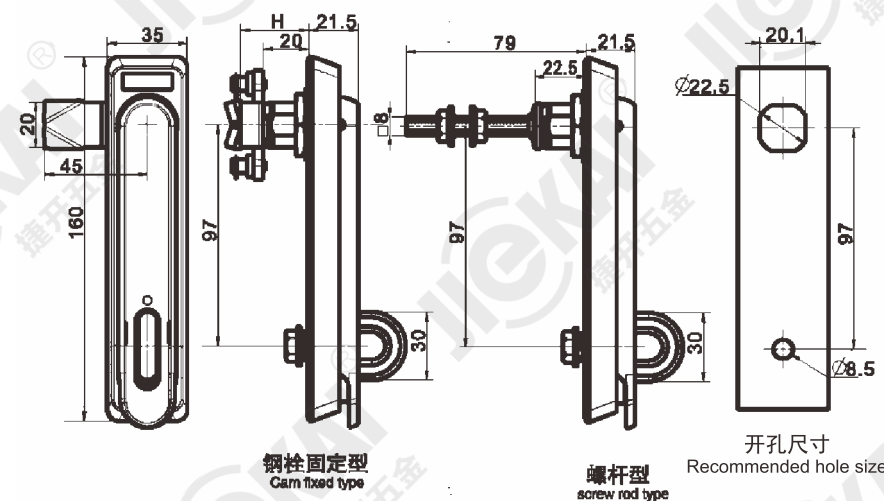

<p>螺杆型 Screw rod type</p> <p>PM202-1J2-P2</p>	<p>钢栓固定型 Cam fixed type</p> <p>PM202-1J3-P2</p>
---	---

PM204系列



产品说明

- ◆ 镀锌钢钢栓、螺杆, 锌合金镀铬锁座、锁柄
Galvanized steel locking tongue, screw bar, chrome
plated lock body, lock handle

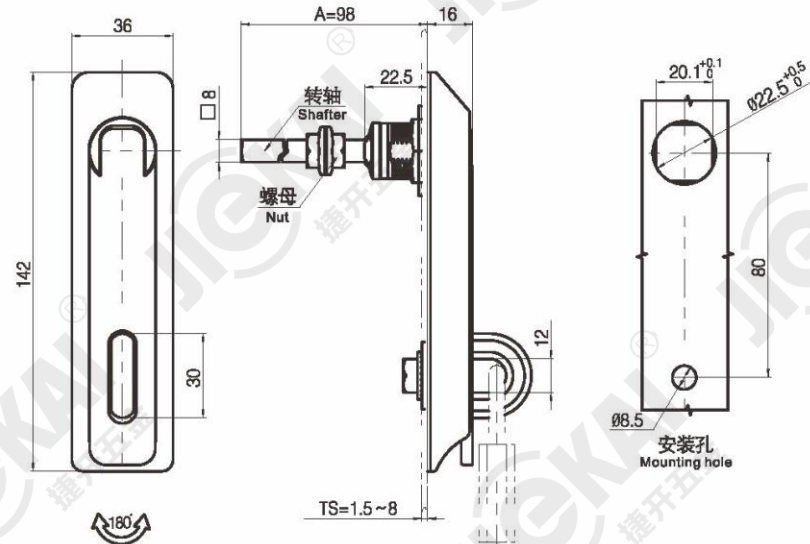

锌合金, 镀铬 Zinc alloy, chromed	不锈钢 Stainless steel
PM204-1J2-E1	SC204-3J2-XX

PM203系列

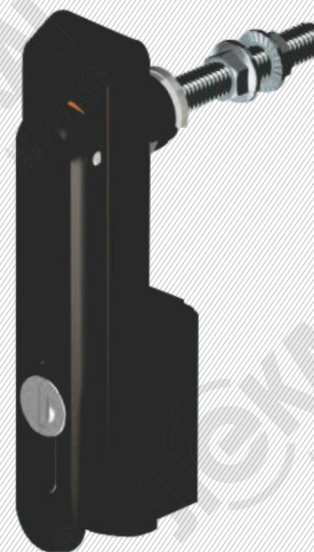

产品说明

- ◆ 镀锌钢钢栓、压板、螺杆，锌合金黑色或不
锈钢锁座、锁柄，黑色尼龙后盖
- Galvanized steel locking tongue, screw bar and
press plate, zinc alloy black coated or stainless
steel lock body, lock handle, black nylon solenoid
Rear cover

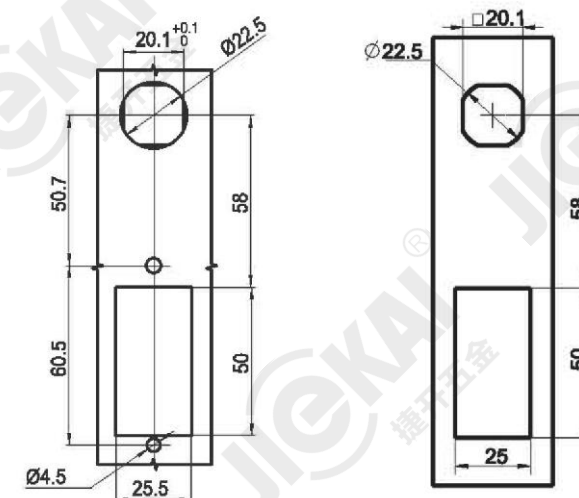
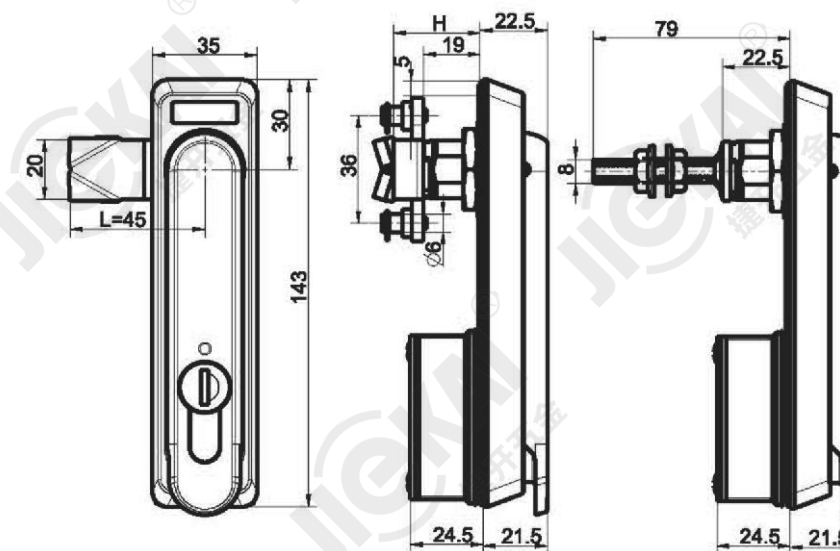

开孔尺寸
Recommended hole size

钢栓固定型 Cam fixed type		螺杆型 Screw rod type	
锌合金, 黑色喷涂 Zinc alloy, black coated	不锈钢 Stainless steel	锌合金, 黑色喷涂 Zinc alloy, black coated	不锈钢 Stainless steel
PM203-1K3-P2	SC203-3K3-P2	PM203-1K2-P2	SC203-3K2-P2

PM204系列



产品说明
Description

◆ 镀锌钢钢栓、螺杆，锌合金镀铬锁座、锁柄
Galvanized steel locking tongue, screw bar, chrome plated lock body, lock handle

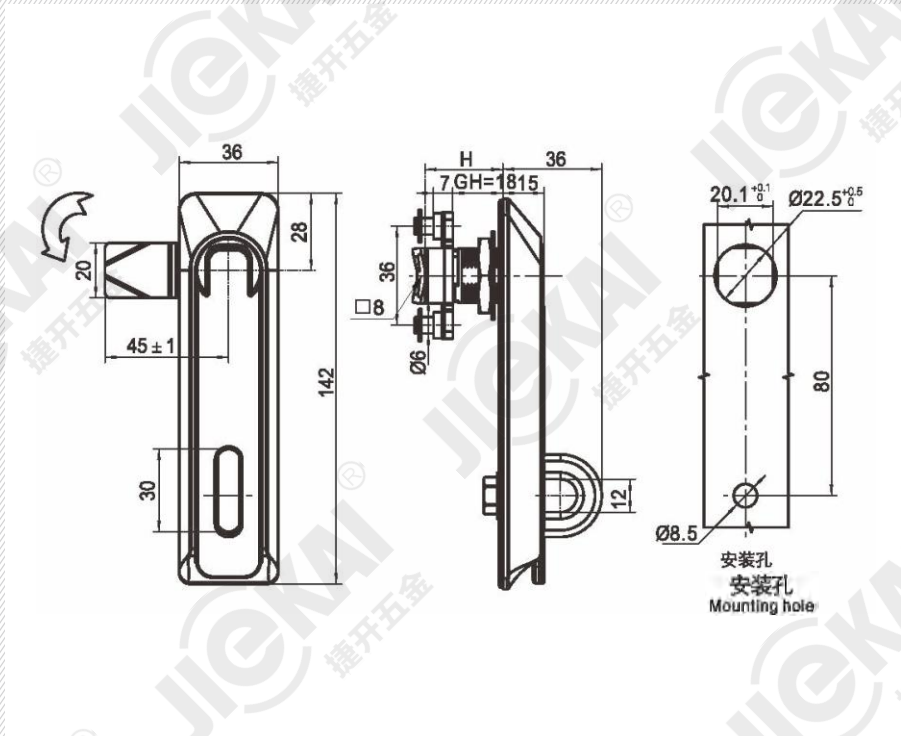

锌合金, 镀铬 Zinc alloy, chromed PM204-1J3-E1	不锈钢 Stainless steel SC204-3J3-XX
--	--

PM205系列



产品说明
Description

◆ 镀锌钢钢栓、螺杆，锌合金镀铬锁座、锁柄
Galvanized steel locking tongue, screw bar, chrome plated lock body, lock handle

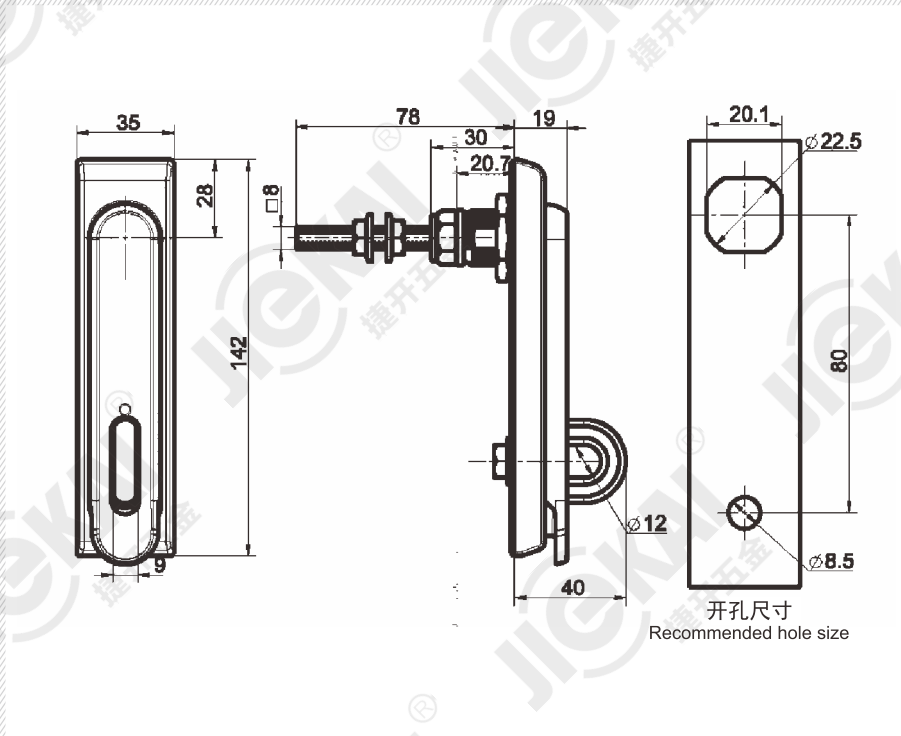

锌合金, 镀铬 Zinc alloy, chromed PM205-1J2-E1	不锈钢 Stainless steel SC205-3J2-XX
--	--

PM205系列



产品说明
Description

◆ 镀锌钢钢栓、螺杆，锌合金镀铬锁座、锁柄
Galvanized steel locking tongue, screw bar, chrome plated lock body, lock handle

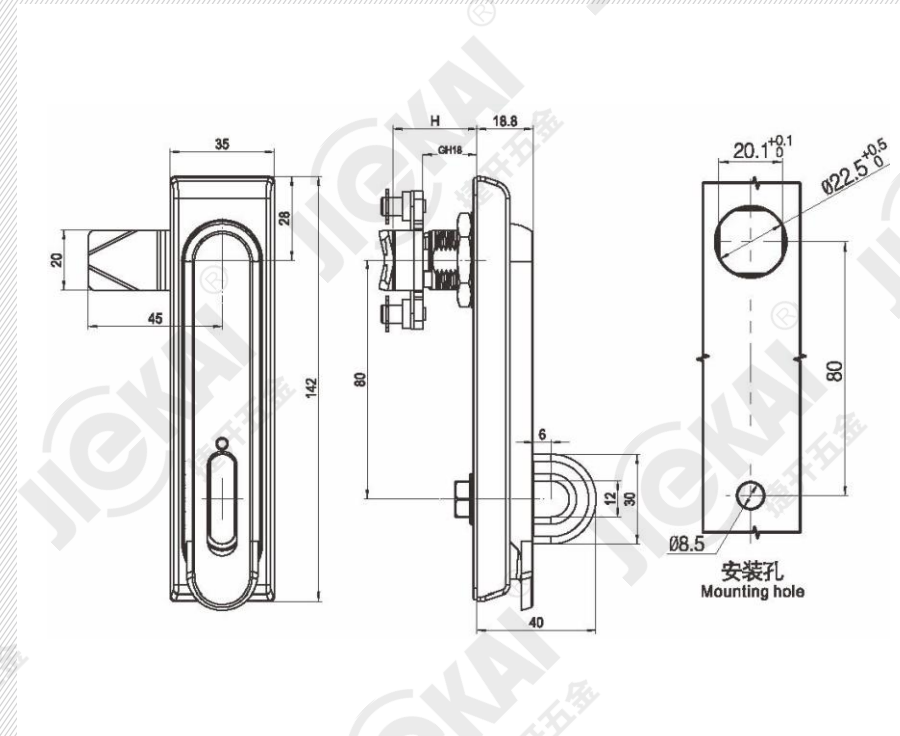

锌合金, 镀铬 Zinc alloy, chromed PM205-1J3-E1	不锈钢 Stainless steel SC205-3J3-XX
--	--

PM206



产品说明
Description

◆ 镀锌钢钢栓、螺杆，锌合金镀铬锁座、锁柄
Galvanized steel locking tongue, screw bar, chrome plated lock body, lock handle

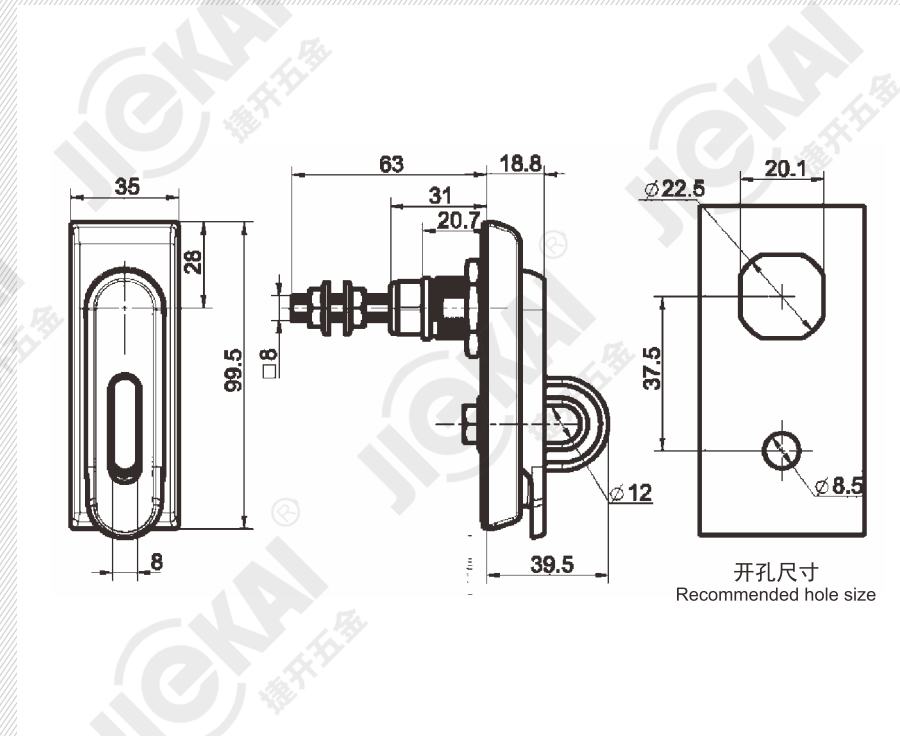

锌合金, 镀铬, 螺杆型 Zinc alloy, chromed, screw rod type PM206-1J2-E1

PM207系列

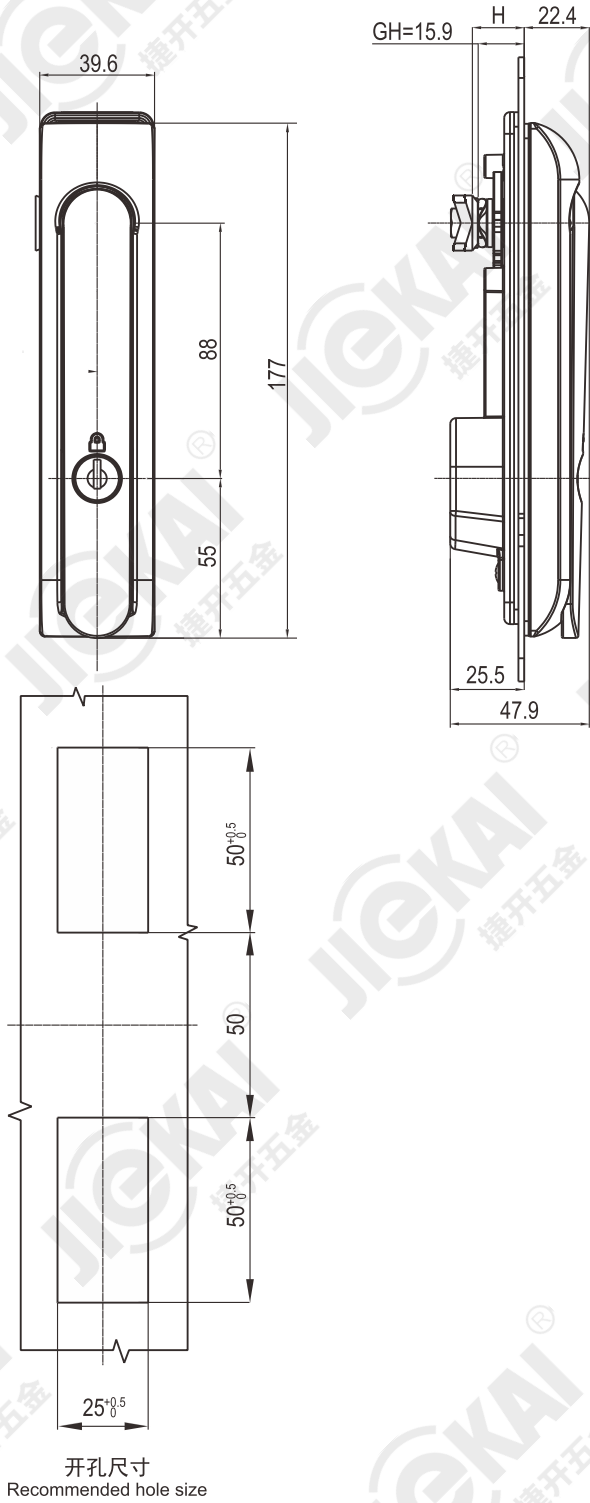

产品说明
Description

◆ 锌合金锁座, 表面处理可做喷塑及电镀
Zinc die body, black powder coated or plating.

锁芯型号 Lock cylinder model	麻面黑 Black textured powder coated	亮铬 Bright chrome
CH 751锁芯 Cylinder	PM207-1K1-P2	PM207-1K1-E1
	PM207-1S1-P2	PM207-1S1-E1
三角锁芯 8mm(Triangular 8mm)	PM207-131-P2	PM207-131-E1
	PM207-13J1-P2	PM207-13J1-E1

SC208



产品说明
Description

◆ 不锈钢锁座、锁柄, 拉丝抛光
Stainless steel lock body, lock handle drawing polishing.

PM209



产品说明
Description

◆ 镀锌钢锁栓, 螺杆, 锌合金镀铬锁座、锁柄
Galvanized steel locking tongue, screw bar, chrome plated lock body, lock handle.

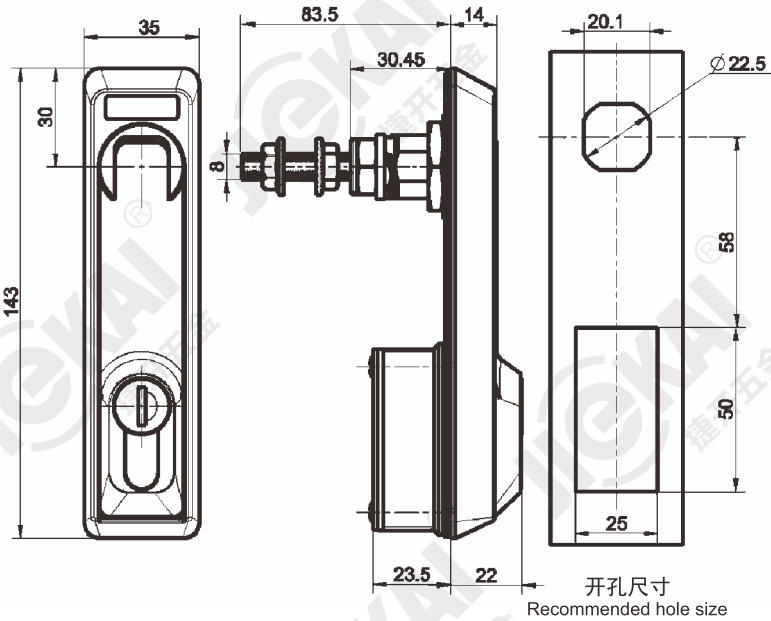

规格型号
Specifications
SC208-3K2-M2

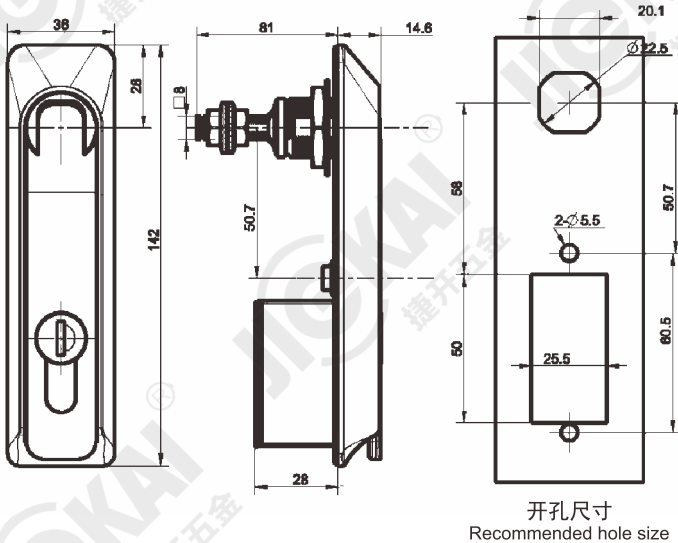

规格型号
Specifications
PM209-1K2-E1

平面锁 Plane lock

PM210系列



产品说明
Description

◆ 镀锌钢钢栓, 螺杆, 锌合金黑色锁座
Galvanized steel locking tongue, screw bar, zinc alloy black coated lock body.

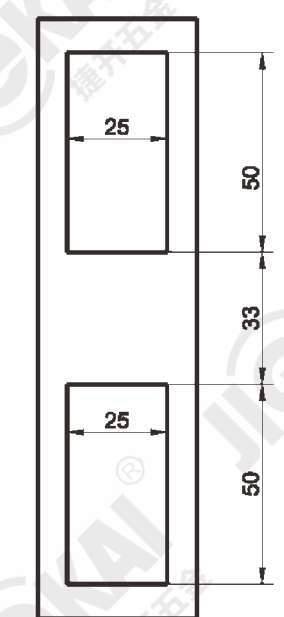
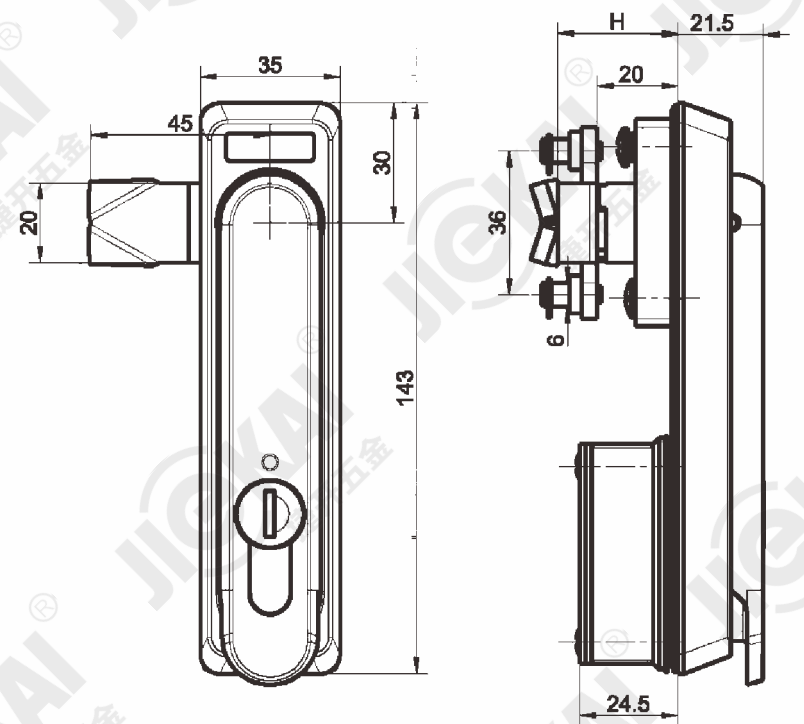

开孔尺寸
Recommended hole size

规格型号
Specifications
PM210-1K3-P2

平面锁 Plane lock

PM211



产品说明
Description

◆ 镀锌钢钢栓, 压板, 锌合金黑色锁座
Galvanized steel locking tongue, clamp, zinc alloy black coated lock body.

PM212



产品说明
Description

◆ 镀锌钢钢栓, 压板, 锌合金黑色锁座
Galvanized steel locking tongue, clamp, zinc alloy black coated lock body.

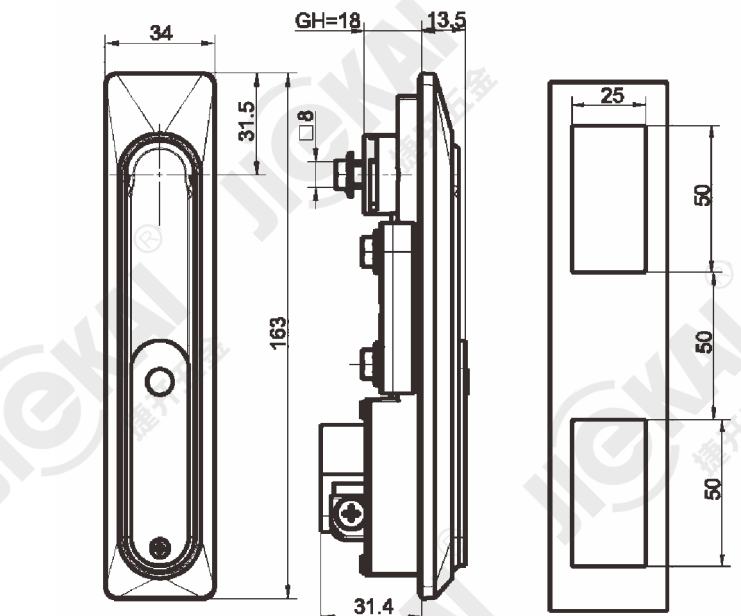

开孔尺寸
Recommended hole size

规格型号
Specifications
PM211-1K3-P2

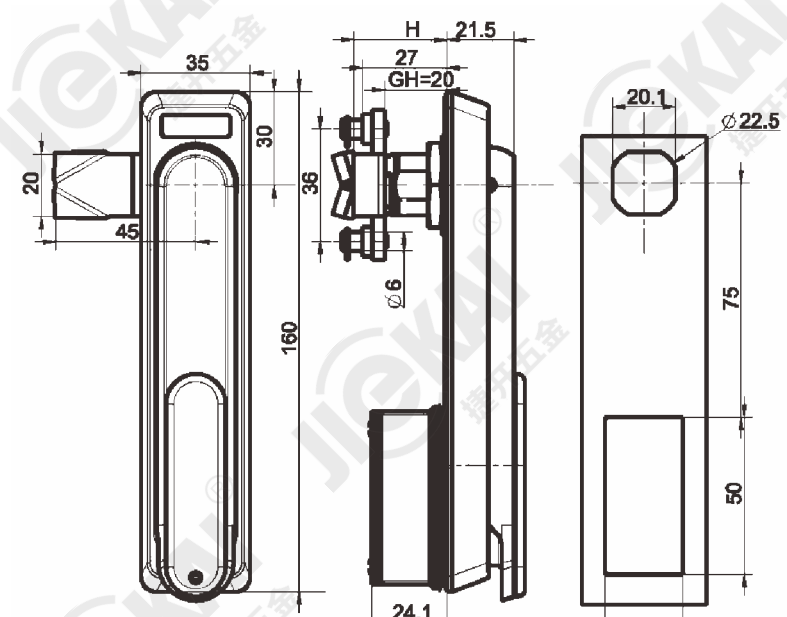

开孔尺寸
Recommended hole size

规格型号
Specifications
PM212-1K3-P2

PM213系列



产品说明
Description

- ◆ 镀锌钢钢栓, 压板, 锌合金黑色锁座
Galvanized steel locking tongue, clamp, zinc alloy black coated lock body.

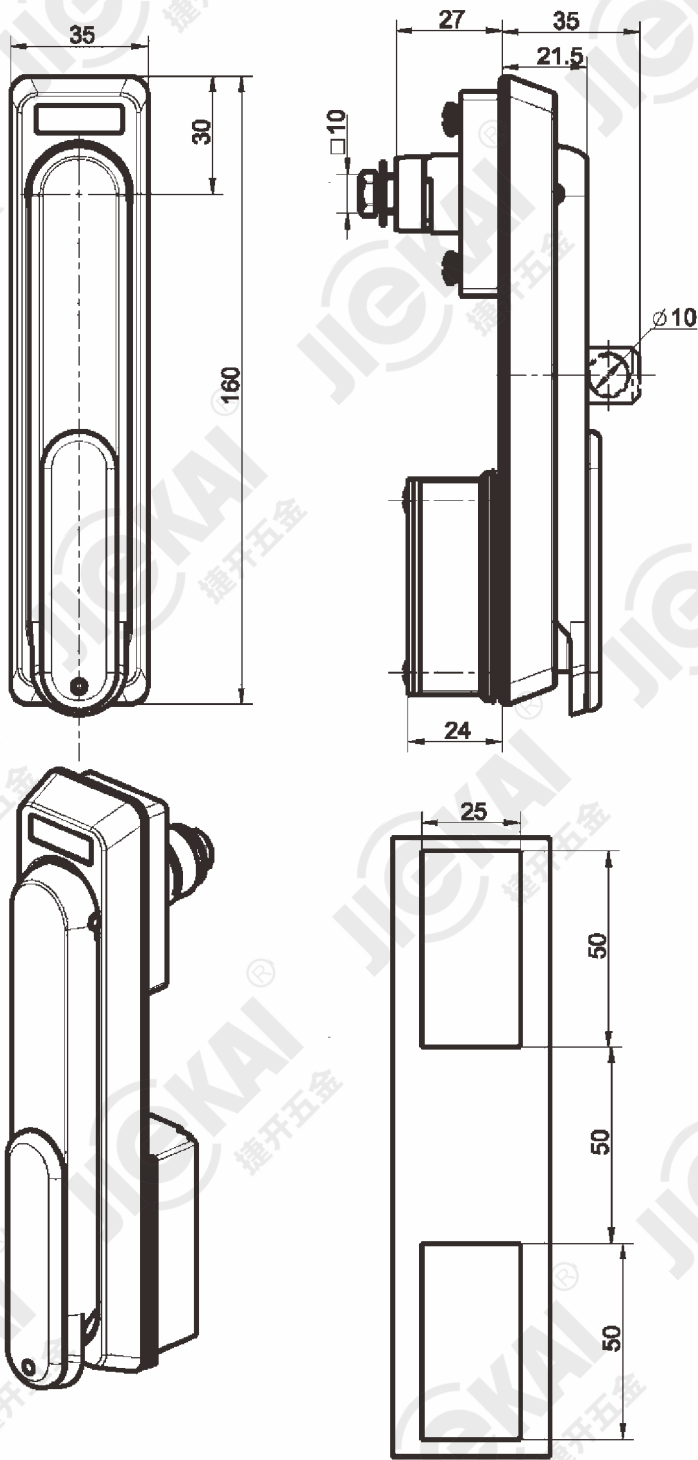

开孔尺寸
Recommended hole size

标准型
Standard
PM213-1K3-P2

挂锁型
Padlock type
PM213-1S3-P2

PM214

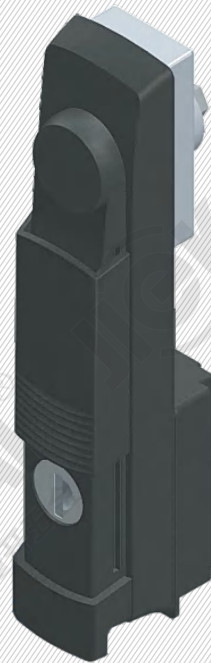

产品说明
Description

- ◆ 黑色PA塑料锁座, 铜转轴镀锌钢安装
紧固件
PA lock body, brass handle shaft, m.s zinc plated
fixing parts.

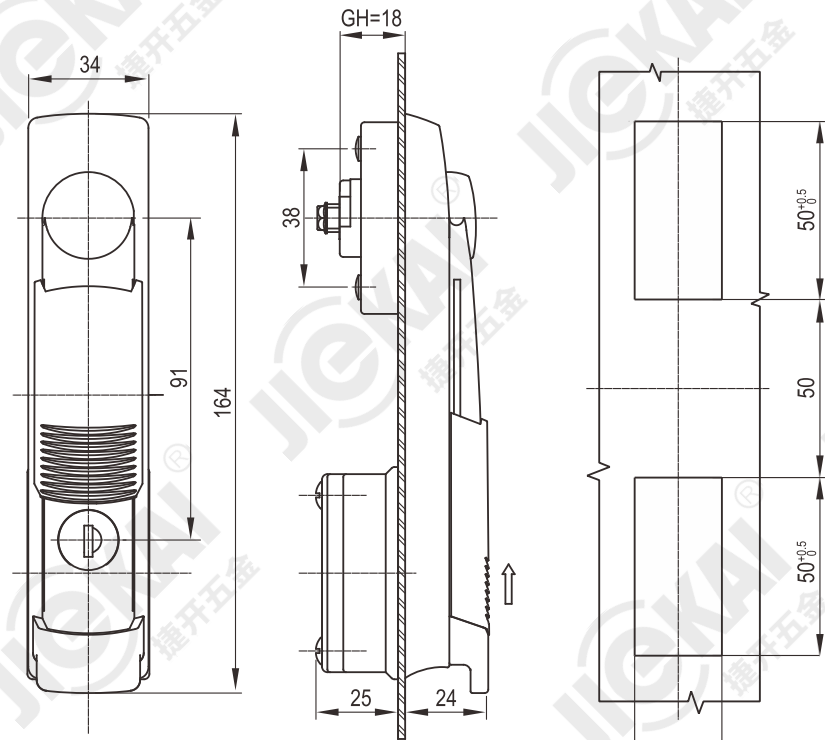

圆柱相同钥匙
Alike Round Cylinder

开孔尺寸
Recommended hole size

规格型号
Specifications
PM214-1K3-P2

PM215系列



产品说明
Description

- ◆ 镀锌钢钢栓、压板、黑色尼龙锁座、锌合金黑色锁柄
Galvanized steel locking tongue, clamp, black nylon base, zinc alloy black coated handle.

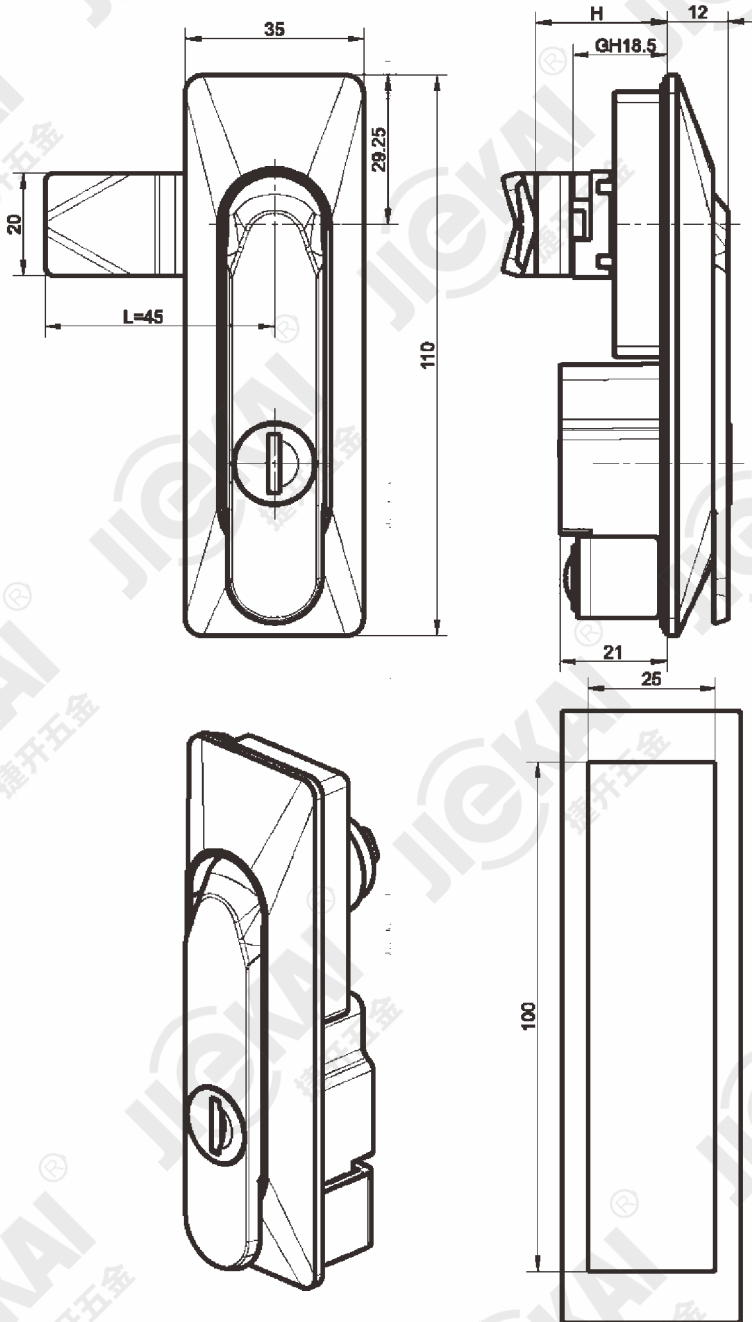

开孔尺寸
Recommended hole size

锌合金把手、塑料基座、带锁芯
Zinc handle, PA housing; with insert
PM215-7K1-XX

塑料基座、把手、无锁芯
PA handle and housing; no insert
PM215-7N1-XX

PM216系列

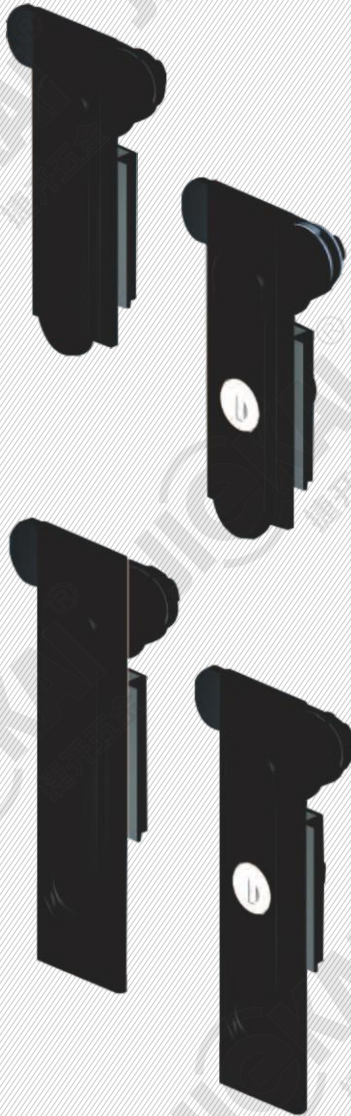

产品说明
Description

- ◆ 镀锌钢钢栓、压板、锌合金黑色喷涂锁座、锁柄
Galvanized steel locking tongue, clamp, zinc alloy black coated lock body, lock handle

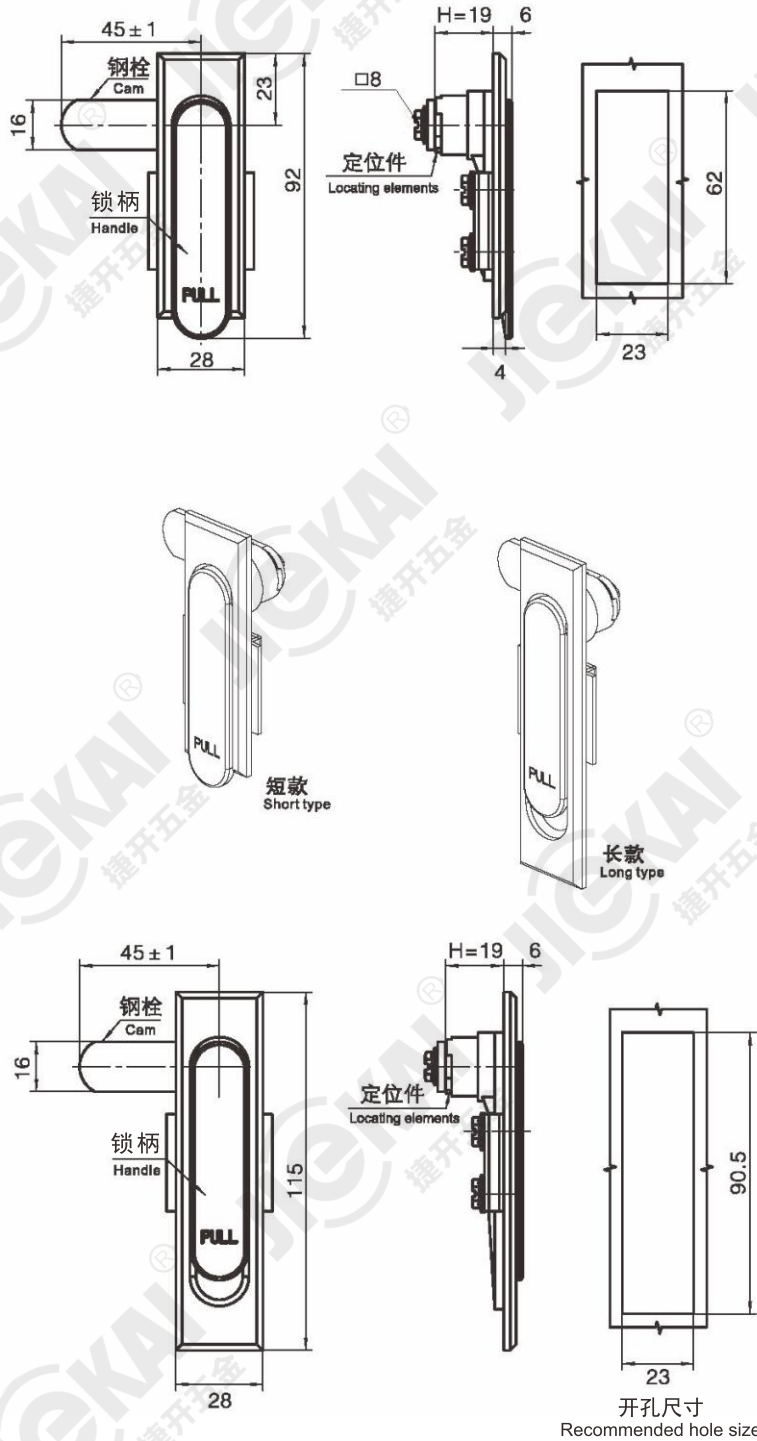

开孔尺寸
Recommended hole size

短款, 无锁芯
Short type, no insert
PM2161-1N1-P2

短款, 无带锁芯
Short type, with insert
PM2161-1K1-P2

长款, 无锁芯
Long type, no insert
PM2163-1N1-P2

长款, 无带锁芯
Long type, with insert
PM2163-1K1-P2

电源锁
Key switch lock

转舌锁
Cam lock

圆柱锁
Quarter turn lock

连杆锁
Rob control lock

平面锁
Plane lock

把手锁
Handle lock

面板锁
Panel lock

拉手
Handles

限位
Door stop

外装铰链
External hinge

内装铰链
Internal hinge

搭扣
Toggle lock

密封条
Gasket

配件
Accessories

PM217系列

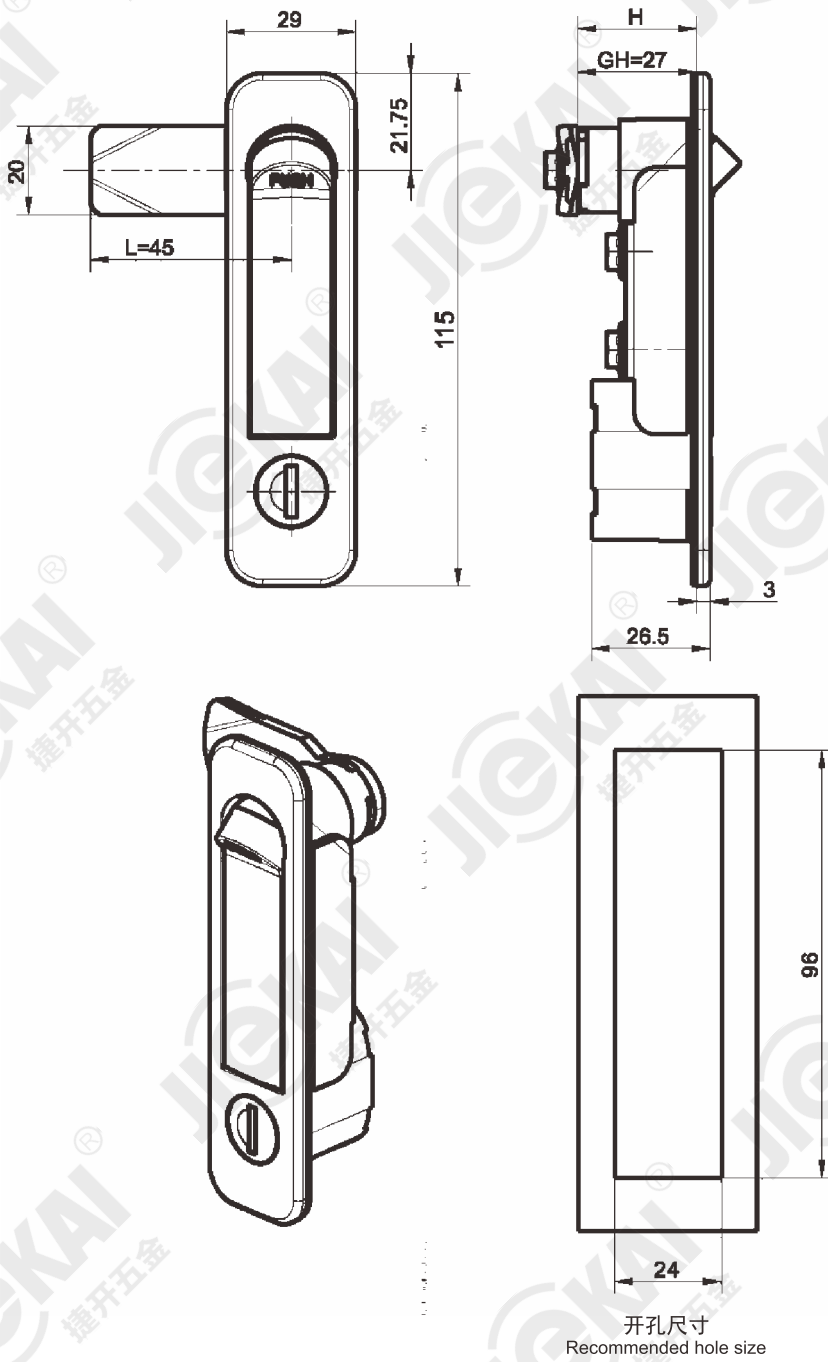

产品说明
Description

◆ 镀锌钢钢栓, 压板, 锌合金银灰喷漆锁座
Galvanized steel locking tongue, clamp, zinc alloy Silver grey paint lock body.

标准型 Standard	挂锁型 Padlock type
PM217-1K1-P6	PM217-1S1-P6

PM218系列

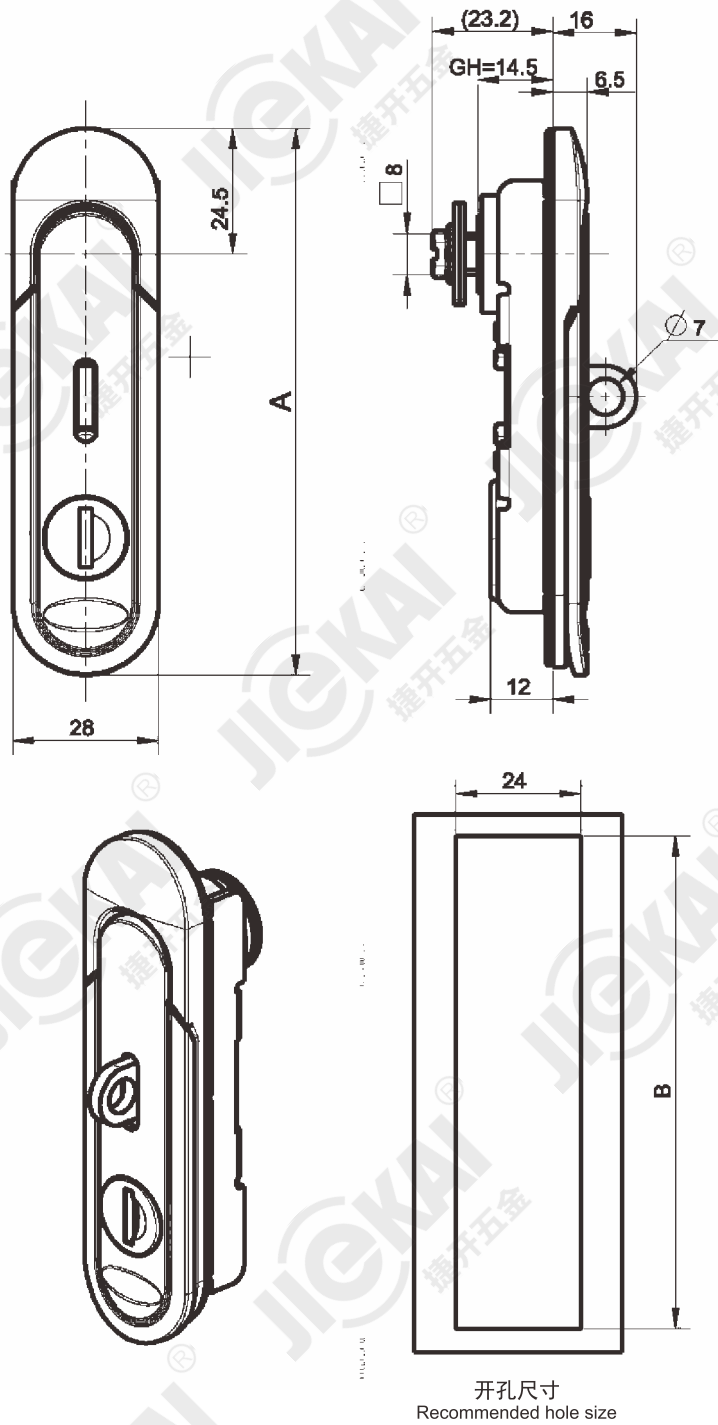

产品说明
Description

◆ 镀锌钢钢栓, 压板, 锌合金银灰喷漆锁座
Galvanized steel locking tongue, clamp, zinc alloy Silver grey paint lock body.

锁芯型号 Lock cylinder model	短款, A=89, B=63 Short type		中款, A=107, B=80 Middle type		长款, A=123, B=96 Long type	
	标准型 Standard	挂锁型 Padlock type	标准型 Standard	挂锁型 Padlock type	标准型 Standard	挂锁型 Padlock type
锌合金锁体无锁芯 Zinc body without insert	PM2181-1N1-P6	PM2181-1J1-P6	PM2182-1N1-P6	PM2182-1J1-P6	PM2183-1N1-P6	PM2183-1J1-P6
锌合金锁体带锁芯 Zinc body with insert	PM2181-1K1-P6		PM2182-1K1-P6	PM2182-1S1-P6	PM2183-1K1-P6	PM2183-1S1-P6

PM219系列

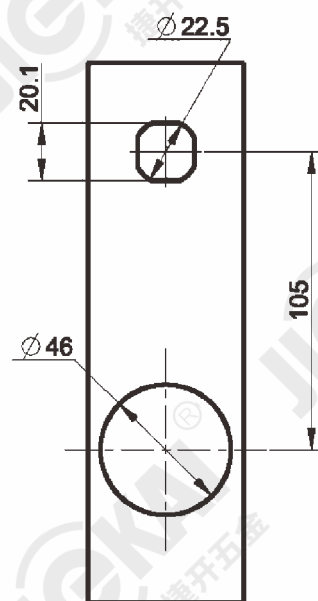
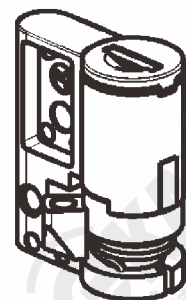
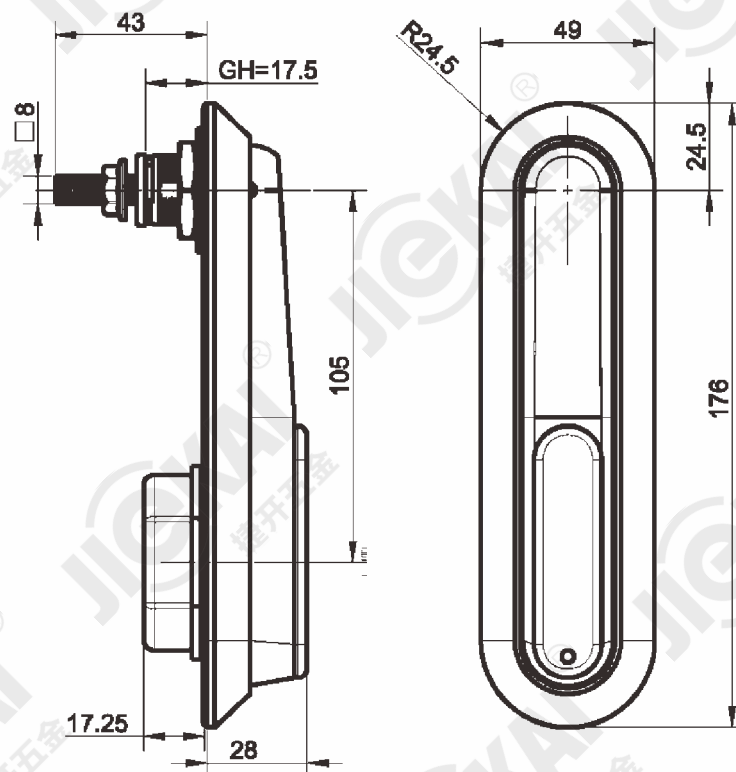
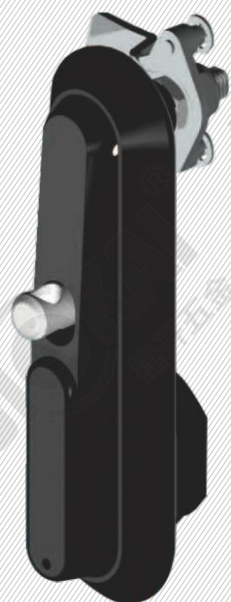

锁头可选配
Lock head type is optional

开孔尺寸
Recommended hole size

产品说明

- ◆ 镀锌钢锁舌, 锌合金光黑喷涂锁座, 黑色尼龙压板
Galvanized steel locking tongue, zinc alloy black coated lock body, black nylon press plate.

标准型 Standard	挂锁型 Padlock type
PM219-1K3-P2	PM219-1S3-P2

www.gzlocks.com

PM220

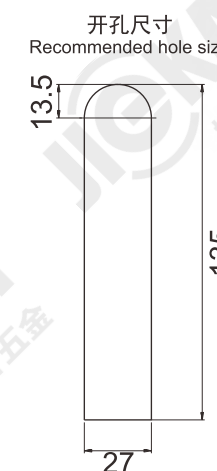
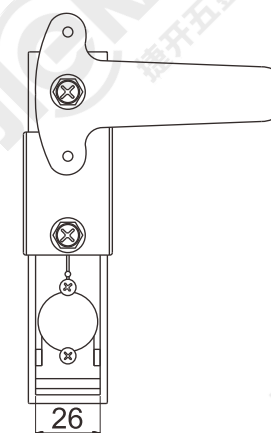
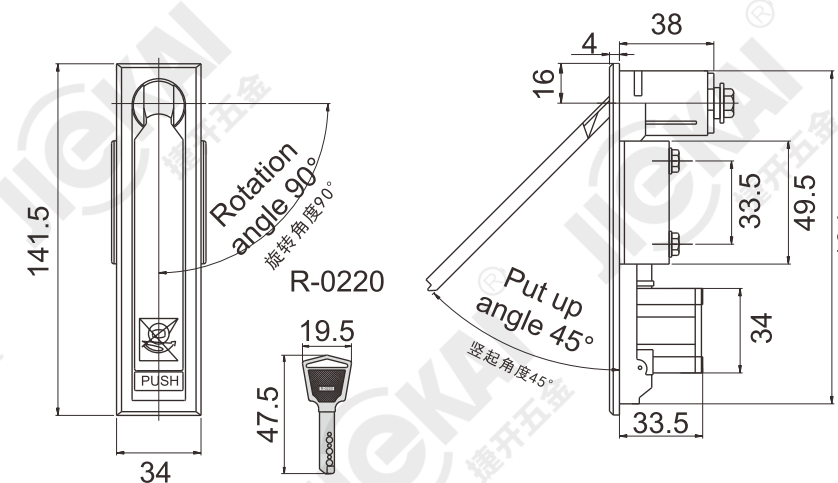

开孔尺寸
Recommended hole size

产品说明

- ◆ 锌合金锁座、锁柄，镀铬-光面，电著涂装黑色
Zinc alloy lock body, lock handle, chrome plating-silver, electro-deposit coating black.

规格型号 Specifications	
PM220-1S3-E1	PM220-1S3-P1

www.gzlocks.com

PM221系列

PM222系列

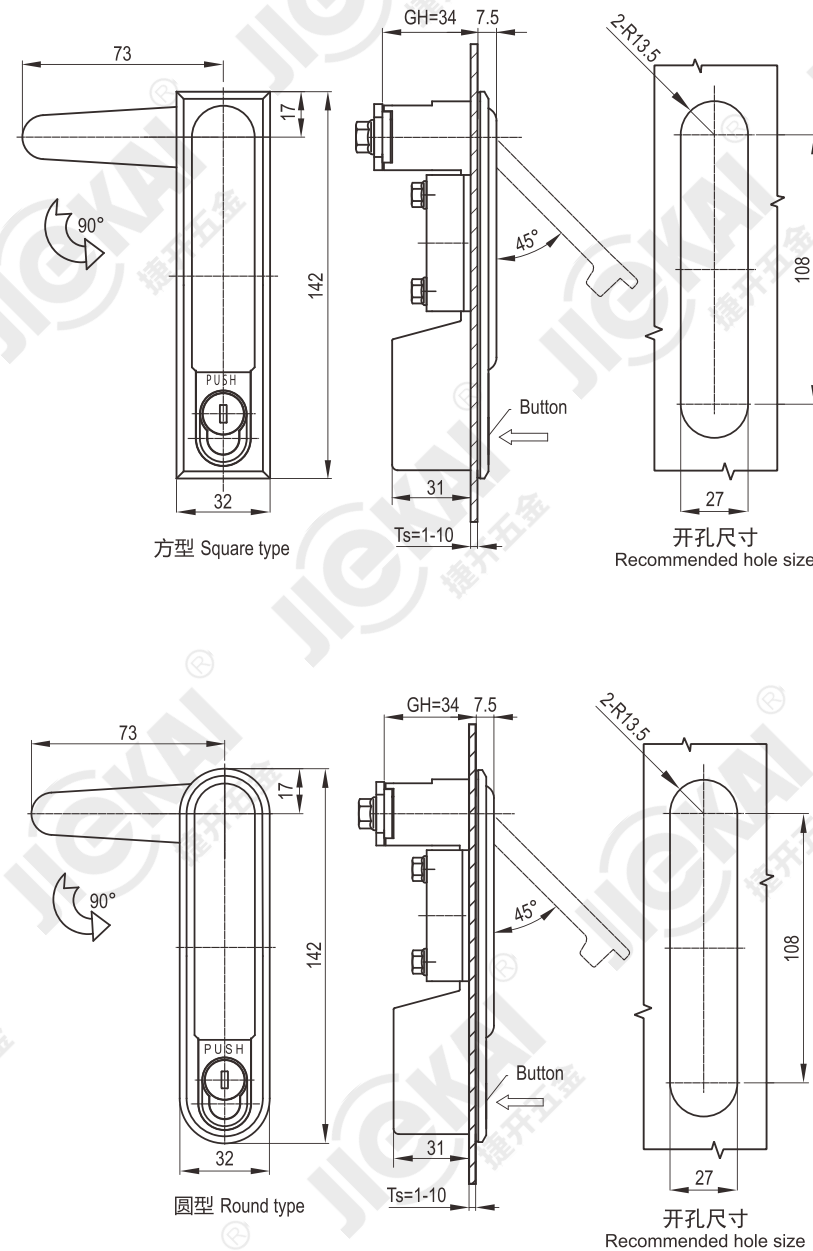
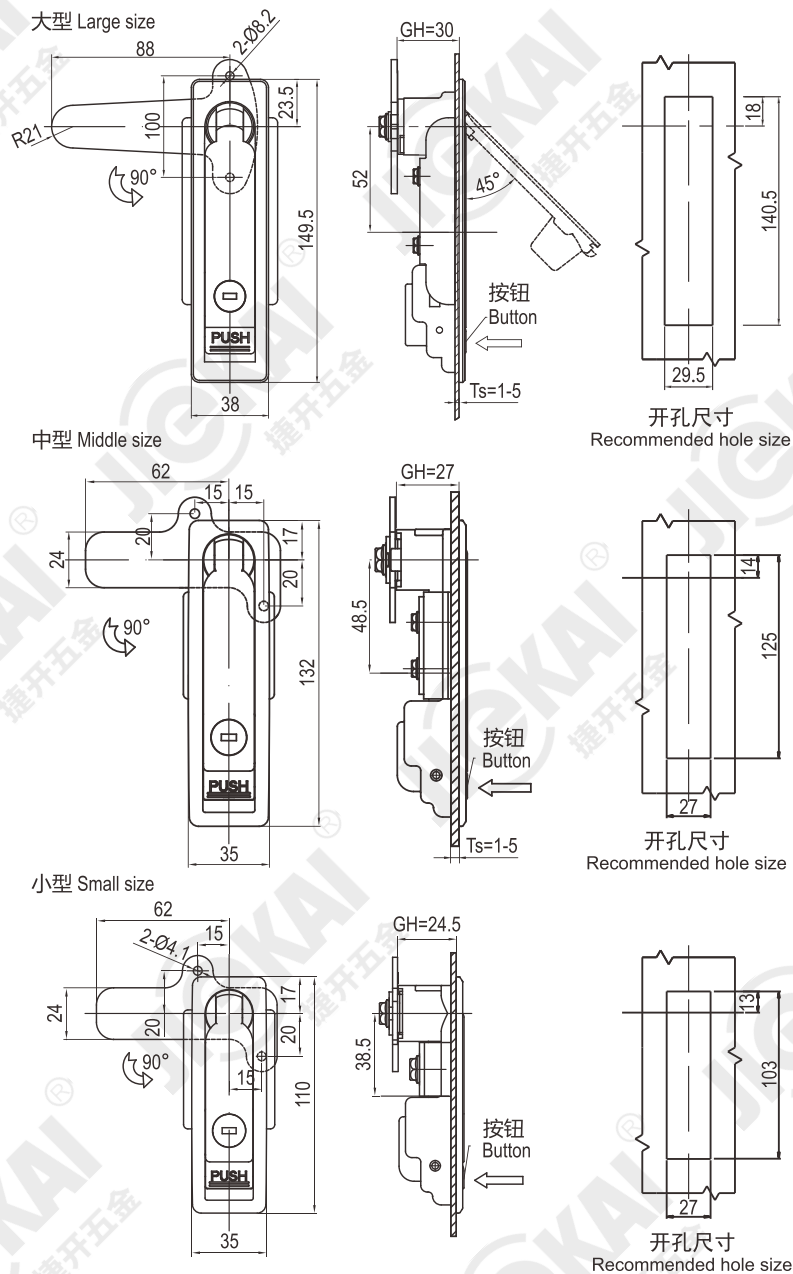

产品说明
Description

◆ 镀锌钢栓, 压板, 锌合金锁座、锁柄, 按钮, 锁芯
Zinc die casting handle, housing, button and cylinder; m.s. zinc plated cam and fixing parts.

	沙铬 Satin chrome	喷塑黑 Black powder coated
大型 Large size	PM2213-1K1-E5	PM2213-1K1-P2
中型 Middle size	PM2212-1K1-E5	PM2212-1K1-P2
小型 Small size	PM2211-1K1-E5	PM2211-1K1-P2

产品说明
Description

◆ 黑色锌合金锁座、锁柄, 镀锌钢栓, 镀铬
锌合金锁头
Zinc alloy lock body, lock handle; zinc plated bolt; zinc alloy lock, chrome plated

	沙铬 Satin chrome	喷塑黑 Black powder coated
方型 Square type	PM222S-1K1-E5	PM222S-1K1-P1
圆型 Round type	PM222R-1K1-E5	PM222R-1K1-P1

PM223

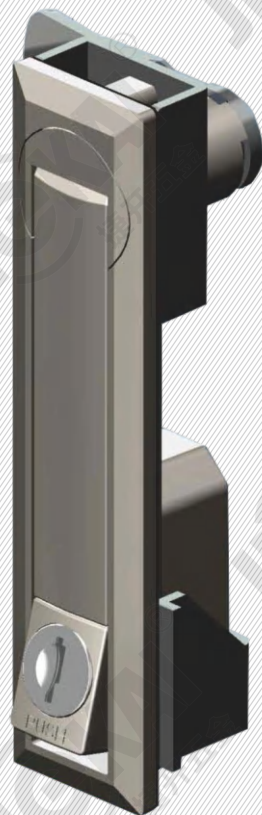

产品说明
Description

◆ 镀锌钢钢栓, 压板, 锌合金银灰喷漆锁座
Galvanized steel locking tongue, clamp, zinc alloy Silver grey paint lock body.

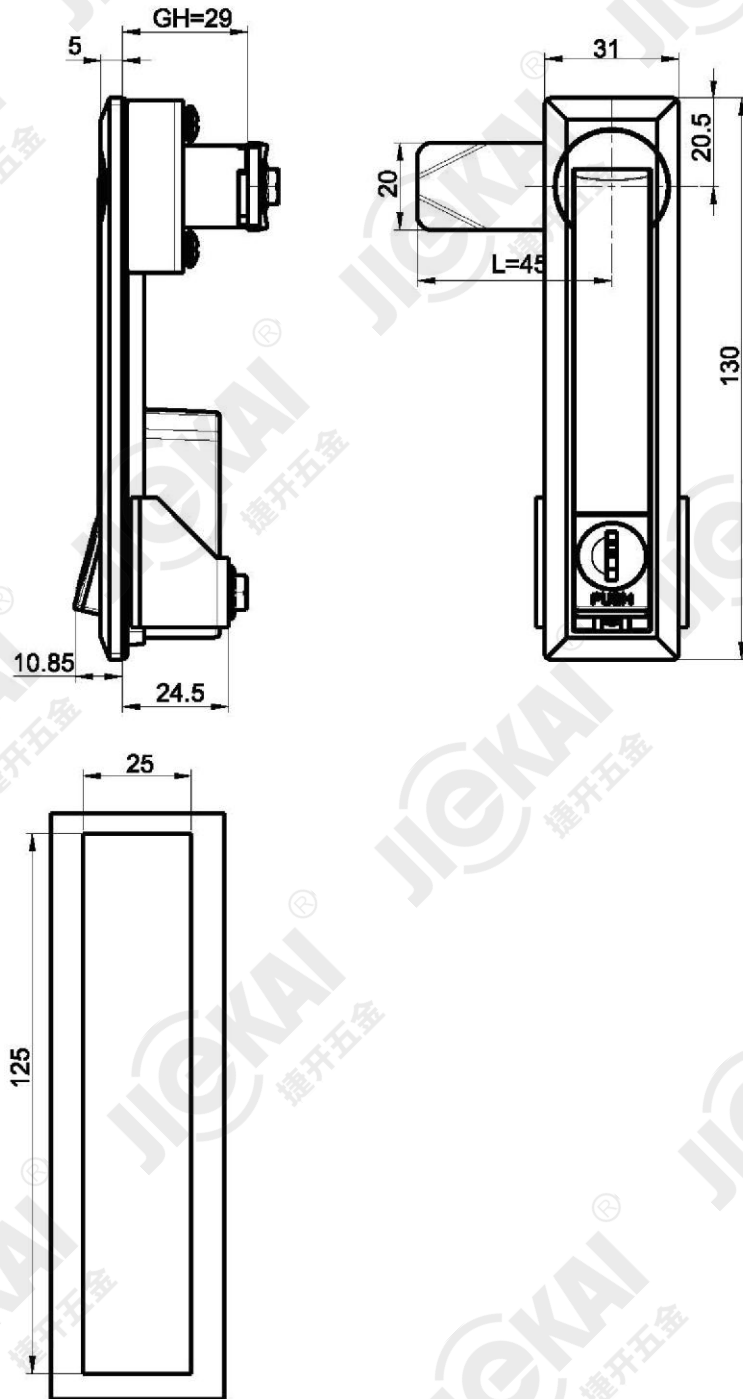

开孔尺寸
Recommended hole size

标准型 Standard	挂锁型 Padlock type
PM223-1K1-P6	PM223-1S1-P6

PM224系列



产品说明
Description

◆ 镀锌钢钢栓, 压板, 锌合金黑色锁座
Galvanized steel locking tongue, clamp, zinc alloy black coated lock body.

PM225



产品说明
Description

◆ 镀锌钢钢栓, 压板, 锌合金黑色锁座
Galvanized steel locking tongue, clamp, zinc alloy black coated lock body.

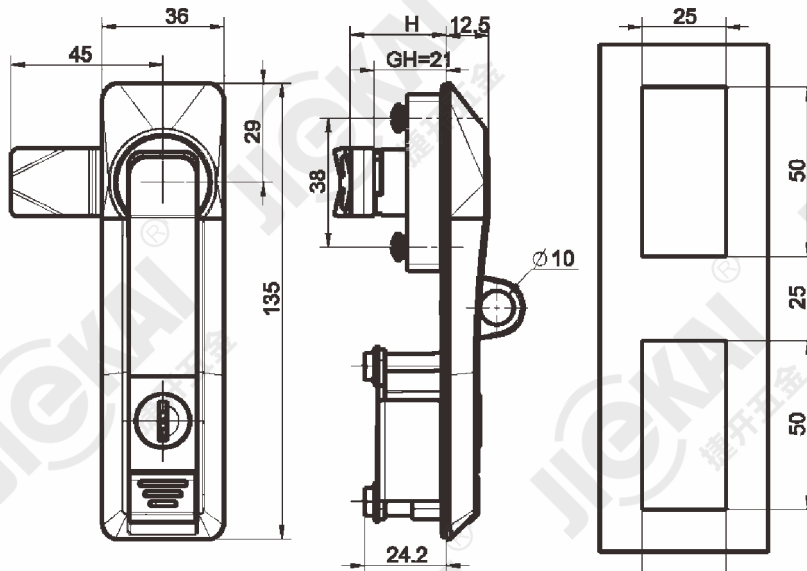

开孔尺寸
Recommended hole size

标准型 Standard	挂锁型 Padlock type
PM224-1K3-P2	PM224-1S3-P2

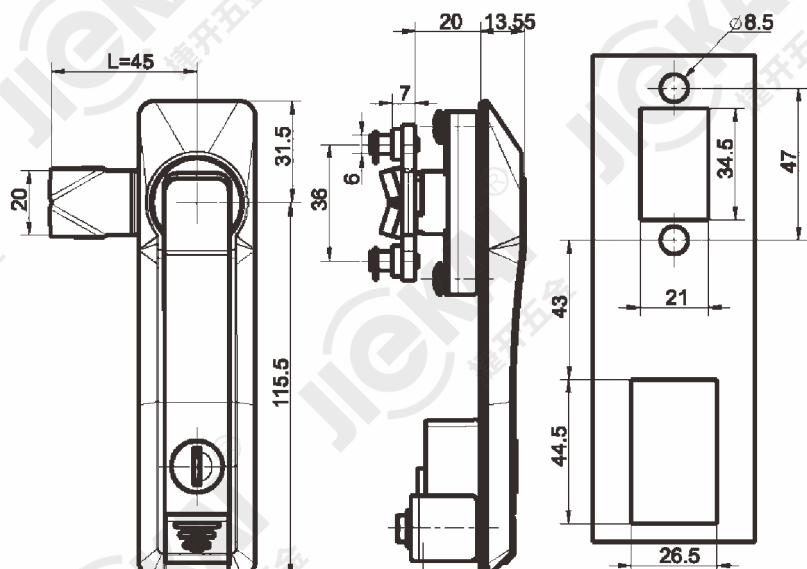

开孔尺寸
Recommended hole size

标准型 Standard	挂锁型 Padlock type
PM225-1K3-P2	PM225-1S3-P2

PM226



产品说明
Description

◆ 镀锌钢钢栓, 压板, 锌合金银灰喷漆锁座
Galvanized steel locking tongue, clamp, zinc alloy Silver grey paint lock body.

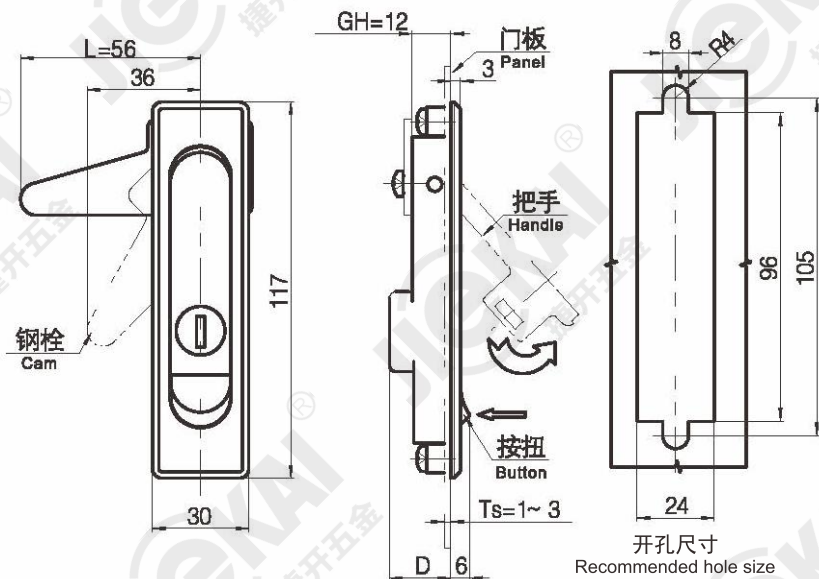

规格型号
Specifications
PM226-1S1-P6

PM227



产品说明
Description

◆ 镀锌钢钢栓, 压板, 锌合金黑色锁座
Galvanized steel locking tongue, clamp, zinc alloy black coated lock body.

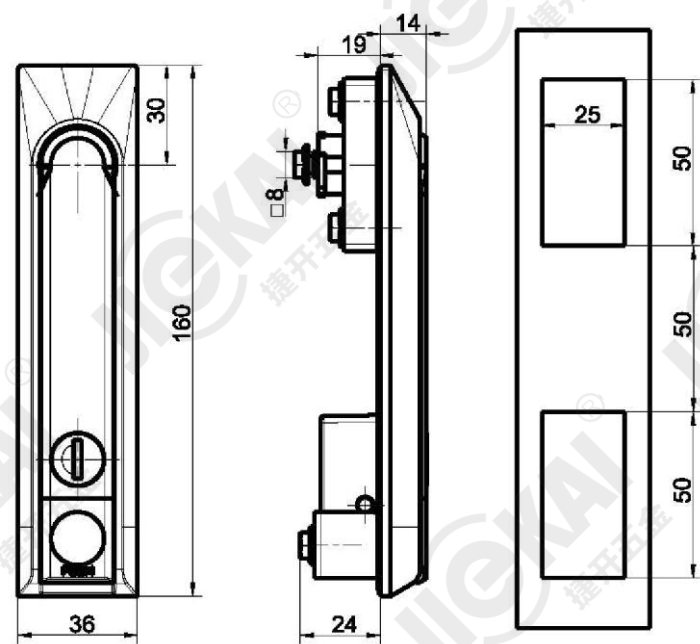

标准型
Standard
PM227-1K1-P2

挂锁型
Padlock type
PM227-1S1-P2

PM230系列



产品说明
Description

◆ 镀锌钢锁舌, 锌合金光黑喷漆锁座, 黑色尼龙压板
Galvanized steel locking tongue, zinc alloy black coated lock body, black nylon press plate.

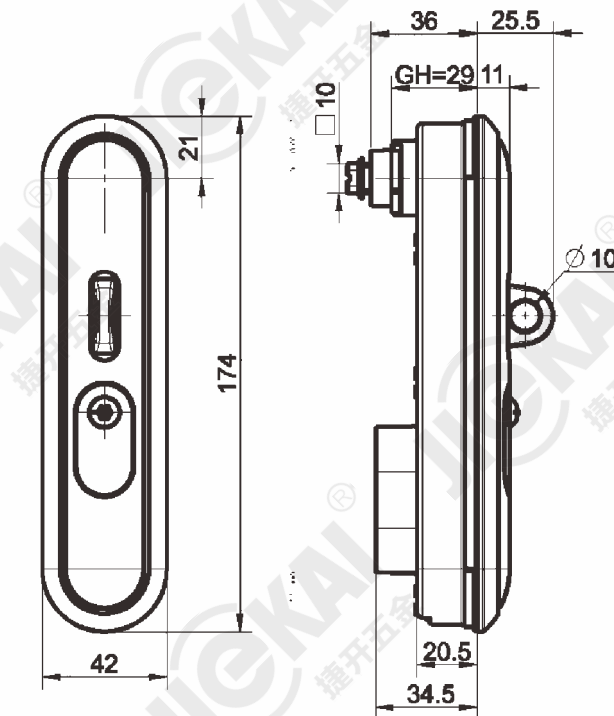

十字弹子锁头
Cross bullet lock

一字弹子锁头
Bullet lock

开孔尺寸
Recommended hole size

GH=29 标准型 Standard	GH=29 挂锁型 Padlock type	GH=26.5 标准型 Standard	GH=26.5 挂锁型 Padlock type
PM2302-1K3-P1	PM2302-1S3-P1	PM2301-1K3-P1	PM2301-1S3-P1

PM231

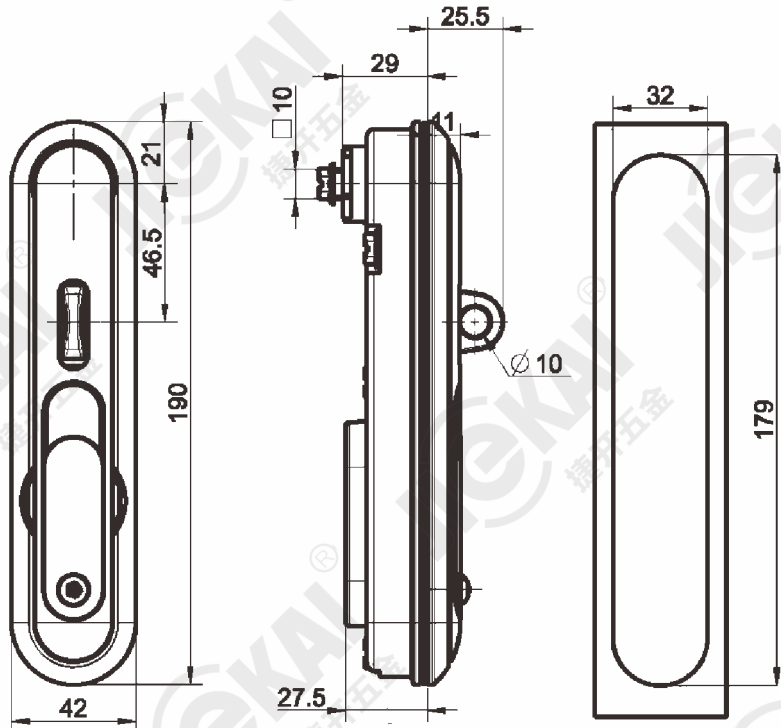
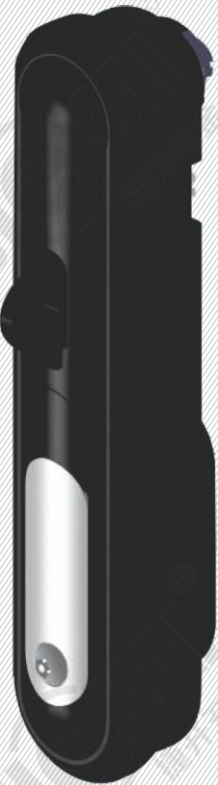

开孔尺寸
Recommended hole size

产品说明
Description

- 镀锌钢锁舌, 锌合金光黑喷涂锁座, 黑色尼龙压板
Galvanized steel locking tongue, zinc alloy black coated lock body, black nylon press plate.

标准型 Standard	挂锁型 Padlock type
PM231-1K3-P1	PM231-1S3-P1

PM232

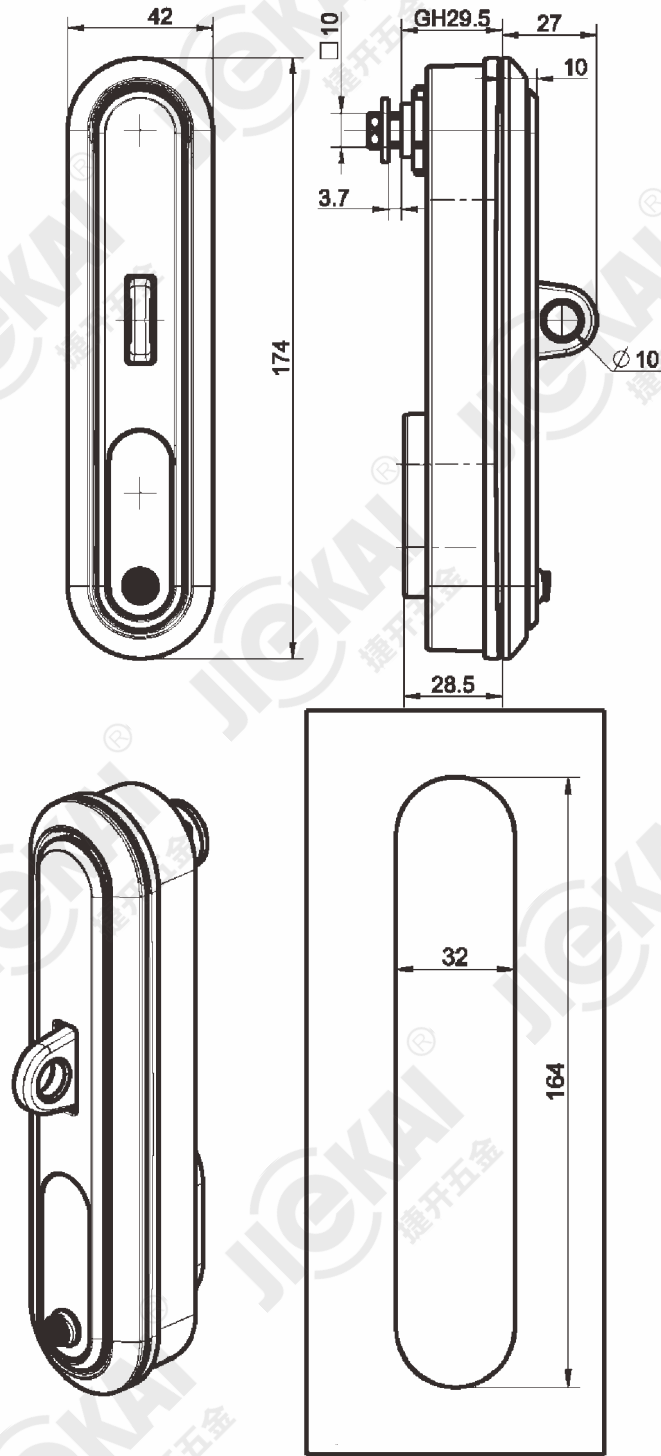

开孔尺寸
Recommended hole size

产品说明
Description

- 镀锌钢锁舌, 锌合金光黑喷涂锁座, 黑色尼龙压板
Galvanized steel locking tongue, zinc alloy black coated lock body, black nylon press plate.

标准型 Standard	挂锁型 Padlock type
PM232-1K3-P1	PM232-1S3-P1

电源锁
Key switch lock

转舌锁
Cam lock

圆柱锁
Quarter turn lock

连杆锁
Rob control lock

平面锁
Plane lock

把手锁
Handle lock

面板锁
Panel lock

拉手
Handles

限位
Door stop

外装铰链
External hinge

内装铰链
Internal hinge

搭扣
Toggle lock

密封条
Gasket

配件
Accessories

PM233系列

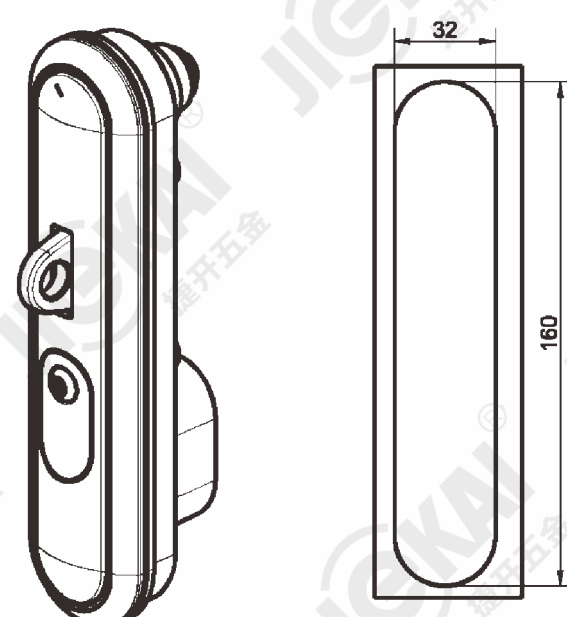
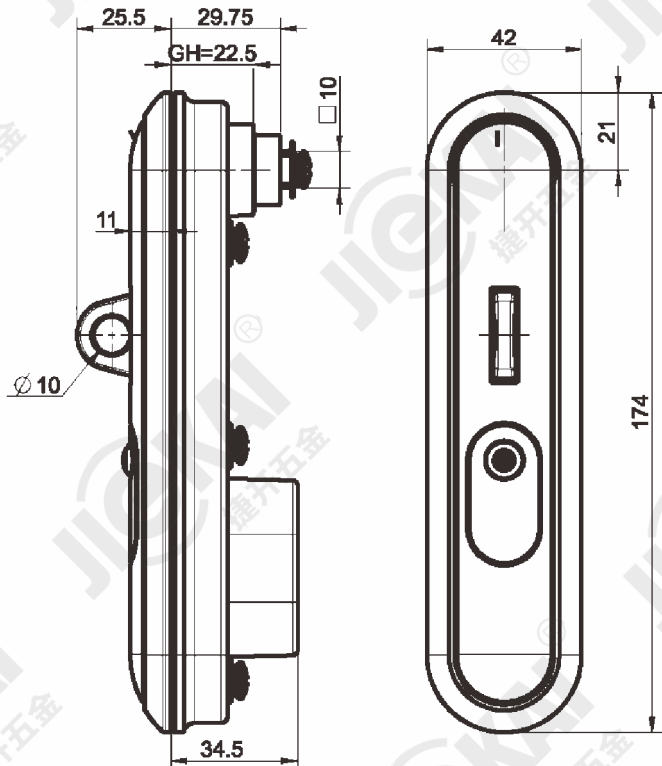

开孔尺寸
Recommended hole size

产品说明
Description

◆ 镀锌钢锁舌, 锌合金光黑喷涂锁座, 黑色尼龙压板
Galvanized steel locking tongue, zinc alloy black coated lock body, black nylon press plate.

标准型 Standard	挂锁型 Padlock type
PM233-1K3-P1	PM233-1S3-P1

PM240

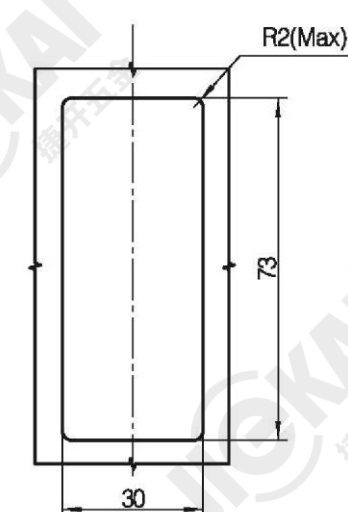
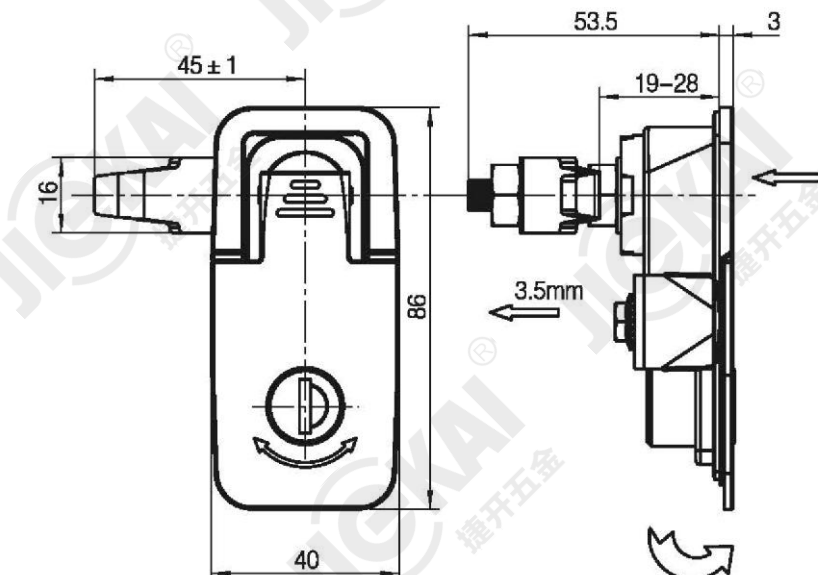

安装孔
Mounting hole

产品说明
Description

◆ 镀锌钢钢柱, 压板, 锌合金黑色喷涂锁座
Galvanized steel locking tongue, clamp, zinc alloy black coated lock body.

带锁芯 With insert	无锁芯 Without insert
PM240-1K2-P1	PM240-1N2-P1

PM241



产品说明
Description

- ◆ 锌合金锁座、锁柄，镀锌钢柱
Zinc die handle and housing black powder coated or bright chrome; m.s. zinc plated cam and shaft

小型 Small size

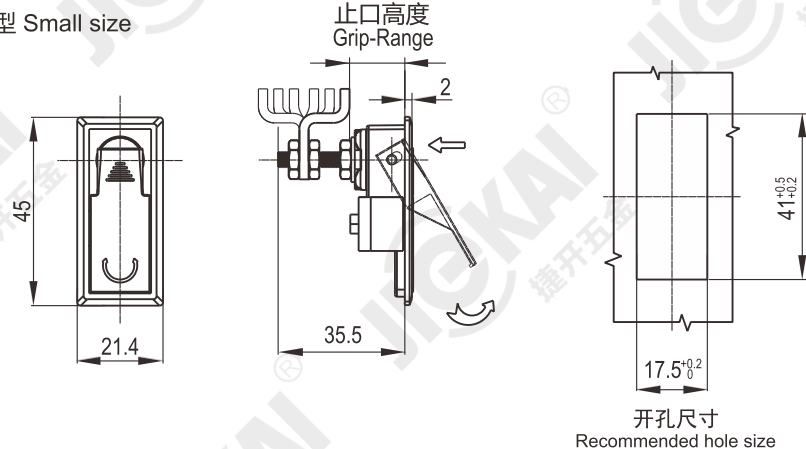

止口高度 Grip-Range		锁芯类型 Cylinder style	喷塑黑 Black powder coated	亮铬 Bright chrome
正 Pawl forward MIN-MAX	反 Pawl reversed MIN-MAX			
4.5-10.5	34.5-40.5	不带锁芯 Non-locking	PM2411-1N1-P1	PM2411-1N1-E5
10.5-16.5	28.5-34.5		PM2412-1N1-P1	PM2412-1N1-E5
16.5-22.5	22.5-28.5		PM2413-1N1-P1	PM2413-1N1-E5

PM244



产品说明
Description

- ◆ 黑色锌合金锁座、锁柄，按钮，镀锌钢
Zinc die handle, housing and trigger black powder coated or bright chrome; m.s. zinc plated screw and fixing parts.

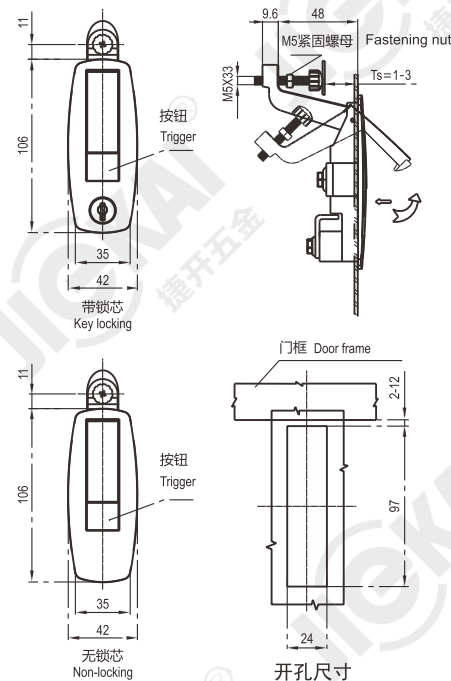

带锁芯 With insert PM244-1K2-P1	无锁芯 Without insert PM244-1N2-P1
------------------------------------	---------------------------------------

PM242系列



产品说明
Description

- ◆ 黑色锌合金锁座、锁柄，按钮，镀锌钢
Zinc die handle, housing and trigger black powder coated or bright chrome; m.s. zinc plated screw and fixing parts.

Zinc die handle, housing and trigger black powder coated or bright chrome; m.s. zinc plated screw and fixing parts.

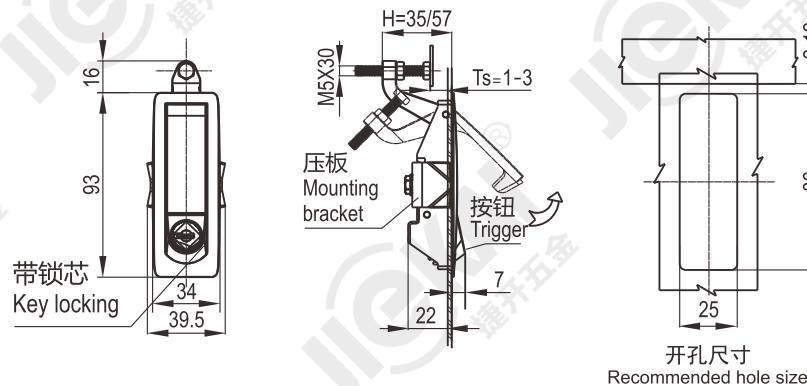
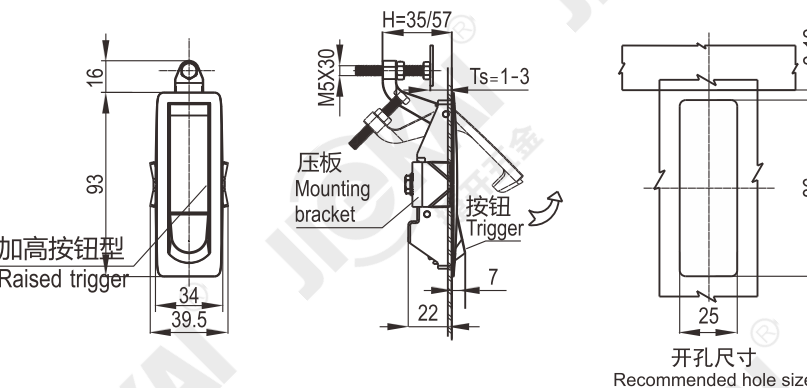
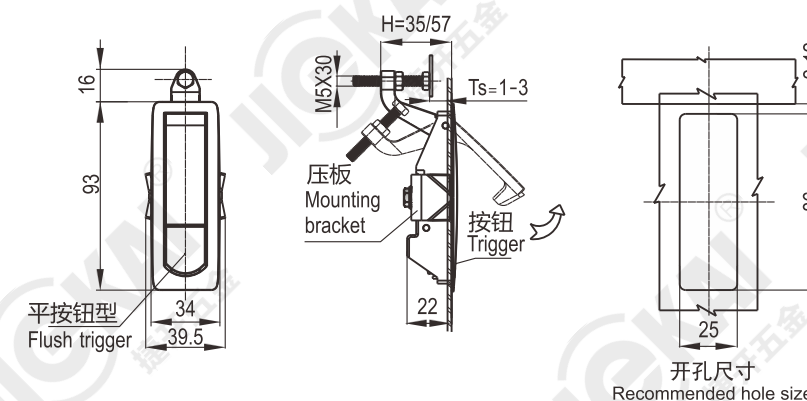

止口高度 Grip-Range	1-24		23-46	
	短杠杆 Short Arm		长杠杆 Longer Arm	
按钮款式 Trigger style	喷塑黑 Black powder coated	亮铬 Bright chrome	喷塑黑 Black powder coated	亮铬 Bright chrome
无钥匙升高型 Non-locking raised trigger	PM2421-1N2-P1-001	PM2421-1N2-E1-001	PM2422-1N2-P1-001	PM2422-1N2-E1-001
无钥匙齐平型 Non-locking flush trigger	PM2421-1N2-P1-002	PM2421-1N2-E1-002	PM2422-1N2-P1-002	PM2422-1N2-E1-002
带锁芯 (Ch751) Key locking	PM2421-1K2-P1	PM2421-1K2-E1	PM2422-1K2-P1	PM2422-1K2-E1

PM245系列

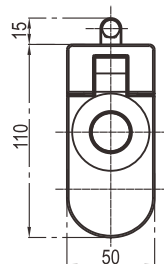

无锁芯型
Non -Locking

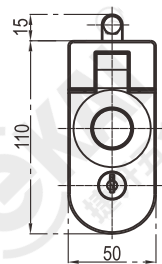

锁芯型
Key Locking

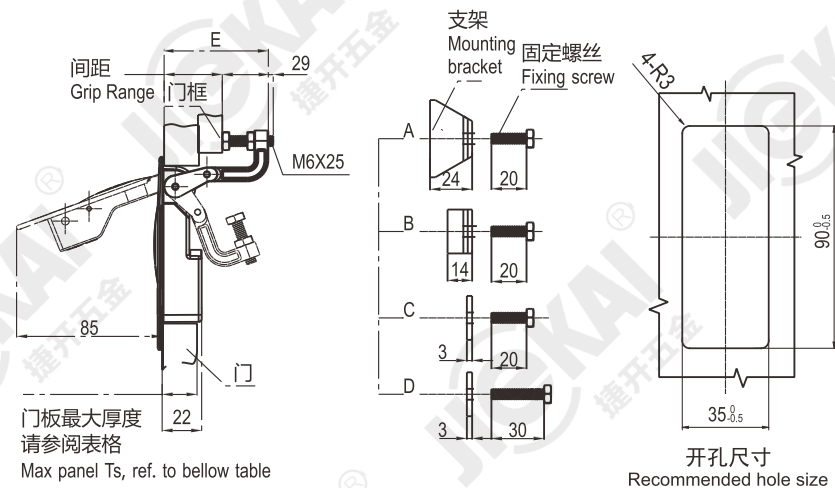

门板最大厚度
请参阅表格
Max panel Ts, ref. to bellow table

开孔尺寸
Recommended hole size

固定安装块 Mounting bracket	门板厚度 Panel thickness		间距 Grip range		E	不带钥匙锁 Non-locking	带CH751钥匙锁 Ch751 Key locking
	最小MIN	最大MAX	最小MIN	最大MAX			
A	1	11	1	14	29	PM245A-1N2-P2-14	PM245A-1K2-P2-14
B	11	21				PM245B-1N2-P2-14	PM245B-1K2-P2-14
A	1	11				PM245A-1N2-P2-29	PM245A-1K2-P2-29
B	11	21				PM245B-1N2-P2-29	PM245B-1K2-P2-29
C	21	31	14	29	44	PM245C-1N2-P2-29	PM245C-1K2-P2-29
A	1	11				PM245A-1N2-P2-45	PM245A-1K2-P2-45
B	11	21				PM245B-1N2-P2-45	PM245B-1K2-P2-45
C	21	31				PM245C-1N2-P2-45	PM245C-1K2-P2-45
D	31	41	29	45	60	PM245D-1N2-P2-45	PM245D-1K2-P2-45
A	1	11				PM245A-1N2-P2-57	PM245A-1K2-P2-57
B	11	21				PM245B-1N2-P2-57	PM245B-1K2-P2-57
C	21	31				PM245C-1N2-P2-57	PM245C-1K2-P2-57
D	31	41	45	57	72	PM245D-1N2-P2-57	PM245D-1K2-P2-57

产品说明
Description

- 黑色锌合金锁座、锁柄, 按钮, 镀锌钢安装件

Zinc die handle, housing and trigger black powder coated or bright chrome; m.s. zinc plated screw and fixing parts.

PM246系列



产品说明
Description

- 黑色锌合金锁座、锁柄, 按钮, 镀锌钢安装件

Zinc die handle, housing and trigger black powder coated or bright chrome; m.s. zinc plated screw and fixing parts.

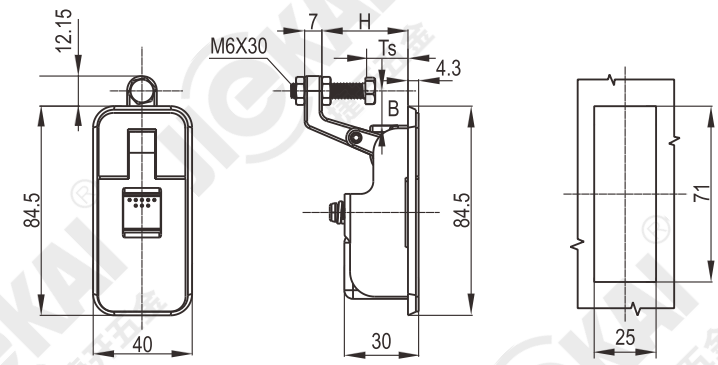

开孔尺寸
Recommended hole size

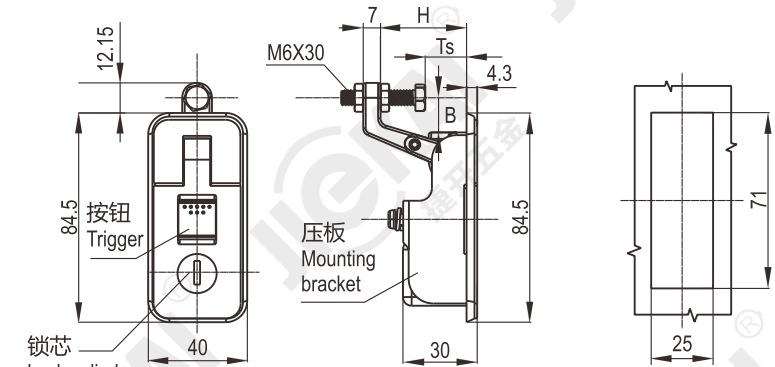

开孔尺寸
Recommended hole size

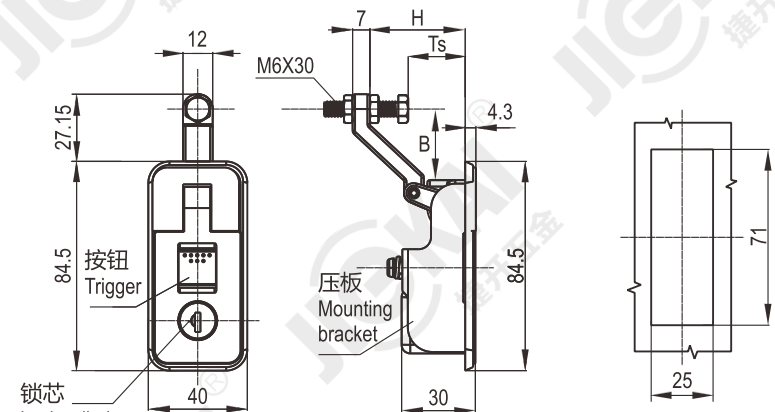

开孔尺寸
Recommended hole size

门板厚度 Panel thickness	间距 Grip range	H	B	喷塑黑 Black powder coated		镀铬 Satin chrome	
				不带锁芯型 Non-locking	Ch751 locking with shutter	不带锁芯型 Non-locking	Ch751 locking with shutter
1 to 11mm	1-25mm	36.5	13.5	PM246A-1N2-P2	PM246A-1K2-P2	PM246A-1N2-E5	PM246A-1K2-E5
1 to 11mm	15-30mm	40	28.5	PM246B-1N2-P2	PM246B-1K2-P2	PM246B-1N2-E5	PM246B-1K2-E5

PM247系列

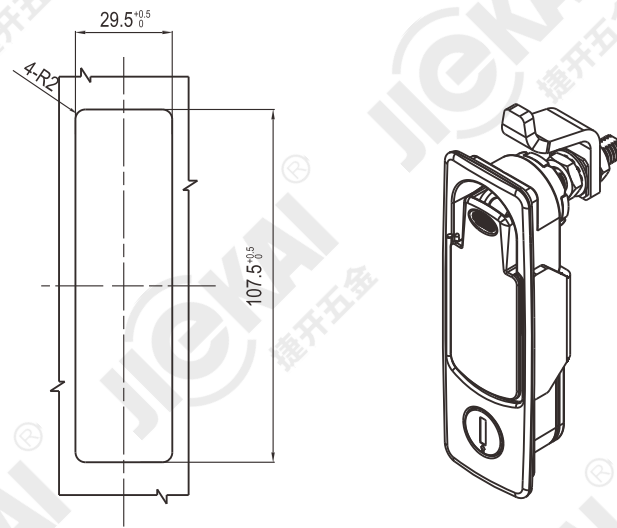
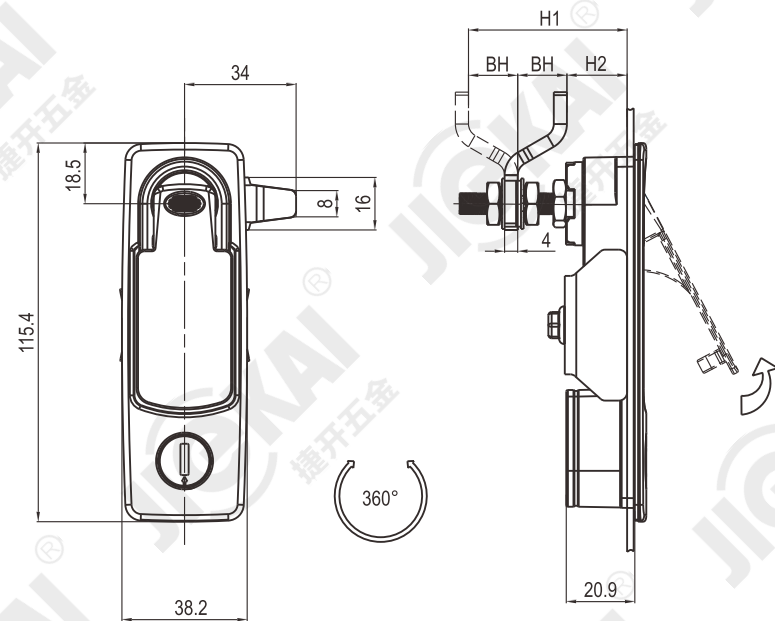

开孔尺寸
Recommended hole size

产品说明

- ◆ 锌合金锁座、锁柄, 镀锌钢栓
Zinc die handle and housing black powder coated or bright chrome; m.s. zinc plated cam and shaft

止口高度 Grip-Range		带锁芯 With insert	
正 Pawl forward	反 Pawl reversed	喷塑黑 Black powder coated	亮铬 Bright chrome
6-16	56-66	PM247A-1K2-P2	PM247A-1K2-E1
16-26	46-56	PM247B-1K2-P2	PM247B-1K2-E1
26-36	36-46	PM247C-1K2-P2	PM247C-1K2-E1

PM250



产品说明 Description

- ◆ 锌合金锁座、锁柄，碳钢钢栓
- ◆ 纳米亚光锁座、锁柄，镀白锌钢栓

Zinc alloy base, handle, carbon steel bolt. Nano
matte base, handle, white zinc plated steel bolt.

PM251



产品说明

- ◆ 锌合金锁座、锁柄，碳钢钢栓
- ◆ 纳米亚光锁座、锁柄，镀白锌钢栓

Zinc alloy base, handle, carbon steel bolt. Nano
matte base, handle, white zinc plated steel bolt.

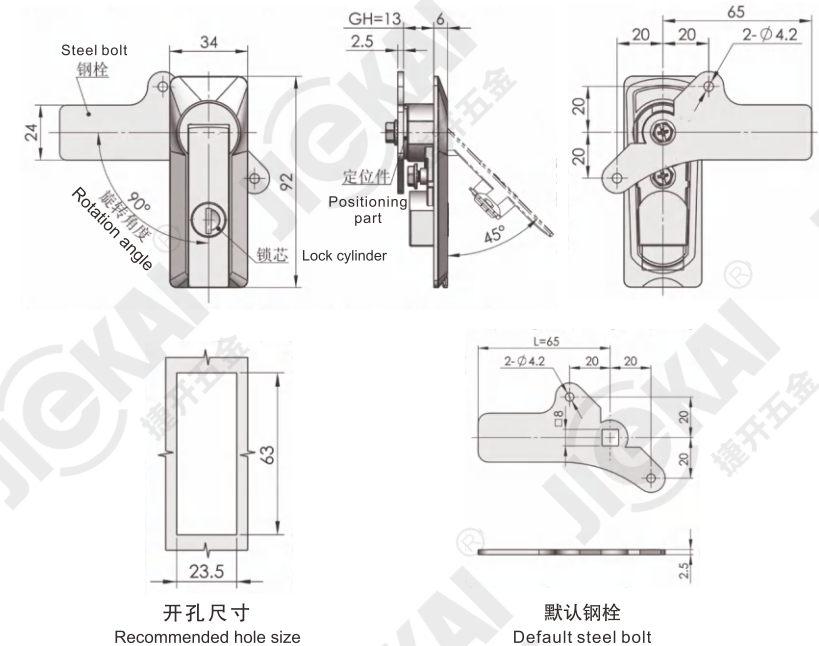

开孔尺寸
Recommended hole size

默认钢栓
Default steel bolt

规格型号
Specifications
PM250-1K1-PO

PM250-1K1-PO



注：改变定位件与钢栓安装位置可调节止口高度，改变定位件放置方向可实现左右开门
Note: the height of the seam can be adjusted by changing the installation position of the positioning piece and the steel bolt, and the left and right door opening can be realized by changing the placement direction of the positioning piece

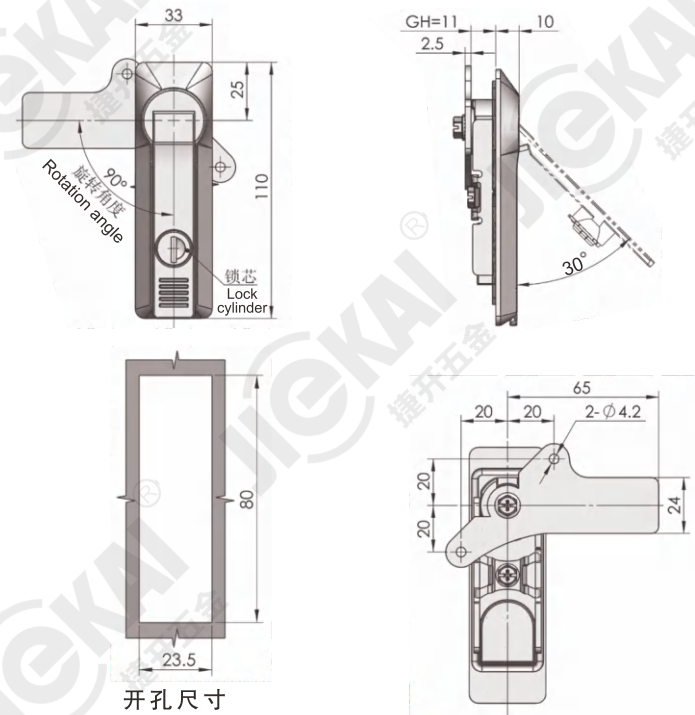

开孔尺寸
Recommended hole size

规格型号 Specifications

PM251-1N1-PO

PM251-1K1-PO

电源锁
Key switch lock

转舌锁
Cam lock

圆柱锁
Quarter turn lock

连杆锁
Rob control lock

平面锁
Plane lock

把手锁
Handle lock

面板锁
Panel lock

拉手
Handles

限位
Door stop

外装铰链
External hinge

内装铰链
Internal hinge

搭扣
Toggle lock

密封条
Gasket

配件
Accessories

PM252系列



产品说明
Description

◆ 锌合金锁座，碳钢锁片与安装板，镀沙铬
Zinc die-casting body, steel cam and assembling plate. Finish: Gray chrome plating

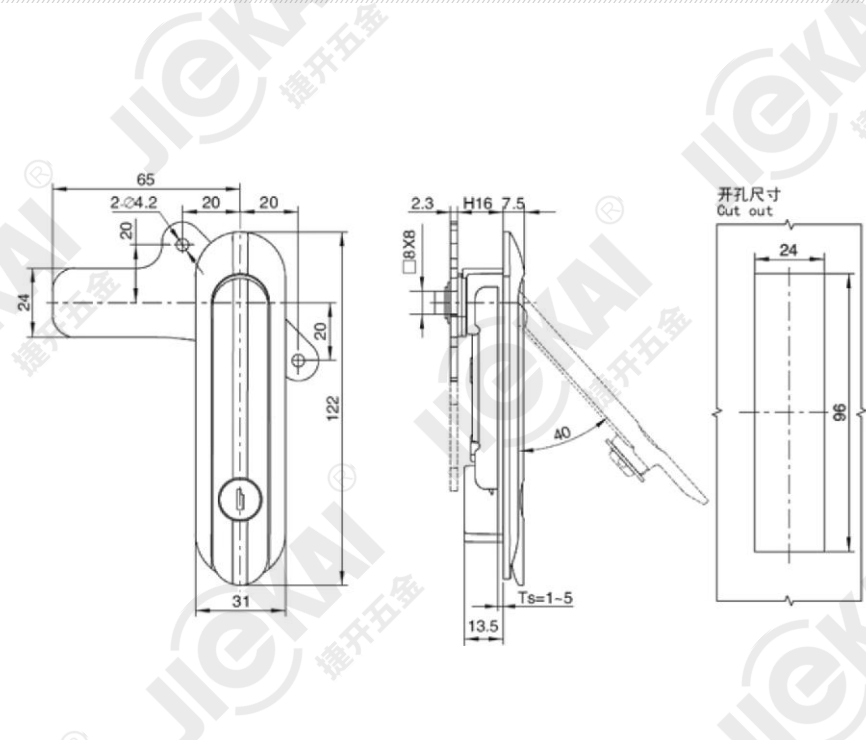

规格型号
Specifications
PM252-1K1-E5

PM253系列



产品说明
Description

◆ 锌合金锁座，碳钢锁片与安装板，镀沙铬
Zinc die-casting body, steel cam and assembling plate. Finish: Gray chrome plating

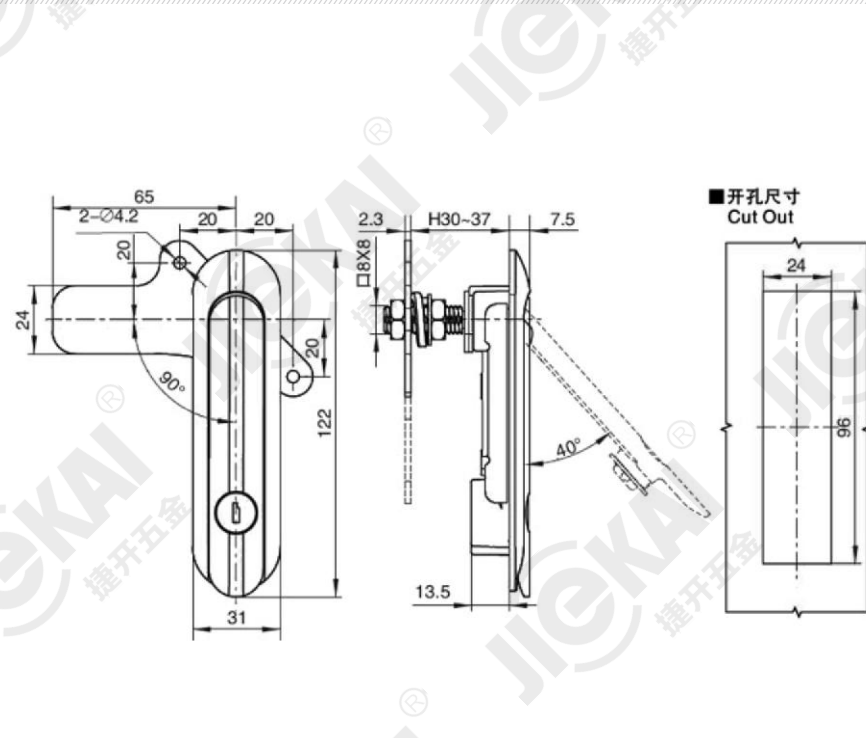

规格型号
Specifications
PM253-1K2-E5

SC256



产品说明
Description

◆ 全不锈钢或塑料锁座、拉柄
Stainless steel 304 or lock body, handle

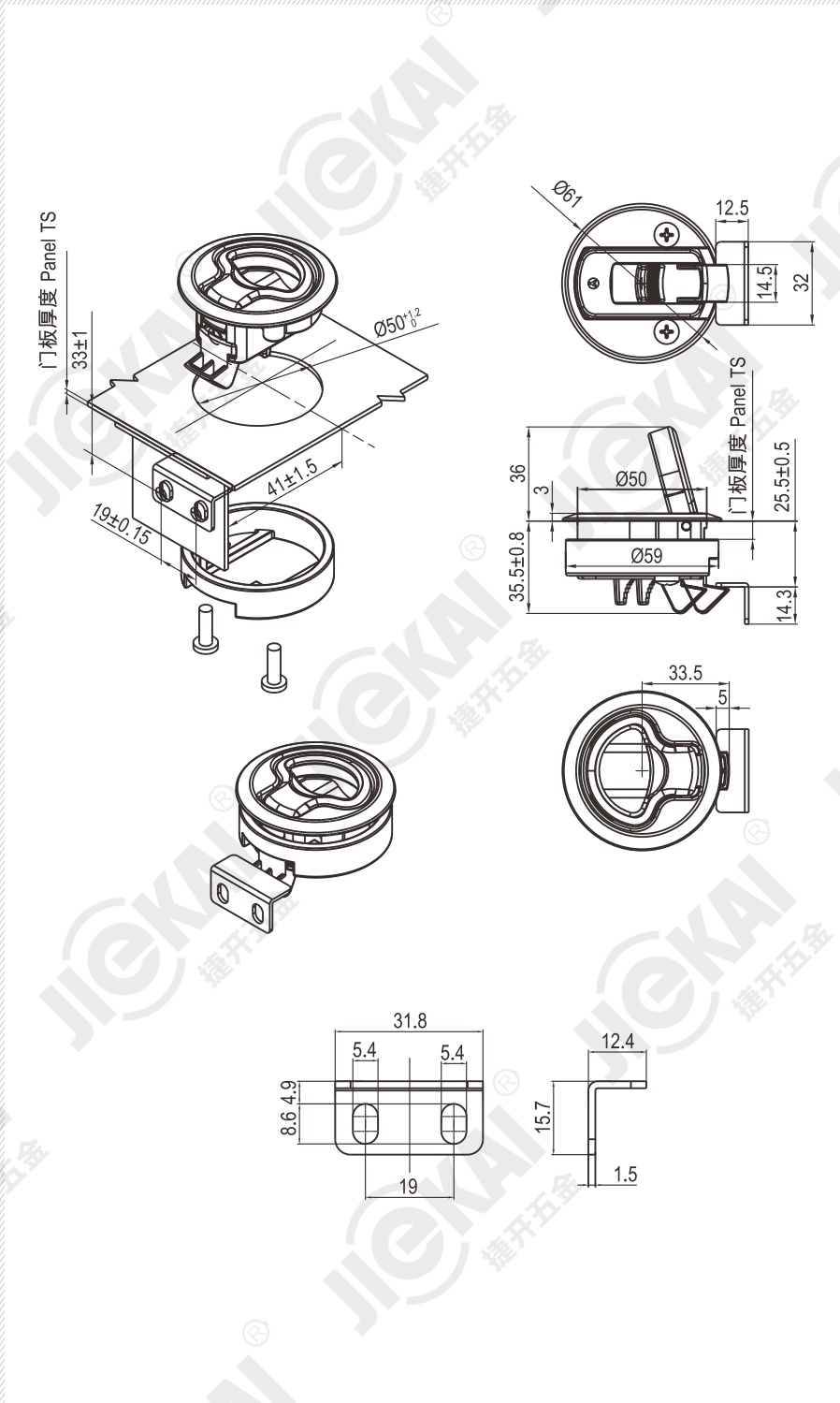

门板厚度 Panel thickness		固定支架高度 Mounting bracket height	固定螺丝高度 Fixing screw length	带锁芯型 Key locking version		不带锁芯型 Non-locking version	
最小MIN	最大MAX			全不锈钢 Stainless steel	塑料黑色 Acetal black	全不锈钢 Stainless steel	塑料黑色 Acetal black
2	7	14	16	SC256A-3K1-XX	PM256A-7K1-XX	SC256A-3N1-XX	PM256A-7N1-XX
7	12	14	20	SC256B-3K1-XX	PM256B-7K1-XX	SC256B-3N1-XX	PM256B-7N1-XX
12	17	3.8	16	SC256C-3K1-XX	PM256C-7K1-XX	SC256C-3N1-XX	PM256C-7N1-XX
17	22	3.8	20	SC256D-3K1-XX	PM256D-7K1-XX	SC256D-3N1-XX	PM256D-7N1-XX

PM342



产品说明
Description

◆ 锌合金锁座、锁柄，按键-塑胶，(S) 镀铬-光面
Lock body, lock handle zinc alloy, button-plastic,
(S)chrome-silver

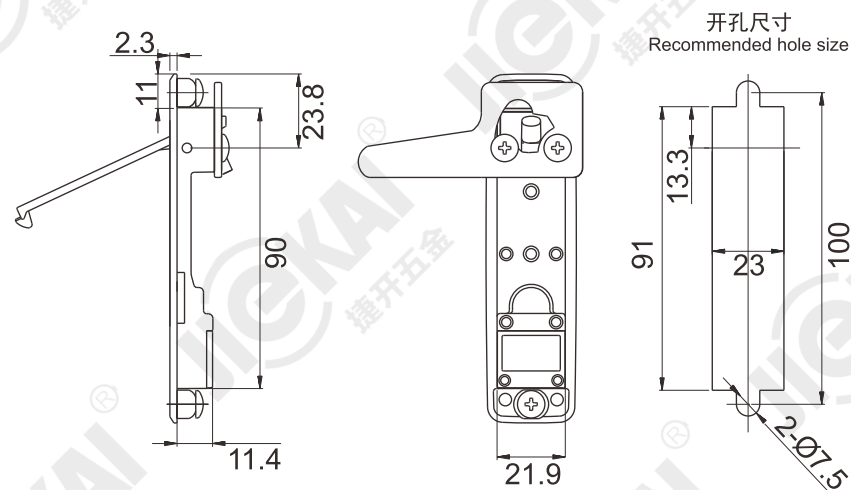
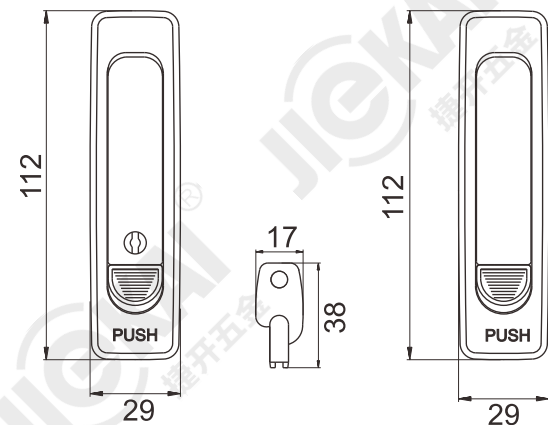

规格型号 Specifications		
PM342Z-1S1-S	PM342P-1S1-S	PM342P-1O1-S

PM343



产品说明
Description

◆ 锌合金锁座、锁柄，按键-塑胶，(S) 镀铬-光面
Lock body, lock handle zinc alloy, button-plastic,
(S)chrome-silver

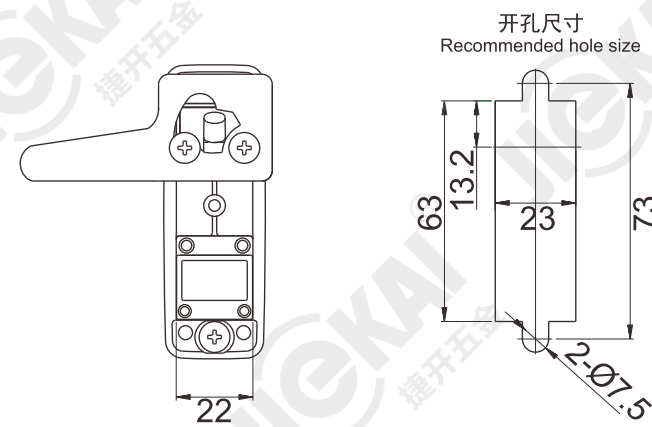
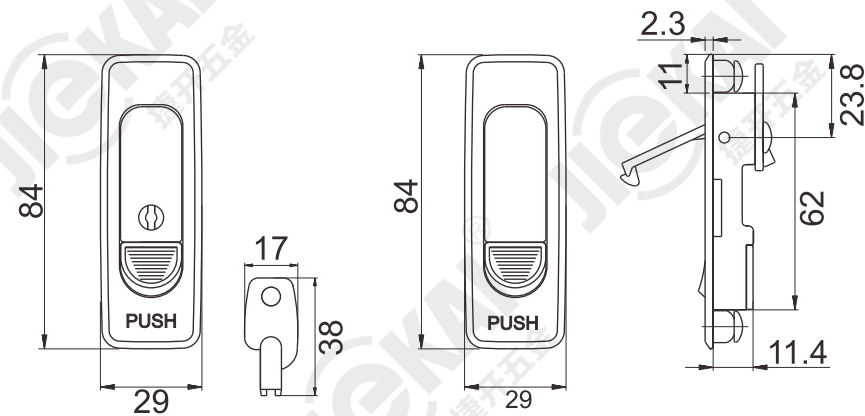

规格型号 Specifications	
PM343P-1S1-S	PM343P-1O1-S

PM350



产品说明
Description

◆ 锌合金锁座、锁柄, (S)镀铬-光面, (SS)喷砂-镀铬, (P)砂面黑色耐刮面
Zinc alloy lock body, lock handle, (S)chrome plating-silver, (SS)aventurine chrome plating-like silver metallic coated, (P)electroplate black sand blasting(with granule substance and scrape resistance surface)

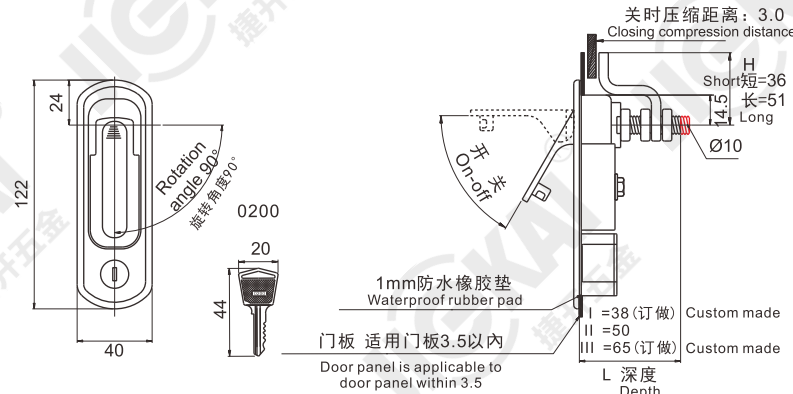

开孔尺寸
Recommended hole size

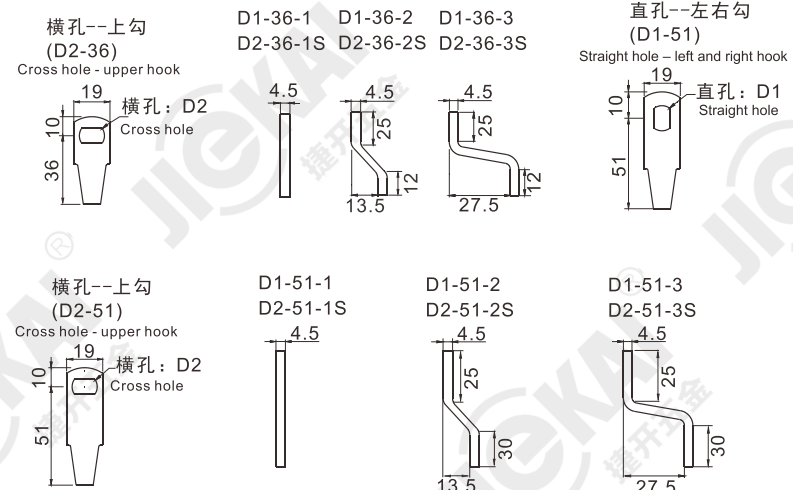
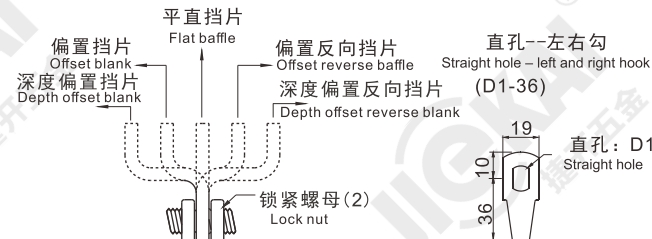
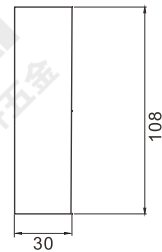

规格型号
Specifications

PM350-1S2-S PM350-1S2-B PM350-1S2-SS

PM351



产品说明
Description

◆ 锌合金锁座、锁柄, (S)镀铬-光面, (SS)喷砂-镀铬, (P)砂面黑色耐刮面
Zinc alloy lock body, lock handle, (S)chrome plating-silver, (SS)aventurine chrome plating-like silver metallic coated, (P)electroplate black sand blasting(with granule substance and scrape resistance surface)

PM3601



产品说明
Description

◆ 锌合金锁座、锁柄, (G)镀香槟色, 做防静电处理(外观无毒处理, 符合欧盟RoHS规范), (B)电著涂装黑色
Zinc alloy lock body, lock handle, (G)champagne-plate and prevent static-electricity(the surface is non-toxic processed and meets the RoHS standard of EU), (B)electro-deposit coating black.

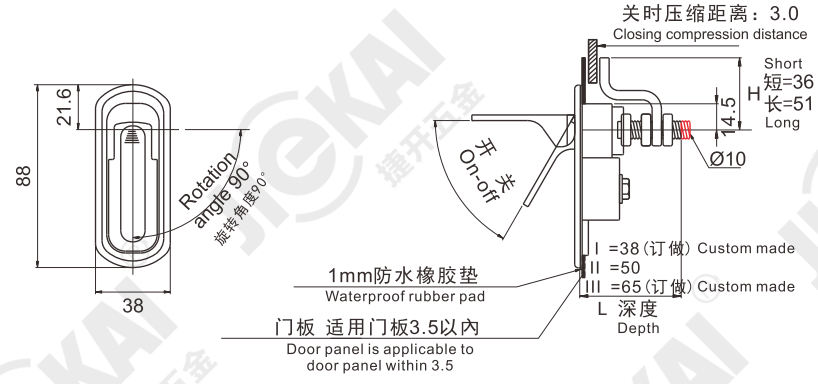

开孔尺寸
Recommended hole size

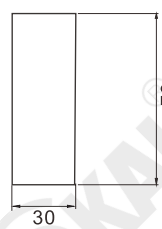

规格型号
Specifications

PM351-102-S PM351-102-P

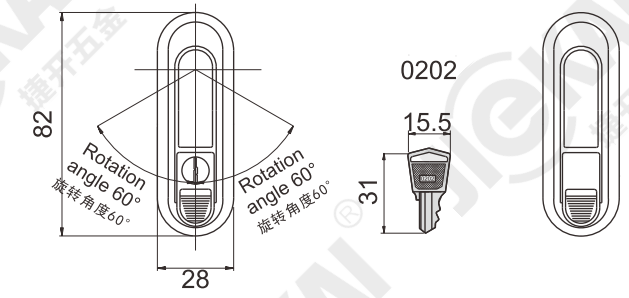

伸缩3mm
Stretch

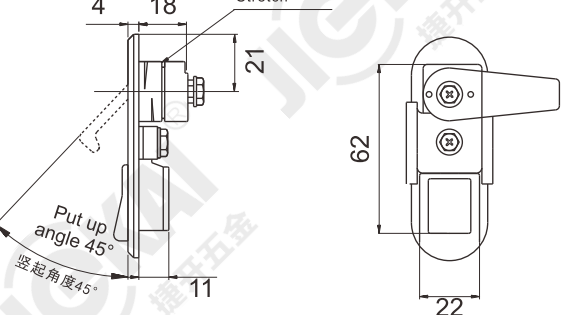

规格型号
Specifications

PM3601-1S1-G PM3601-1N1-G PM3601-1S1-B PM3601-1N1-B

PM3602



产品说明
Description

- ◆ 锌合金锁座、锁柄, (G) 镀香槟色, 做防静电处理(外观无毒处理, 符合欧盟RoHS规范), (B) 电著涂装黑色
- Zinc alloy lock body, lock handle, (G) champagne-plate and prevent static-electricity(the surface is non-toxic processed and meets the RoHS standard of EU), (B) electro-deposit coating black.

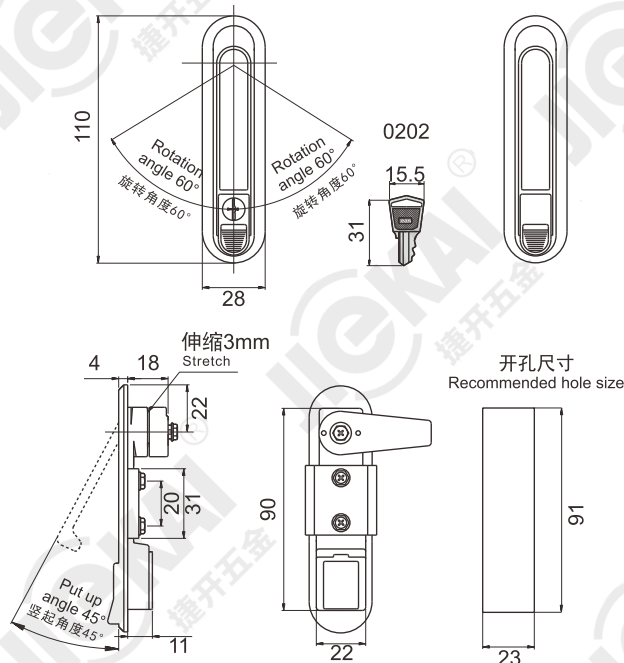

规格型号
Specifications

PM3602-1S1-G	PM3602-1N1-G	PM3602-1S1-B	PM3602-1N1-B
--------------	--------------	--------------	--------------

PM3611



产品说明
Description

- ◆ 锌合金锁座、锁柄, (G) 镀香槟色, 做防静电处理(外观无毒处理, 符合欧盟RoHS规范), (B) 电著涂装黑色(订做), (S) 喷砂-镀铬(订做)
- Zinc alloy lock body, lock handle, (G) champagne-plate and prevent static-electricity(the surface is non-toxic processed and meets the RoHS standard of EU), (B) electro-deposit coating black(custom-made), (S) silver aventurine-like silver metallic coated(custom-made).

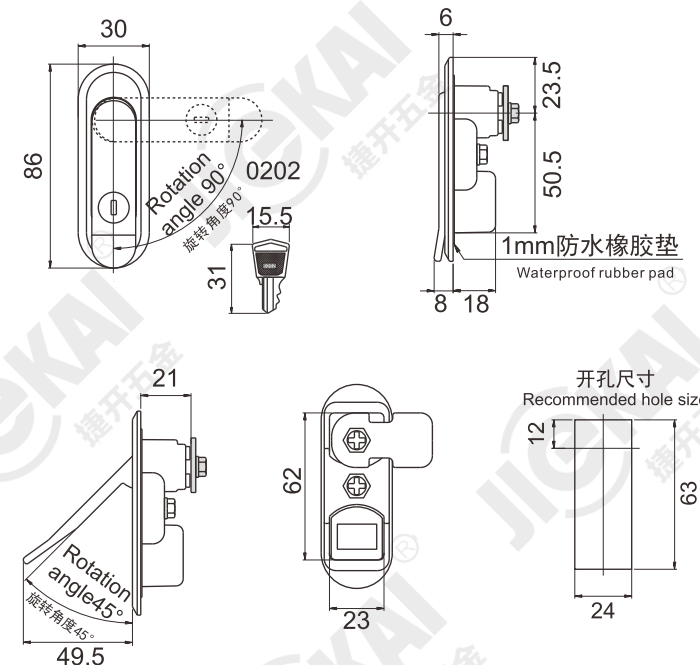

规格型号
Specifications

PM3611-1K1-G	PM3611-1K1-S
--------------	--------------

PM3612



产品说明
Description

- ◆ 锌合金锁座、锁柄, (G) 镀香槟色, 做防静电处理(外观无毒处理, 符合欧盟RoHS规范), (B) 电著涂装黑色(订做), (S) 喷砂-镀铬(订做)
- Zinc alloy lock body, lock handle, (G) champagne-plate and prevent static-electricity(the surface is non-toxic processed and meets the RoHS standard of EU), (B) electro-deposit coating black(custom-made), (S) silver aventurine-like silver metallic coated(custom-made).

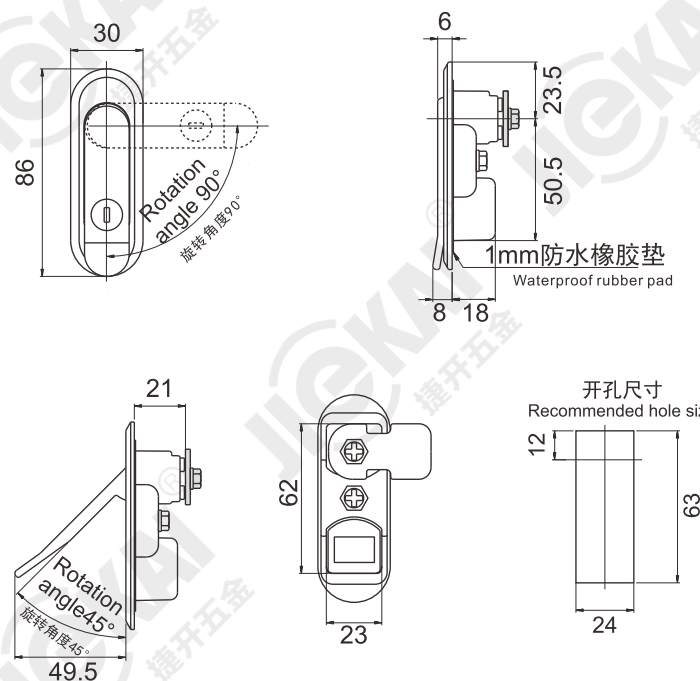

规格型号
Specifications

PM3612-1N1-G	PM3612-1N1-S	PM3612-1K1-G	PM3612-1K1-S
--------------	--------------	--------------	--------------

PM3603



产品说明
Description

- ◆ 锌合金锁座、锁柄, (G) 镀香槟色, 做防静电处理(外观无毒处理, 符合欧盟RoHS规范), (B) 电著涂装黑色
- Zinc alloy lock body, lock handle, (G) champagne-plate and prevent static-electricity(the surface is non-toxic processed and meets the RoHS standard of EU), (B) electro-deposit coating black.

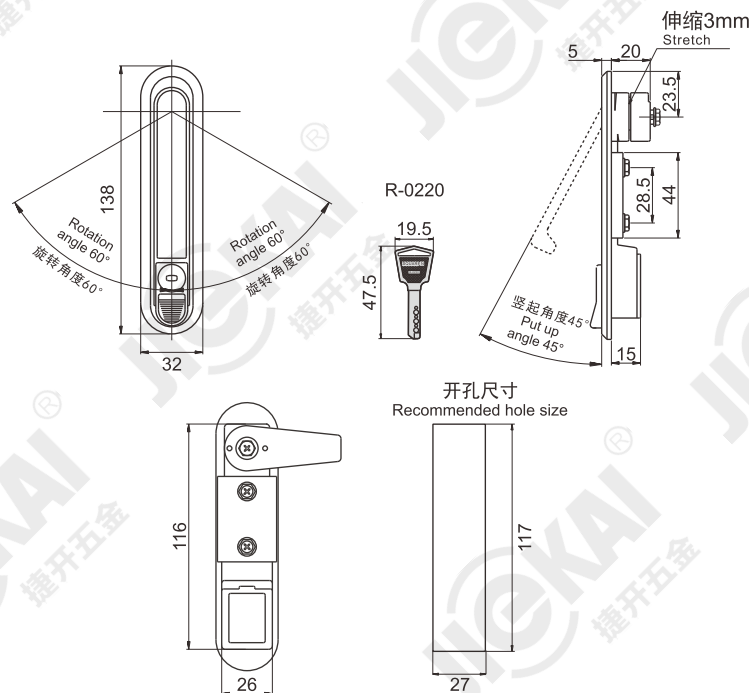

规格型号
Specifications

PM3603-1S1-G-001 圆钥匙 Tubular key	PM3603-1S1-G-002 平钥匙 Flat key
----------------------------------	-------------------------------

电源锁
Key switch lock

转舌锁
Cam lock

圆柱锁
Quarter turn lock

连杆锁
Rob control lock

平面锁
Plane lock

把手锁
Handle lock

面板锁
Panel lock

拉手
Handles

限位
Door stop

外装铰链
External hinge

内装铰链
Internal hinge

搭扣
Toggle lock

密封条
Gasket

配件
Accessories

电源锁
Key switch lock

转舌锁
Cam lock

圆柱锁
Quarter turn lock

连杆锁
Rob control lock

平面锁
Plane lock

把手锁
Handle lock

面板锁
Panel lock

拉手
Handles

限位
Door stop

外装铰链
External hinge

内装铰链
Internal hinge

搭扣
Toggle lock

密封条
Gasket

配件
Accessories

PM3621



产品说明
Description

- ◆ 锌合金锁座、锁柄, (G) 镀香槟色, 做防静电处理 (外观无毒处理, 符合欧盟RoHS规范), (B) 电著涂装黑色 (订做), (F) 镀铬-水雾面 (订做)

Zinc alloy lock body, lock handle, (G) champagne-plate and prevent static-electricity (the surface is non-toxic processed and meets the RoHS standard of EU), (B) electro-deposit coating black (custom-made), (F) chrome plating-fume (custom-made).

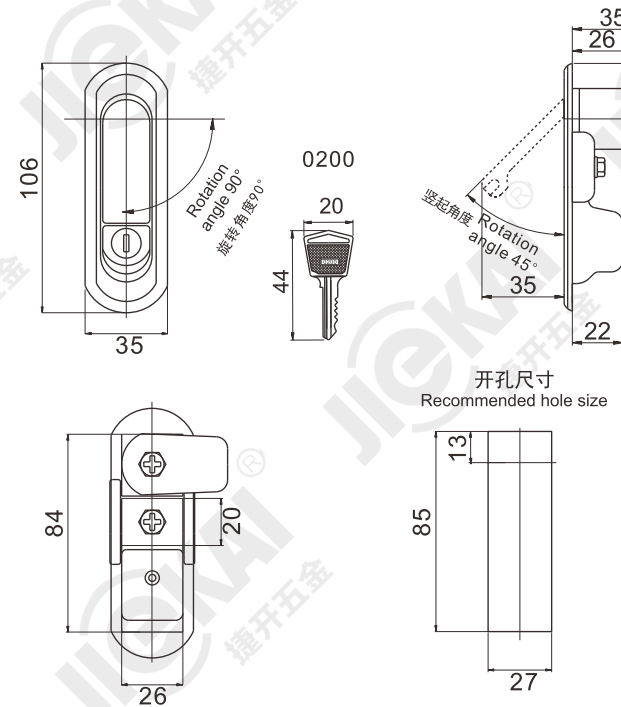

规格型号
Specifications

PM3621-1S1-G

PM3621-1S1-B

PM3623



产品说明
Description

- ◆ 锌合金锁座、锁柄, (G) 镀香槟色, 做防静电处理 (外观无毒处理, 符合欧盟RoHS规范), (B) 电著涂装黑色 (订做), (F) 镀铬-水雾面 (订做)

Zinc alloy lock body, lock handle, (G) champagne-plate and prevent static-electricity (the surface is non-toxic processed and meets the RoHS standard of EU), (B) electro-deposit coating black (custom-made), (F) chrome plating-fume (custom-made).

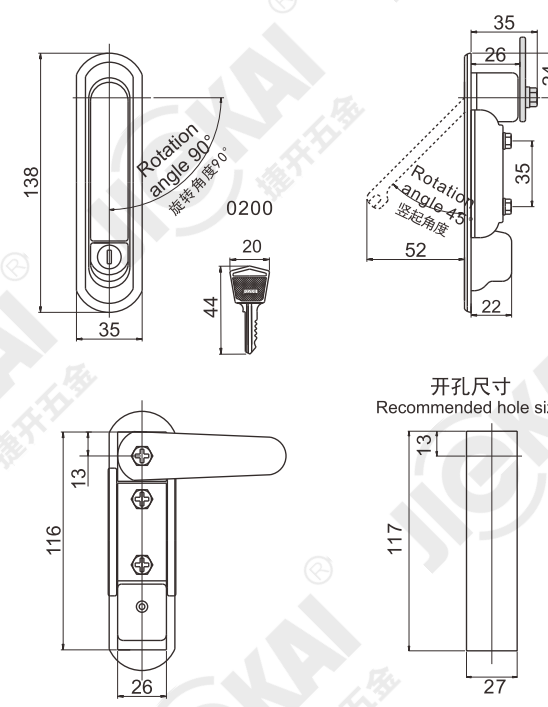

规格型号
Specifications

PM3623-1S1-G

PM3623-1S1-F

PM3622



产品说明
Description

- ◆ 锌合金锁座、锁柄, (G) 镀香槟色, 做防静电处理 (外观无毒处理, 符合欧盟RoHS规范), (B) 电著涂装黑色 (订做), (F) 镀铬-水雾面 (订做)

Zinc alloy lock body, lock handle, (G) champagne-plate and prevent static-electricity (the surface is non-toxic processed and meets the RoHS standard of EU), (B) electro-deposit coating black (custom-made), (F) chrome plating-fume (custom-made).

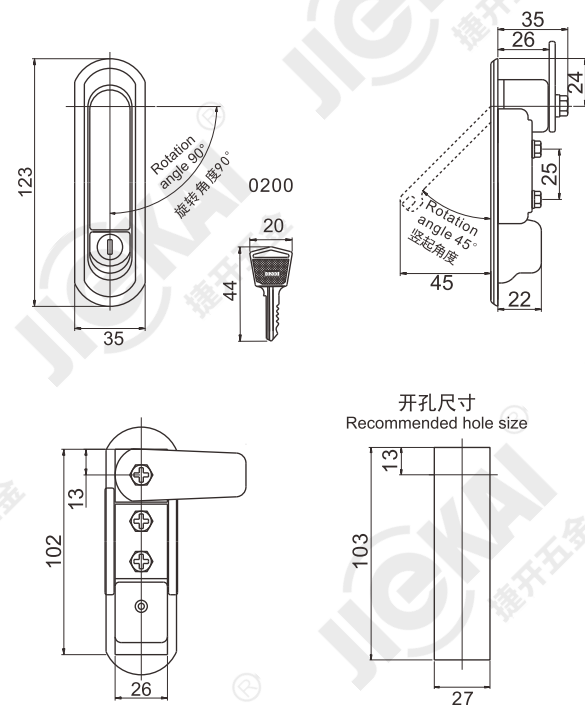

规格型号
Specifications

PM3622-1S1-G

PM3622-1S1-B

PM3802



产品说明
Description

- ◆ 锌合金锁座、锁柄, (S) 喷砂-镀铬, (B) 电著涂装黑色, (G) 镀香槟色, 做防静电处理 (外观无毒处理, 符合欧盟RoHS规范)

Zinc alloy lock body, lock handle, (S) aventurine chrome plating-like silver metallic coated, (B) electro-deposit coating black, (G) champagne-plated and prevent static-electricity (the surface is non-toxic processed and meets the RoHS standard of EU).

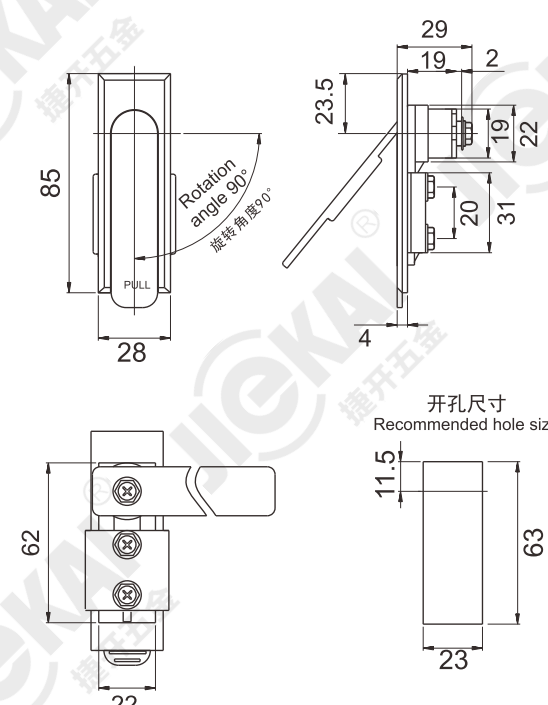

规格型号
Specifications

PM3802-1N1-G

电源锁
Key switch lock

转舌锁
Cam lock

圆柱锁
Quarter turn lock

连杆锁
Rob control lock

平面锁
Plane lock

把手锁
Handle lock

面板锁
Panel lock

拉手
Handles

限位
Door stop

外装铰链
External hinge

内装铰链
Internal hinge

搭扣
Toggle lock

密封条
Gasket

配件
Accessories

电源锁
Key switch lock

转舌锁
Cam lock

圆柱锁
Quarter turn lock

连杆锁
Rob control lock

平面锁
Plane lock

把手锁
Handle lock

面板锁
Panel lock

拉手
Handles

限位
Door stop

外装铰链
External hinge

内装铰链
Internal hinge

搭扣
Toggle lock

密封条
Gasket

配件
Accessories

PM3803



产品说明 Description

- ◆ 锌合金锁座、锁柄, (S) 喷砂-镀铬, (B) 电著涂黑色, (G) 镀香槟色, 做防静电处理 (外观无毒处理, 符合欧盟RoHS规范)

Zinc alloy lock body, lock handle, (S) aventurine chrome plating-like silver metallic coated, (B) electro-deposit coating black, (G) champagne-plated and prevent static-electric (the surface is non-toxic processed and meets the RoHS standard of EU).

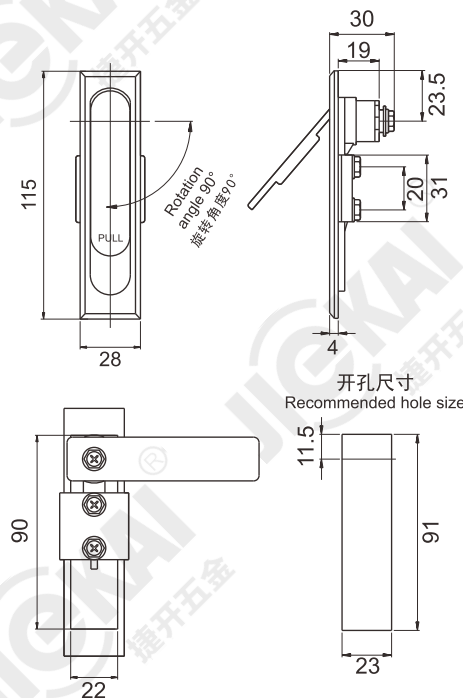

规格型号 Specifications

PM3803-1N1-G

PM3803-1N1-S

PM4621



产品说明 Description

- ◆ 锌合金锁座、锁柄, (S) 镀铬-光面, (B) 电著涂黑色 (订做)

Zinc alloy lock body, lock handle, (S) chrome plating-silver, (B) electro-deposit coating black (custom-made)

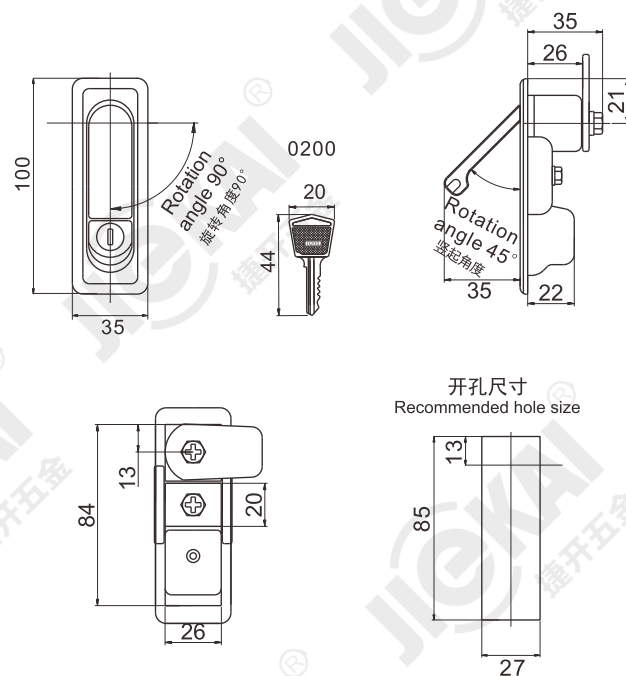

规格型号 Specifications

PM4621-1S1-S

PM4621-1S1-B

PM4622



产品说明 Description

- ◆ 锌合金锁座、锁柄, (S) 镀铬-光面, (B) 电著涂黑色 (订做)

Zinc alloy lock body, lock handle, (S) chrome plating-silver, (B) electro-deposit coating black (custom-made)

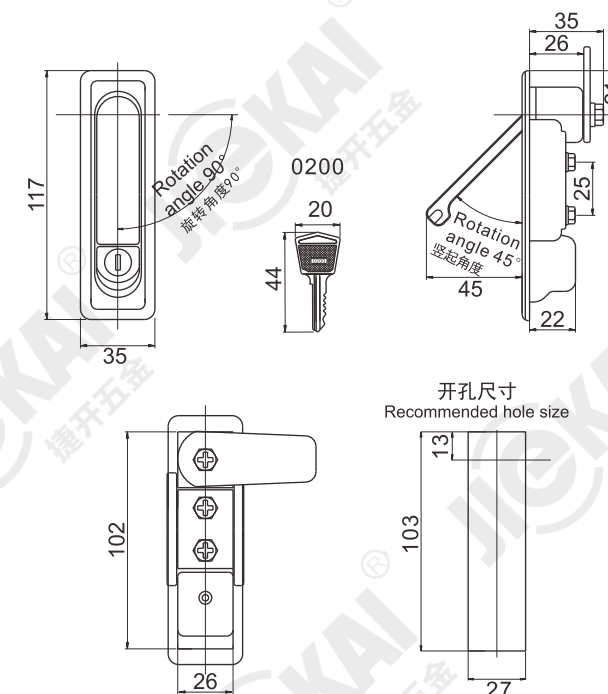

规格型号 Specifications

PM4622-1S1-S

PM4622-1S1-B

PM4623



产品说明 Description

- ◆ 锌合金锁座、锁柄, (S) 镀铬-光面, (B) 电著涂黑色 (订做)

Zinc alloy lock body, lock handle, (S) chrome plating-silver, (B) electro-deposit coating black (custom-made)

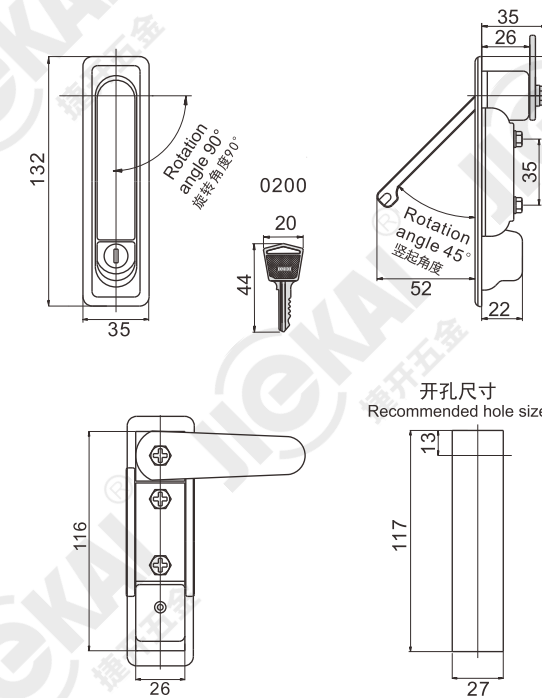

规格型号 Specifications

PM4623-1S1-S

PM4623-1S1-B

电源锁
Key switch lock

转舌锁
Cam lock

圆柱锁
Quarter turn lock

连杆锁
Rob control lock

平面锁
Plane lock

把手锁
Handle lock

面板锁
Panel lock

拉手
Handles

限位
Door stop

外装铰链
External hinge

内装铰链
Internal hinge

搭扣
Toggle lock

密封条
Gasket

配件
Accessories

电源锁
Key switch lock

转舌锁
Cam lock

圆柱锁
Quarter turn lock

连杆锁
Rob control lock

平面锁
Plane lock

把手锁
Handle lock

面板锁
Panel lock

拉手
Handles

限位
Door stop

外装铰链
External hinge

内装铰链
Internal hinge

搭扣
Toggle lock

密封条
Gasket

配件
Accessories

PM490



产品说明
Description

- ◆ 铝合金锁座、锁柄, (B) 电著涂装黑色
Aluminium alloys lock body, lock handle, (B) electro-deposit coating black.

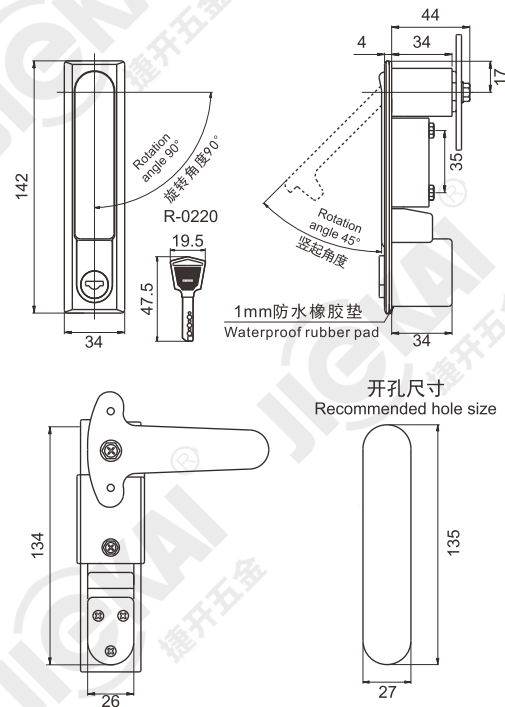

规格型号
Specifications
PM490-1S1-B

PM4501



产品说明
Description

- ◆ 锌合金锁座、锁柄, (S) 镀铬-光面
Zinc alloy lock body, lock handle, (S) chrome plated-silver.

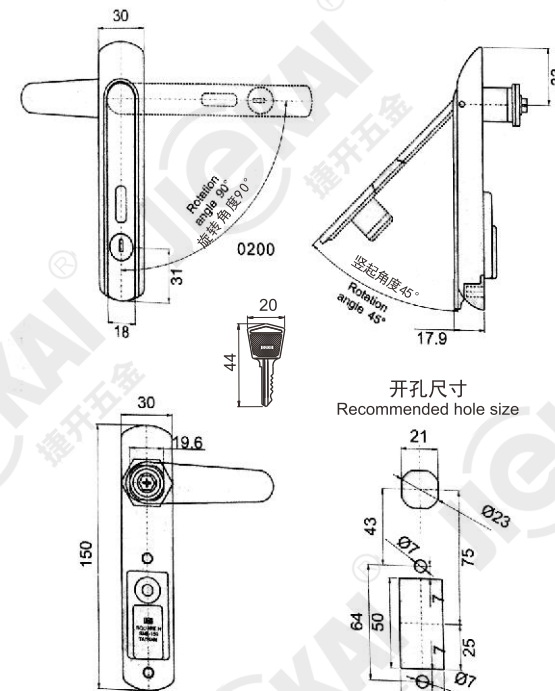

规格型号
Specifications
PM4501-1K1-S

PM499



产品说明
Description

- ◆ 锌合金锁座、锁柄, (G) 抛光, 镀香槟色, 做防静电处理 (外观无毒处理, 符合欧盟RoHS规范)
Zinc alloy lock body, lock handle, (G) champagne-plated and prevent static-electricity (the surface is non-toxic processed and meets the RoHS standard of EU).

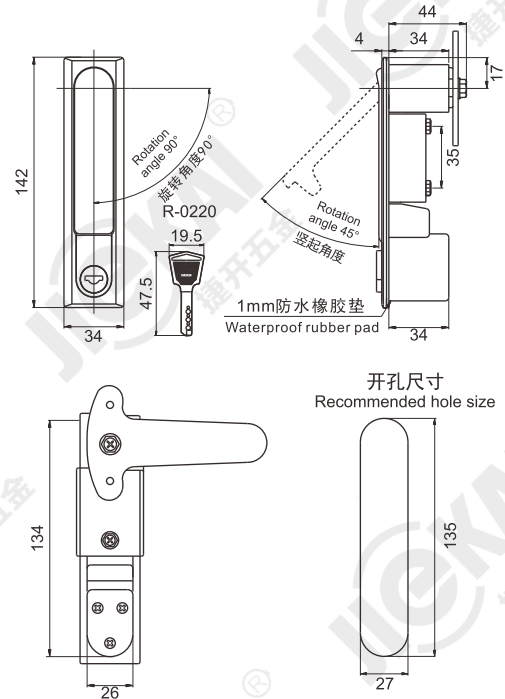

规格型号
Specifications
PM499-1S1-G

PM4502



产品说明
Description

- ◆ 锌合金锁座、锁柄, (S) 镀铬-光面
Zinc alloy lock body, lock handle, (S) chrome plated-silver.

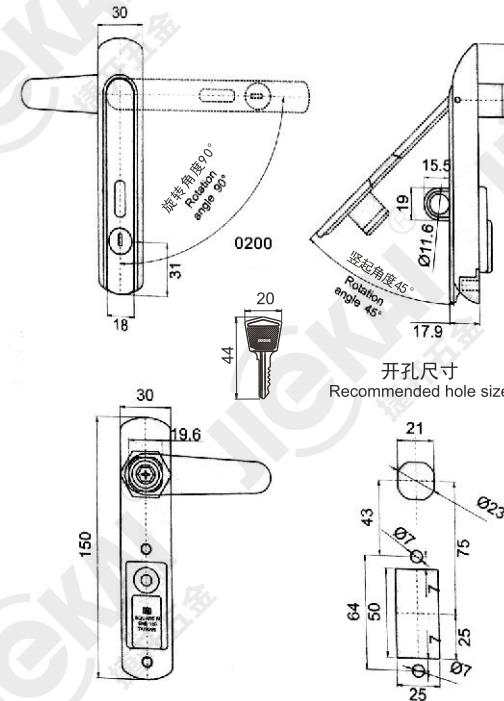

规格型号
Specifications
PM4502-1S1-S

PM5052



产品说明
Description

◆ 锌合金锁座、锁柄, (S) 喷砂-镀铬, (B) 电
著涂装黑色 (订做)
Zinc alloy lock body, lock handle, (S) silver aventurine
like silver metallic coated, (B) electro-deposit coating
black (custom-made)

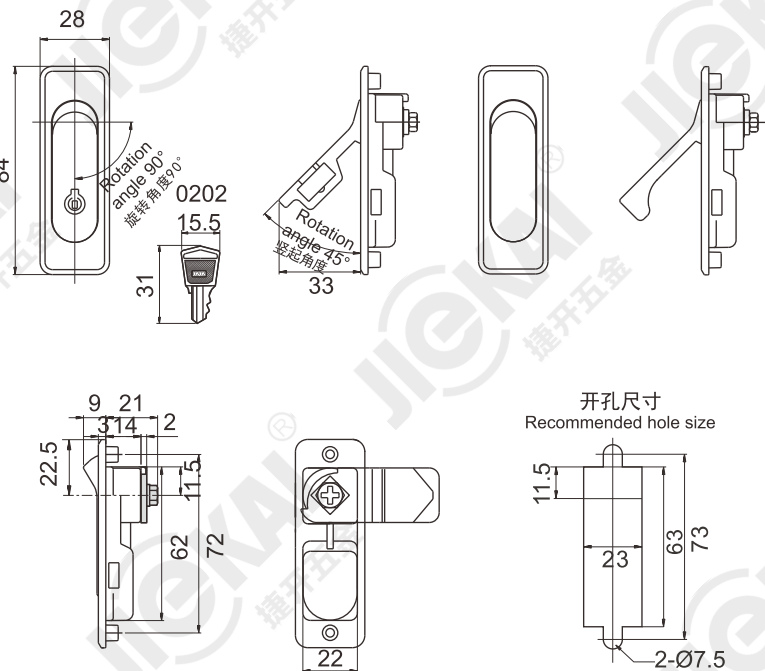

规格型号
Specifications

PM5052-1K1-S

PM5052-1N1-S

PM5053



产品说明
Description

◆ 锌合金锁座、锁柄, (S) 喷砂-镀铬, (B) 电
著涂装黑色 (订做)
Zinc alloy lock body, lock handle, (S) silver aventurine
like silver metallic coated, (B) electro-deposit coating
black (custom-made)

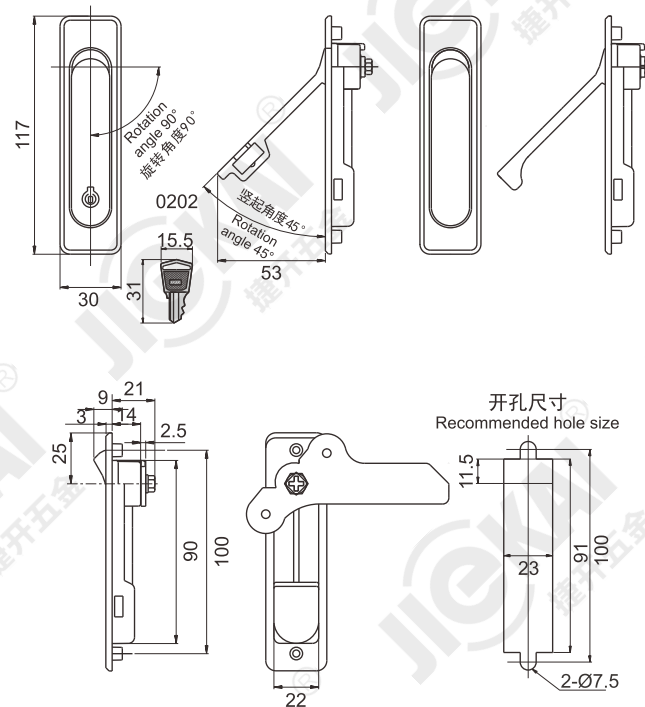

规格型号
Specifications

PM5053-1K1-S

PM5053-1N1-S

PM6071



PM6072



PM6073



产品说明
Description

◆ 锌合金锁座、锁柄、镀锌压板、锁片、
镀沙铬, 喷无光黑
Zinc alloy lock body, lock handle, zinc plating cam,
fixing parts, gray chrome plating, black powder coated

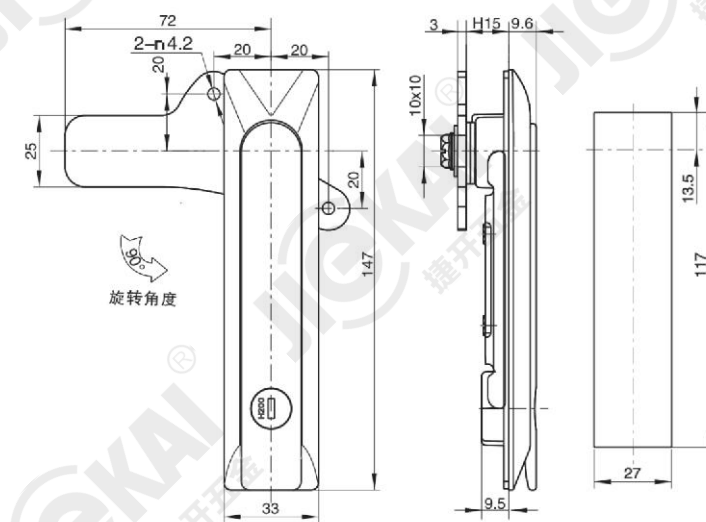
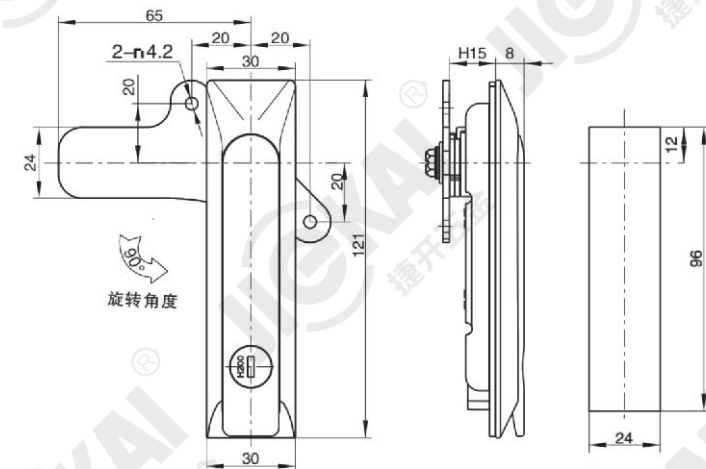
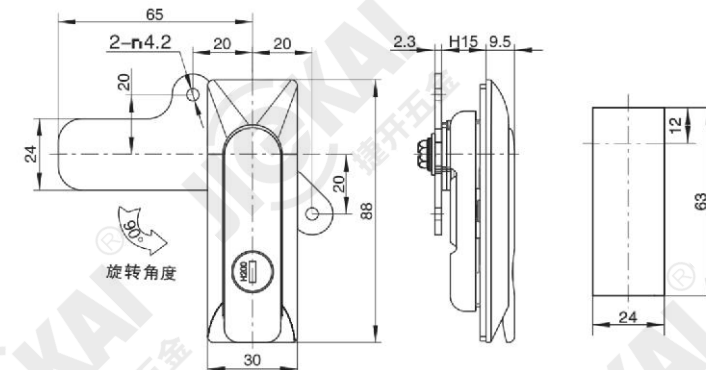

规格型号
Specifications

PM6071-1K1-P1

PM6072-1K1-P1

PM6073-1K1-P1

PM6071-1K1-E5

PM6072-1K1-E5

PM6073-1K1-E5