

快速使用教程

分光测色仪
使用说明书

产品介绍

使用产品前请仔细阅读本说明书,并妥善保管

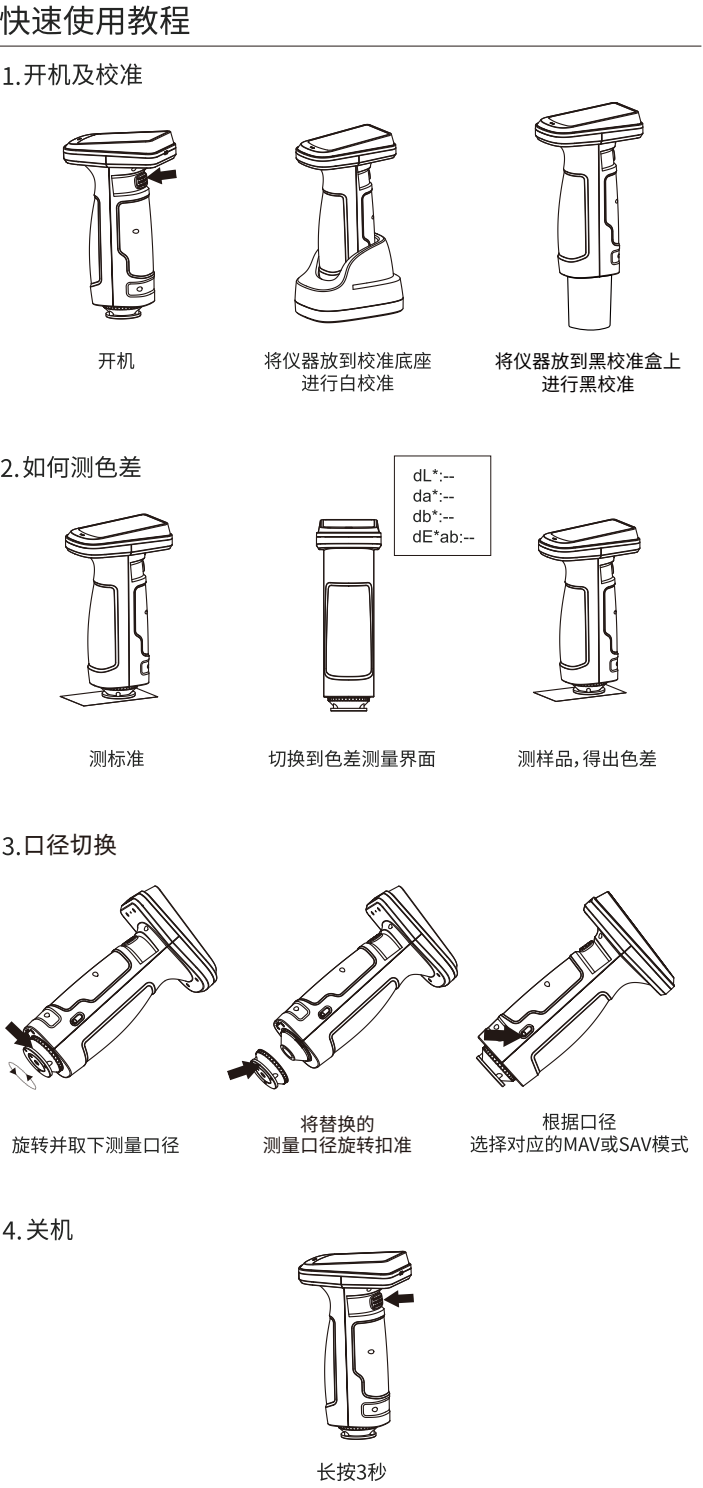
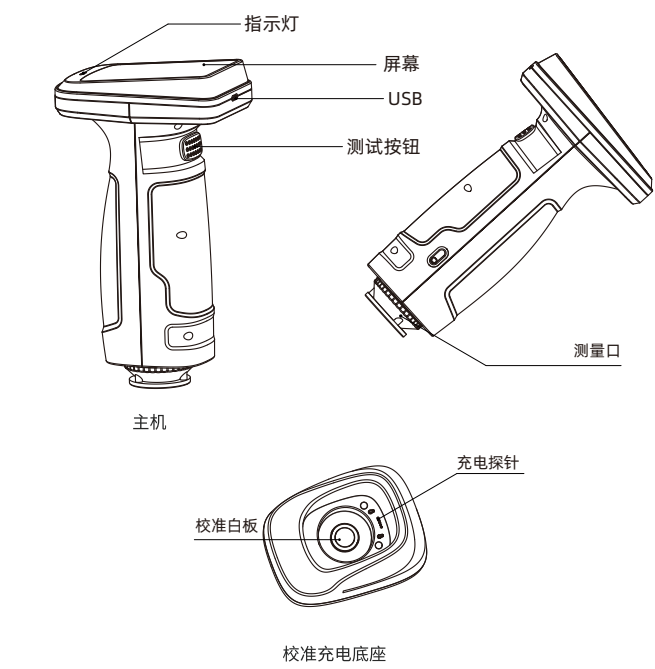

基础参数	
照明/受光系统:	45/0(45°环形照明, 0°观察角)
传感器:	双列高精度CMOS阵列感应器
分光方式:	光栅
测量波长范围:	400-700nm
测量波长间隔:	10nm
反射率测定范围:	0-200%, 分辨率: 0.01%
照明光源:	全波段均衡LED光源
测量时间:	约1秒
测量口径:	稳定型: Φ11mm, Φ6mm, Φ3mm, 1*3mm; 灵巧型: ▽11mm, ▽6mm, ▽3mm, ▽1*3mm
重复性:※	ΔE*ab≤ 0.02 光谱反射率:标准偏差小于0.08%
台间差:※※	ΔE*ab≤0.25
语言模式:	简体中文, 英语
显示精度:	0.01
标准观察者:	2°, 10°
观察光源:	A,B,C,D50,D55,D65,D75,F1,F2,F3,F4,F5,F6, F7,F8,F9,F10,F11,F12,CWF,U30,U35,DLF,NBF,TL83, TL84,ID50,ID65,LED-B1,LED-B2,LED-B3,LED-B4, LED-B5,LED-BH1,LED-RGB1,LED-V1,LED-V2
测量指标:	光谱反射率,CIE-Lab,CIE-LCh,HunterLab, CIE-Luv,XYZ,Yxy,RGB, 色差(ΔE*ab,ΔE*cmc,ΔE*94,ΔE*00), 白度(ASTM E313-00,ASTM E313-73,CIE/ISO, AATCC,Hunter,TaubeBergerStensby), 黄度(ASTM D1925,ASTM E313-00,ASTM E313-73), 黑度(My,dM),沾色牢度,变色牢度, Tint(ASTM E313-00),同色异谱指数Milm, 孟塞尔,遮盖力,力份(染料强度,着色力) 色密度CMYK(A,T,E,M),网点面积,网点面积增大, 叠印率,印刷反差,灰度,色调误差
印刷质量指标:	仪器: 标样100条, 试样10000条; APP: 海量存储
存储:	USB, 蓝牙
端口:	单次充电可连续测量8000次, 7.2V/3000mAh
电池容量:	智能自动校准
校准:	Andriod, IOS, Windows, 微信小程序
软件支持:	保证一级计量合格
准确性保证:	CIE No.15, GB/T 3978,GB 2893,GB/T 18833, ISO7724-1,ASTM E1164,DIN5033 Teil7
符合标准:	IPS全彩屏幕, 3.5英寸
屏幕:	10年100万次
光源寿命:	
※ 仪器校正后,以5秒间隔测量白色校正板30次以MAV口径测量结果标准偏差	
※※ BCRA系列 II 12块色板测量平均值	
参数如有修改,恕不另行通知	

保修说明	
本产品售后服务严格依据《中华人民共和国消费者权益保护法》、《中华人民共和国产品质量法》实行售后三包服务,服务内容如下:	
1、自您签收日起7日内,本产品出现《产品性能故障表》所列性能故障的情况,经由本司售后服务中心检测确定,可免费享受退货或换货服务;	
2、自您签收日起8-15日内,本产品出现《产品性能故障表》所列性能故障的情况,经由本司售后服务中心检测确定,可免费享受换货或维修服务;	
3、由您签收日起至保修期结束,本产品出现《产品性能故障表》所列性能故障的情况,经由本司售后服务中心检测确定,可免费享受维修服务。	
提示信息	
因运输过程中需用包装箱保证产品运输安全,建议自签收日起至少保留包装箱30天。	
非保修条例	
1、未经授权的维修、误用、碰撞、疏忽、滥用、进液、事故、改动、使用非本产品配件,或撕毁涂改标签、防伪标记;	
2、已超过三包有效期;	
3、因不可抗力造成的破坏;	
4、不符合《产品性能故障表》所列性能故障的情况;	
5、因人为原因导致非本产品及其配件产生《产品性能故障表》所列性能故障。	
警告	
· 请勿尝试拆卸或更换仪器内部零件,如需服务请联系代理商或官方客服。	
· 请勿将仪器放置于热源或直接暴露在炉火旁。	
· 若任何液体不小心进入仪器,请立即关闭仪器电源。	
· 本产品及内部零件,如被儿童误食可能导致窒息等危险。	
性能故障表	
名称	性能故障
分光测色仪	1、电源指示灯不亮(电池没电除外); 2、仪器开关卡滞,不能正常开关; 3、仪器显示器无法正常显示; 4、测量光源不亮; 5、蓝牙无法连接。

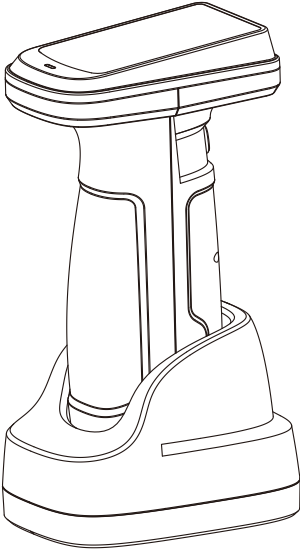

Spectrophotometer Operation Instruction

Product introduction

Please read this manual carefully before using the product.

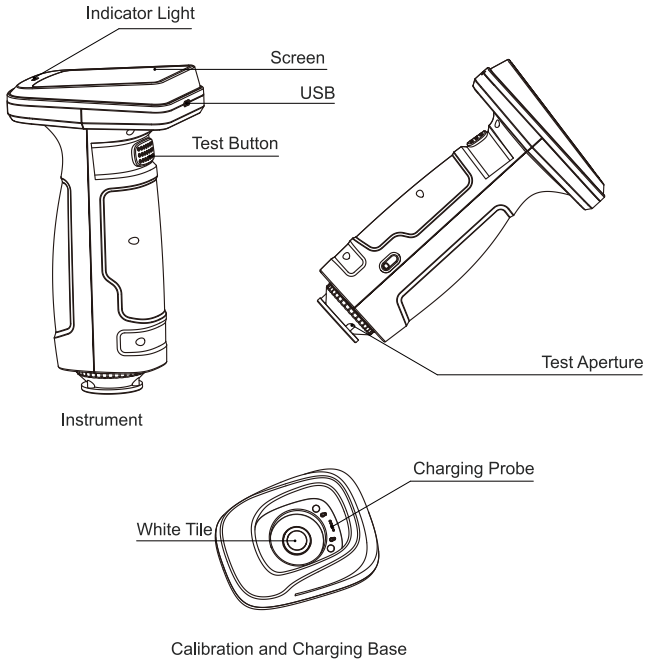

Quick Start

1. Power on and Calibration

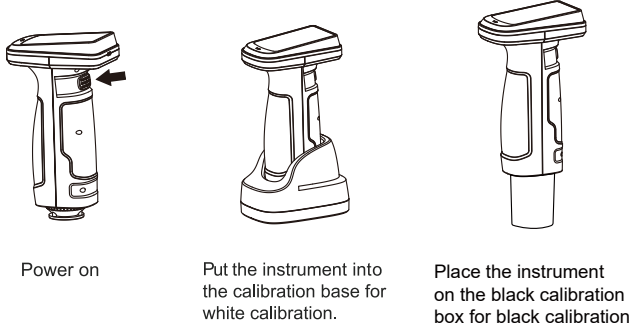

2. How to measure color difference

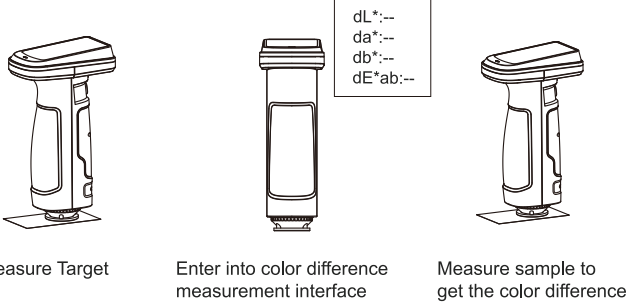

3. Switch Aperture

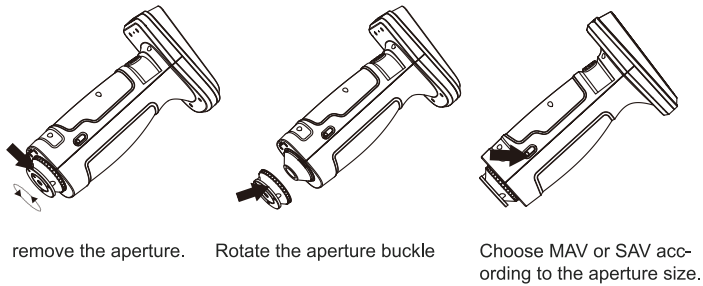

4. Power off

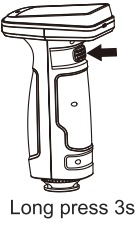

Parameters

Geometry:	45/0
Sensor:	DualopticalpathhighpreciseCMOSarraysensor
Spectroscopic method:	Grating spectroscopy
Wavelength Range:	400-700nm
Wavelength Interval:	10nm
Reflectance Range:	0-200%, resolution 0.01%
Light Source:	LED(FullwavelengthbalancedLED)
Measurement Time:	About 1s
Measuring aperture:	4w/ plate and 4w/o plate:Φ11mm,Φ6mm,Φ3mm, 1*3mm;▽11mm,▽6mm,▽3mm,▽1*3mm
Repeatability:※	Standard deviation within ΔE*ab ≤ 0.02
Inter-instrument agreement:※※	Spectral reflectance: standard deviation less than 0.08% ΔE*ab≤0.25
Language:	English and Chinese
Display Resolution:	0.01
Observer Angles:	2°, 10°
Illuminants:	A,B,C,D50,D55,D65,D75,F1,F2,F3,F4,F5,F6, F7,F8,F9,F10,F11,F12,CWF,U30,U35,DLF,NBF,TL83, TL84,ID50,ID65,LED-B1,LED-B2,LED-B3,LED-B4, LED-B5,LED-BH1,LED-RGB1,LED-V1,LED-V2
Color Spaces and Indices:	Reflectance, CIE-Lab, CIE-LCh, HunterLab, CIE Luv, XYZ, Yxy, RGB, Color difference(ΔE*ab, ΔE*cmc, ΔE*94,ΔE*00), WI(ASTM E313-00,ASTM E313-73,CIE/ISO, AATCC, Hunter, Taube Berger Stensby), YI(ASTM D1925,ASTM E313-00,ASTM E313-73), Blackness(My,dM),Color Fastness, Tint,(ASTM E313-00),Milm, Munsell, Opacity, Color strength
Printing quality indicators:	Color Density CMYK(A,T,E,M),Tone Value, Tone Value Increase,Trapping,Printing characteristics,Contrast,Hue Error & Grayness
Storage:	Instrument: 100 standard and 10,000 samples; APP Mass Storage
Interface:	USB, Bluetooth
Battery:	Rechargeable, 8000 times continuous tests, 7.2V/3000mAh
Calibration:	Intelligent auto calibration
Software:	Andriod,IOS,Windows
Accuracy:	Metrology Level I
Standards:	Conform to CIE No.15, GB/T 3978, GB 2893, GB/T 18833, ISO7724-1, ASTM E1164, DIN5033 Teil7
Screen:	IPS Full Color Screen,3.5 inches
Light Source Lifetime:	10 years, 1 million tests

※ When a white tile is measured 30 times at 5-seconds interval with MAV

※※ BCRA Series II , average measurement of 12 tiles

Parameters are subject to change without notice

Warranty

Reminder

It is recommend that keep the packing box for at least 30 days as the packing box is required to ensure the safety of transportation.

Non warranty regulations

- 1.Unauthorized repair,misuse,accident,modification,use of nonofficial accessories.
- 2.Instrument is out of warranty.
- 3.Damage caused by force.
- 4.Not the performance failure listed in the product performance failure table.
- 5.Performance failure caused by human factors.

Warning

- .Do not attempt to disassemble or replace any part of the equipment. Please contact the agent or official customer service for after sales service.
- .Do not place the equipment near heat source or directly expose to the fire.
- .If any liquid enters the equipment,please power off the equipment immediately.
- .This product contains small parts.It may cause suffocation and other hazards,if swallowed by children.

Product Performance Failure Table

Name	Performance failure
Spectrophotometer	1.The equipment can't power on. 2.The equipment's button can't work normally. 3.Equipment screen fails to work normally. 4.Equipment lamp fails to work normally. 5.Bluetooth can't connect.