

## 产品介绍

使用产品前请仔细阅读本说明书,并妥善保管

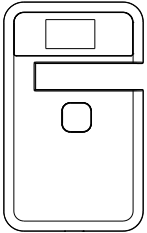
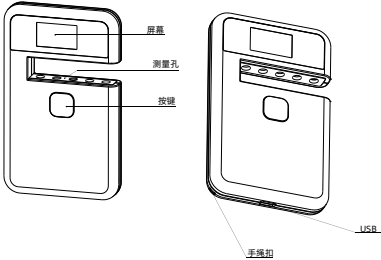

透过率计CT-25  
使用说明书

## 快速使用指南

### 1. 开机及校准

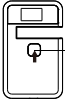

开机并自动校准

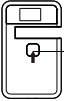

手动校准

### 2. 如何测试



放入测试样品



可暂停/开始测试

### 3. 关机

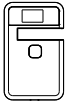

超过一分钟未使用  
自动关机

## 基本参数

产品名称:	透过率计
产品型号:	CT-25
测量结构:	透射
校 准:	手动+自动
测试指标:	紫外线 (峰值波长365nm) 可见光 (峰值波长530nm) 红外线 (峰值波长940nm) 红外线 (峰值波长1400nm) 可见光 (380nm-760nm,符合CIE明视觉函数标准)

测量精度:	±2%
分 辨 率:	0.1%
样品厚度:	13mm (max)
外形尺寸:	115* 70* 14mm
测量时间:	小于1秒
电池容量:	750mA
充电参数:	5V/1A (内置充电锂电池)
屏 幕:	全彩显示屏, 135*240, 1.14英寸
充电接口:	USB
工作温度:	0-40℃
湿 度:	小于85%, 不结露
配 件:	USB线, 挂绳, 说明书

\*参数如有修改,恕不另行通知

合格证  
已检验

## 保修说明

本产品售后服务严格依据《中华人民共和国消费者权益保护法》《中华人民共和国产品质量法》实行售后三包服务,服务内容如下:

- 1、自您签收日起7日内,本产品出现《产品性能故障表》所列性能故障的情况,经由本司售后服务中心检测确定,可免费享受退货或换货服务;
- 2、自您签收日起8-15日内,本产品出现《产品性能故障表》所列性能故障的情况,经由本司售后服务中心检测确定,可免费享受换货或维修服务;
- 3、自您签收日起12个月内,本产品出现《产品性能故障表》所列性能故障的情况,经由本司售后服务中心检测确定,可免费享受维修服务。

### 提示信息

因运输过程中需用包装箱保证产品运输安全,建议自签收日起至少保留包装箱30天。

### 非保修条例

- 1、未经授权的维修误用、碰撞、疏忽、滥用、进液、事故改动使用非本产品配件,或撕毁涂改标签防伪标记;
- 2、已超过三包有效期;
- 3、因不可抗力造成的破坏;
- 4、不符合《产品性能故障表》所列性能故障的情况;
- 5、因人为原因导致非本产品及其配件产生《产品性能故障表》所列性能故障。

## 警告

- 请勿尝试拆卸或更换仪器内部零件如需服务请联系代理商或官方客服。
- 请勿将仪器放置于热源或直接暴露于炉火旁。
- 若任何液体不小心进入仪器请立即关闭仪器电源。
- 本产品及内部零件如被儿童误食可能导致窒息等危险。

## 性能故障表

名称	性能故障
透过率计	1.仪器开关卡滞, 不能正常开关 2.仪器显示器无法正常显示

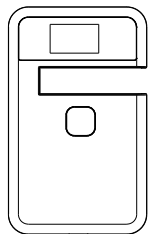

Transmittance Meter CT-25  
Operate Manual

## Product introduction

Please read this manual carefully before using the product.

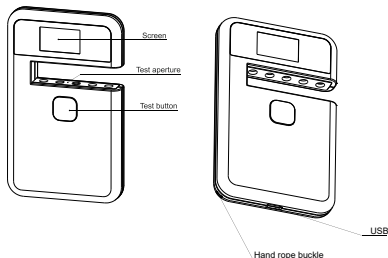

## Quick guide

### 1.Power on and calibration

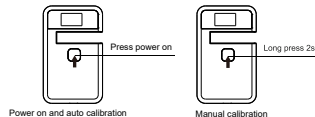

### 2. How to test

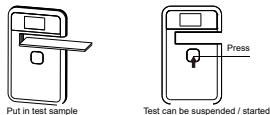

### 3.Power off



## Parameters

Product name:	Transmittance Meter
Product model:	CT-25
Measurement structure:	Transmission
Calibration:	Manual + automatic
Test index:	UV (peak wavelength365nm) Visible light (peak wavelength530nm) Infrared (peak wavelength940nm) Infrared (peak wavelength 1400nm) Visible light (380nm-760nm, conform to CIE photopic function standard)

Measurement accuracy:	±2%
Resolving power:	0.1%
Sample thickness:	13mm (max)
Dimensions:	115* 70* 14mm
Measuring time:	Less than 1 second
Battery capacity:	750mA
Charging parameters:	5V/1A (built-in rechargeable lithium battery)

Screen:	Full color display, 135*240, 1.14inch
Charging interface:	USB
Working Temperature:	0-40℃
Humidity:	Less than 85%, no condensation
Standard Accessories:	USB cable,Lanyard,operate manual

\*Parameters are subject to change without notice



## Warranty instructions

### Reminder

It is recommend that keep the packing box for at least 30 days as the packing box is required to ensure the safety of transportation.

### Non warranty regulations

- 1.Unauthorized repair,misuse,accident,modification,use of non-official accessories.
- 2.Instrument is out of warranty.
- 3.Damage caused by force.
- 4.Not the performance failure listed in the product performance failure table.
- 5.Performance failure caused by human factors.

## Warning

- Do not attempt to disassemble or replace any part of the equipment. Please contact the agent or official customer service for after sales service.
- Do not place the equipment near heat source or directly expose to the fire.
- If any liquid enters the equipment, please power off the equipment immediately.
- This product contains small parts.It may cause suffocation and other hazards,if swallowed by children,

## Product performance failure table

Name	Performance failure
Transmittance Meter	1.The instrument switch is stuck and cannot be switched normally 2.The instrument display fails to display normally