

型号 TYPE		EE16/14/5	EE16/15/7 EE16W	EE16/15/10	EE16/15/15	EE16.5/13/7	EE16.5/10/8	EE16.8/15/5	EE16.8/16/8	EE16.8/15/10	EE17/15/5	EE19/16/4.85	EE19/16/5	EE19/20/5	EE19/15/7	EE19/16/8 EE19W	EE19/16/10	EE19/16/13	EE20/17/5	EE20/21/7	EE20/13/15	EE20/15/16	
尺寸 Dimension (mm)	A(外长)	16.00±0.40	16.00±0.40	16.00±0.40	16.00±0.40	16.50±0.40	16.50±0.40	16.80±0.40	16.80±0.40	16.80±0.40	17.40±0.40	19.00±0.40	19.00±0.40	19.00±0.40	19.00±0.40	19.00±0.40	19.00±0.40	19.00±0.40	20.50±0.50	20.50±0.50	20.50±0.50	20.50±0.50	
	B(外高)	7.30±0.25	7.50±0.25	7.50±0.25	7.50±0.25	6.40±0.25	5.00±0.25	7.50±0.25	8.10±0.25	7.50±0.25	7.40±0.25	8.00±0.25	8.00±0.25	9.90±0.30	7.50±0.25	8.30±0.25	8.10±0.25	8.10±0.25	8.40±0.25	10.70±0.30	6.60±0.25	7.60±0.25	
	C(厚度)	4.80±0.20	6.80±0.25	10.00±0.30	15.00±0.30	7.20±0.25	8.10±0.25	4.80±0.20	8.00±0.20	9.80±0.30	4.80±0.20	4.85±0.20	5.00±0.20	5.00±0.25	7.30±0.25	7.80±0.25	9.50±0.30	13.00±0.30	4.90±0.20	7.00±0.25	14.80±0.30	15.70±0.30	
	D(中柱)	4.00±0.20	4.00±0.20	4.00±0.25	4.00±0.25	4.60±0.20	4.50±0.20	4.00±0.20	4.00±0.20	4.00±0.20	4.00±0.20	3.80±0.20	4.80±0.20	4.55±0.20	4.55±0.25	4.85±0.20	4.85±0.20	4.80±0.20	4.50±0.20	4.90±0.20	5.00±0.25	4.85±0.20	5.75±0.25
	E(窗口)	11.70	11.70	11.70	11.70	12.10	11.80	12.40	12.20	12.40	13.10	14.20	14.20	14.00	14.20	14.00	14.30	14.20	15.00	13.50	15.40	14.50	
	F(内高)	5.30±0.25	5.50±0.25	5.40±0.25	5.40±0.25	4.10±0.20	3.00±0.20	5.50±0.25	6.10±0.25	5.50±0.25	5.40±0.25	5.80±0.25	5.60±0.25	7.60±0.25	5.30±0.25	5.80±0.25	5.70±0.25	5.70±0.25	6.10±0.25	7.20±0.25	4.20±0.20	4.70±0.20	
磁芯常数 $C_f$ (mm <sup>-1</sup> ) Core Factor	1.94	1.40	0.95	<b>0.63</b>	<b>0.95</b>	<b>0.79</b>	<b>2.02</b>	<b>1.24</b>	<b>0.99</b>	<b>2.15</b>	1.82	1.72	2.06	1.12	1.09	0.88	0.69	1.79	1.47	0.506	<b>0.46</b>		
有效磁路长度 Le(mm) Effective length	37.20	38.00	38.00	38.00	30.20	26.00	38.80	39.40	38.80	39.20	40.00	39.80	47.6	39.6	41.2	39.7	39.7	42.2	51.5	35.4	40.8		
有效截面积 Ae (mm <sup>2</sup> ) Effective Area	19.20	27.20	40.00	60.00	31.90	33.00	19.20	31.70	39.20	18.20	21.90	23.10	23.1	35.4	37.8	44.9	57.5	23.6	35	69.9	87.9		
有效体积 Ve (mm <sup>3</sup> ) Effective Volume	714.00	1034.00	1520.00	2280.00	963.00	858.00	745.00	1250.00	1521.00	713.00	876.00	919.00	1101.8	1402	1557	1782	2283	998	1803	2470	3586		
重量 (g) Weight	3.40	5.10	7.20	11.00	4.80	4.40	3.60	6.20	7.40	3.50	4.60	4.60	5.4	6.5	7.5	9	11	4.9	9	12.9	17.2		
设计功率 (W) Design power 1KHz/0.25v	10.00	15.00	22.00	35.00	15.00	13.00	11.00	18.00	22.00	10.00	14.00	14.00	16	20	22	28	35	15	27	35	52		
电感系数 AL(nH/N <sup>2</sup> )	TP4	1100	1500	2200	3300	1900	2400	1100	1700	2200	1200	1250	1250	1150	1850	1950	2250	3100	1250	1850	4500	4700	
	TP4A	1148	1565	2296	3443	1983	2504	1148	1774	2296	1252	1304	1304	1200	1930	2035	2348	3235	1304	1930	4696	4904	
	TP47	1196	1630	2391	3587	2065	2609	1196	1848	2391	1304	1359	1359	1250	2011	2120	2446	3370	1359	2011	4891	5109	
	TP95	1578	2152	3157	4735	2726	3443	1578	2439	3157	1722	1793	1793	1650	2654	2798	3228	4448	1793	2654	6457	6743	

特点：引线空间大，绕制接线方便。适用范围广、工作频率高、工作电压范围宽、输出功率大、热稳定性好。  
用途：广泛应用于程控交换机电源、液晶显示屏电源、大功率UPS逆变器电源、计算机电源、节能灯等领域。

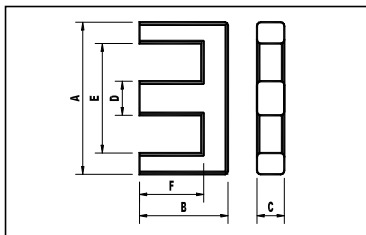

注：AL值测试条件为1KHz, 0.25v, 11

EE21/43/3	EE21/20/7	EE22/44/5	EE22/19/6	EE23/19/6	EE23/18/9	EE24/35/6	EE24/19/8	EE24.5/18/9.4	EE25/20/9	EE25/19/11	EE25/16/15	EE25.4/20/6	EE25.4/29/6	EE25.4/6/6	EE25.4/20/6.7	EE25.4/20/10	EE25.4/20/12.5 EE25W	EE27/31/10	EE27/20/13	EE28/21/11	EE30/30/6	EE30/26/8	EE30/26/11	EE30/42/11	
21.00±0.50	21.00±0.50	22.40±0.50	22.40±0.50	22.80±0.50	23.00±0.50	24.00±0.50	24.00±0.50	24.50±0.50	25.00±0.60	25.00±0.50	25.00±0.60	25.40±0.60	25.40±0.60	25.40±0.60	25.40±0.60	25.40±0.60	25.40±0.60	27.00±0.60	27.40±0.60	28.40±0.60	30.00±0.60	30.00±0.60	30.00±0.60	30.00±0.60	
21.60±0.40	10.10±0.30	22.20±0.40	9.40±0.30	9.30±0.30	9.00±0.30	17.70±0.30	9.60±0.30	9.00±0.30	10.20±0.30	9.30±0.30	8.00±0.30	10.00±0.30	14.50±0.30	32.95±0.40	10.00±0.30	9.90±0.30	9.90±0.30	15.40±0.30	9.90±0.30	10.80±0.30	15.25±0.30	13.20±0.30	13.30±0.30	21.25±0.40	
3.20±0.20	6.80±0.25	4.70±0.30	5.75±0.25	5.75±0.25	9.15±0.30	6.00±0.25	7.70±0.25	9.40±0.30	8.85±0.25	10.75±0.30	15.00±0.30	6.35±0.25	6.35±0.25	6.35±0.25	6.70±0.25	10.00±0.30	12.50±0.30	10.50±0.30	12.65±0.30	10.60±0.30	6.35±0.25	8.10±0.25	10.70±0.30	10.70±0.30	
5.00±0.25	4.70±0.20	5.80±0.25	5.75±0.25	5.75±0.25	6.50±0.25	6.00±0.25	6.50±0.25	6.30±0.25	7.25±0.25	7.25±0.25	7.50±0.25	6.35±0.25	6.35±0.25	6.35±0.25	6.35±0.25	6.35±0.25	6.35±0.25	7.80±0.25	6.35±0.25	7.20±0.25	10.70±0.30	10.70±0.30	10.70±0.30	10.70±0.30	
14.50	14.80	15.70	15.70	16.60	16.10	17.50	16.40	18.00	17.50	17.70	17.80	18.60	18.80	19.00	18.60	18.50	18.50	19.40	20.55	18.90	19.80	19.80	19.80	19.80	19.80
18.40±0.35	7.00±0.25	18.30±0.30	5.40±0.25	5.60±0.25	5.60±0.25	14.60±0.30	6.20±0.25	6.00±0.25	6.60±0.25	5.80±0.25	4.55±0.20	6.80±0.25	11.30±0.30	29.80±0.40	6.90±0.25	6.90±0.25	6.70±0.25	11.40±0.30	6.85±0.25	6.60±0.25	10.35±0.30	8.20±0.25	8.30±0.25	16.30±0.30	
<b>6</b>	1.26	<b>3.57</b>	1.23	1.22	0.68	<b>2.207</b>	0.9	0.804	<b>0.775</b>	0.614	0.38	1.22	1.69	3.53	1.14	<b>0.8</b>	<b>0.639</b>	0.87	<b>0.66</b>	0.64	<b>1.042</b>	<b>0.715</b>	<b>0.541</b>	<b>0.84</b>	
96	46.9	97.6	42.8	43.55	42.8	<b>79.97</b>	45	45.8	<b>48.5</b>	45.2	42.5	49.8	67.96	141.8	49	<b>50.1</b>	<b>50.2</b>	69.5	<b>51.9</b>	49.3	<b>66.6</b>	<b>58.1</b>	<b>58.1</b>	<b>90.4</b>	
16	37.3	27.3	34.9	34.90	62.8	<b>36.24</b>	50	56.9	<b>62.6</b>	73.5	112.5	40.16	40.16	40.16	43	<b>62.59</b>	<b>78.5</b>	79.8	<b>77.2</b>	76.32	<b>63.9</b>	<b>81.3</b>	<b>107.4</b>	<b>107.6</b>	
1536	1747	2664	1490	1518.00	2688	<b>2898</b>	2250	2610	<b>3039</b>	3320	4781	2040	2730	5623	2107	<b>3133.4</b>	<b>3939</b>	5556	<b>4102</b>	4717	<b>4254</b>	<b>4727</b>	<b>6244</b>	<b>9732</b>	
7.4	8.3	13.2	8.3	8.30	12.9	<b>14.4</b>	11.8	13.2	<b>15</b>	15.9	23	9.8	13.6	27.1	10	<b>15.6</b>	<b>19.9</b>	27.9	<b>20.6</b>	22.5	<b>22</b>	<b>24.5</b>	<b>32.4</b>	<b>49</b>	
22	27	37	25	25	40	43	36	40	45	48	70	29	42	80	30	48	60	85	63	68	65	75	95	150	
480	1600	720	1750	1900	3100	950	2250	2550	2750	2950	5500	1800	1560	620	1800	2750	<b>3450</b>	2500	<b>3380</b>	3400	<b>2050</b>	<b>3000</b>	<b>3900</b>	<b>2450</b>	
501	1670	751	1826	1983	3235	991	2348	2661	2870	3078	5739	1878	1628	647	1878	2870	3600	2609	3527	3548	2139	3130	4070	2557	
522	1739	783	1902	2065	3370	1033	2446	2772	2989	3207	5978	1957	1696	674	1957	2989	3750	2717	3674	3696	2228	3261	4239	2663	
689	2296	1033	2511	2726	4448	1363	3228	3659	3946	4233	7891	2583	2238	890	2583	3946	4950	3587	4850	4878	2941	4304	5596	3515	

EE31/26/9	EE31/37/9	EE32/32/9	EE32/32/11	EE32/28/13	EE32/13/20	EE32/26/11	EE33/30/13	EE34/20/0	EE34/29/10	EE35/29/9	EE35/35/10	EE35/28/12	EE35/22/15	EE35/22/30	EE40/35/12	EE41/33/13	EE41/17/21	EE42/42/15	EE42/48/15	EE42/30/20	EE42/42/20	EE43/42/15	EE43/19/28	EE47/16/17	EE47/39/16
30.70±0.60	30.70±0.60	32.00±0.80	32.00±0.80	32.00±0.80	32.50±0.80	33.00±0.80	34.00±0.80	34.20±0.80	35.00±0.80	35.00±0.80	35.00±0.80	35.00±0.80	35.00±0.80	35.00±0.80	40.00±0.80	40.60±0.80	41.00±1.00	42.00±1.00	42.00±1.00	42.00±1.00	42.20±1.00	43.50±1.00	43.50±1.00	47.00±1.20	47.00±1.20
13.20±0.30	18.50±0.30	16.10±0.30	16.10±0.30	14.00±0.30	6.35±0.25	13.30±0.30	15.15±0.30	10.40±0.30	14.40±0.30	14.60±0.30	17.70±0.30	13.90±0.30	11.20±0.30	11.20±0.30	17.50±0.30	16.60±0.30	8.50±0.25	21.20±0.40	24.10±0.40	15.30±0.40	21.20±0.40	21.20±0.40	9.50±0.30	8.10±0.30	19.50±0.40
9.40±0.30	9.40±0.30	9.20±0.30	10.80±0.35	12.90±0.30	20.35±0.40	10.75±0.30	12.80±0.30	9.90±0.30	9.90±0.30	9.20±0.30	10.00±0.30	12.00±0.30	15.00±0.30	30.00±0.40	11.70±0.30	12.50±0.30	21.00±0.40	15.00±0.30	15.00±0.30	19.70±0.40	19.70±0.40	15.00±0.30	27.90±0.50	17.00±0.40	15.65±0.30
9.40±0.30	9.40±0.30	9.20±0.30	9.20±0.30	8.90±0.30	6.35±0.25	10.75±0.30	9.70±0.30	7.80±0.25	9.80±0.30	9.20±0.30	10.00±0.30	9.20±0.30	10.00±0.30	10.00±0.30	11.70±0.30	12.55±0.30	5.00±0.25	12.00±0.30	12.00±0.30	12.00±0.30	12.00±0.30	12.50±0.30	8.10±0.25	6.40±0.25	15.60±0.30
21.60	21.60	22.40	23.00	22.70	24.90	22.00	24.80	25.10	24.50	24.80	24.50	25.60	24.50	24.50	27.60	28.60	35.50	29.50	29.50	29.50	29.50	29.50	34.70	40.50	31.70
8.70±0.30	14.00±0.30	11.80±0.30	11.60±0.30	9.60±0.30	3.20±0.20	8.40±0.30	10.40±0.30	6.40±0.25	9.60±0.30	9.80±0.30	12.70±0.30	9.95±0.30	6.20±0.25	6.20±0.25	10.50±0.30	10.60±0.30	5.00±0.25	15.30±0.30	18.35±0.35	9.40±0.30	15.30±0.30	14.80±0.30	5.40±0.20	5.10±0.20	12.20±0.30
<b>0.733</b>	1	<b>0.916</b>	<b>0.776</b>	0.59	0.33	0.55931	0.64	<b>0.703</b>	0.7273	0.8	0.808	0.69	<b>0.37</b>	<b>0.19</b>	0.54728	0.52	0.47878	0.55	0.62051	0.32	0.41576	0.55	0.27	0.66	0.39
<b>61.6</b>	83	<b>74.7</b>	<b>74.7</b>	66.6	41.8	61.119	71.1	<b>55.8</b>	68.557	70.2	80.7	70	<b>55.5</b>	<b>55.5</b>	78.832	77.7	58.976	97.9	110.17	74.5	98.081	97.1	61.3	64.35	88.8
<b>84</b>	82.9	<b>81.6</b>	<b>96.28</b>	113.3	128.3	109.28	110	<b>79.8</b>	94.26	87.69	99.9	100	<b>150</b>	<b>300</b>	144.04	150	123.18	178	235	235.91	178	224.2	96.8	229	
<b>5176</b>	6880	<b>6093</b>	<b>7192</b>	7554	5361	6679.1	7821	<b>4429</b>	6462.2	6455.4	8060	7120	<b>8326</b>	<b>16652</b>	11355	11600	7264.7	17426	19560.7	17507	23138.3	17280	13749	6230	20300
<b>26.5</b>	34	<b>33</b>	<b>38.5</b>	38.5	27	35	40	<b>22</b>	32.5	30.8	40	36.6	<b>43.6</b>	<b>87</b>	60	58.8	35.5	88	<b>98</b>	88	116	88.2	60	31.8	104
<b>80</b>	100	100	115	115	80	105	120	<b>66</b>	100	92	120	110	<b>130</b>	<b>260</b>	180	190	105	265	300	265	350	265	180	95	310
<b>2900</b>	2250	<b>2400</b>	<b>2750</b>	5600	6400	4000	3700	<b>2900</b>	3100	2700	2800	3300	<b>7000</b>	<b>12500</b>	4520	4300	4500	4050	<b>3950</b>	6900	5300	4200	8500	3370	7200
3026	2348	2504	2870	5843	6678	4174	3861	3026	3235	2817	2922	3443	7304	13043	4717	4487	4696	4226	4122	7200	5530	4383	8870	3517	7513
3152	2446	2609	2989	6087	6957	4348	4022	3152	3370	2935	3043	3587	7609	13587	4913	4674	4891	4402	4293	7500	5761	4565	9239	3663	7826
4161	3228	3443	3946	8035	9183	5739	5309	4161	4448	3874	4017	4735	10043	17935	6485	6170	6457	5811	5667	9900	7604	6026	12196	4835	10330

EE55/56/17	EE55/56/21	EE55/56/25	EE56/47/19	EE59/56/25	EE65/65/20	EE65/65/27	EE65/65/28	EE70/71/25	EE70/66/31	EE70/66/32	EE70/66/35	EE73/70/32	EE80/77/20	EE85/88/27	EE85/88/32	EE100/120/28	EE110/112/36	EE196/152/30
55.00±1.20	55.00±1.20	55.00±1.20	56.10±1.20	59.00±1.20	65.00±1.50	65.00±1.50	65.00±1.50	70.50±1.50	70.50±1.50	70.50±1.50	70.50±1.50	73.00±2.00	80.00±2.00	85.00±2.00	85.00±2.00	100.00±2.50	110.00±2.50	196.00±4.00
28.00±0.40	28.00±0.40	28.00±0.40	23.40±0.40	27.80±0.40	32.50±0.40	32.50±0.40	32.50±0.40	35.50±0.40	33.20±0.40	33.20±0.40	33.20±0.40	35.00±0.50	38.50±1.00	44.00±1.00	44.00±1.00	60.00±1.00	56.00±1.00	76.00±2.00
16.80±0.40	20.60±0.40	24.60±0.40	18.80±0.35	24.60±0.40	20.00±0.40	26.90±0.50	28.00±0.50	24.50±0.40	30.50±0.50	31.60±0.50	35.40±0.50	31.50±0.60	20.00±0.50	26.90±0.60	31.50±1.00	28.00±0.80	36.00±1.00	30.00±0.80
16.95±0.30	16.95±0.30	16.95±0.30	18.80±0.30	16.80±0.30	19.65±0.40	19.50±0.40	19.60±0.40	16.70±0.30	21.50±0.40	21.60±0.40	21.60±0.40	21.50±0.40	20.00±0.40	26.90±0.60	26.90±0.60	28.00±0.80	36.00±1.00	56.00±1.50
37.50	37.50	37.50	37.80	41.50	44.2	43.30	45.0	48.00	48.00	48.00	48.00	50.00	60.50	55.00	55.00	71.00	74.2	136.00
18.90±0.40	18.90±0.40	18.90±0.40	14.60±0.35	19.30±0.40	22.60±0.40	22.60±0.40	23.00±0.40	24.15±0.40	22.20±0.40	22.55±0.40	22.55±0.40	24.30±0.40	28.00±0.50	29.20±0.50	29.20±0.50	46.50±1.00	37.70±1.00	48.00±1.00
0.44	<b>0.35</b>	0.29	0.32	0.31	0.37	0.28	0.27	0.35	<b>0.248</b>	<b>0.24</b>	<b>0.198</b>	0.24	0.46	<b>0.254</b>	<b>0.207</b>	<b>0.375</b>	<b>0.194</b>	<b>0.217</b>
<b>124</b>	<b>124</b>	124	106	129	147	147	147	162	<b>142.3</b>	<b>142.3</b>	<b>142.3</b>	160.4	184	<b>191.5</b>	<b>188.9</b>	<b>272</b>	<b>246.9</b>	<b>364</b>
284	<b>353</b>	423	337	414	393	524	548.8	464	<b>574.4</b>	<b>595</b>	<b>763</b>	667.6	399	<b>742.7</b>	<b>912.3</b>	<b>760</b>	<b>1271.9</b>	<b>1680</b>
35216	<b>44000</b>	52029	35800	53406	57771	77028	80674	75168	<b>81765</b>	<b>84720</b>	<b>108575</b>	107120	73416	<b>144136</b>	<b>172315</b>	<b>206422</b>	<b>314102</b>	<b>611496</b>
178	<b>218</b>	265	181	269	298	401	415	383	<b>500</b>	<b>518</b>	<b>587</b>	530	378	<b>724</b>	<b>844</b>	<b>1030</b>	<b>1540</b>	<b>3050</b>
530	650	770	550	800	900	1200	1250	1150	1500	1550	1750	1600	1150	2150	2500	<b>3100</b>	<b>4600</b>	<b>9000</b>
5250	<b>6500</b>	7200	8000	7150	5950	8000	8200	6500	8000	8500	9550	8800	4800	9000	<b>10500</b>	8200	<b>11000</b>	<b>10000</b>
5478	6783	7513	8348	7461	6209	8348	8557	6783	8348	8870	9965	9183	5009	9391	10957	8557	11478	10435
5707	7065	7826	8696	7772	6467	8696	8913	7065	8696	9239	10380	9565	5217	9783	11413	8913	11957	10870
7533	9326	10330	11478	10259	8537	11478	11765	9326	11478	12196	13702	12626	6887	12913	15065	11765	15783	14348