

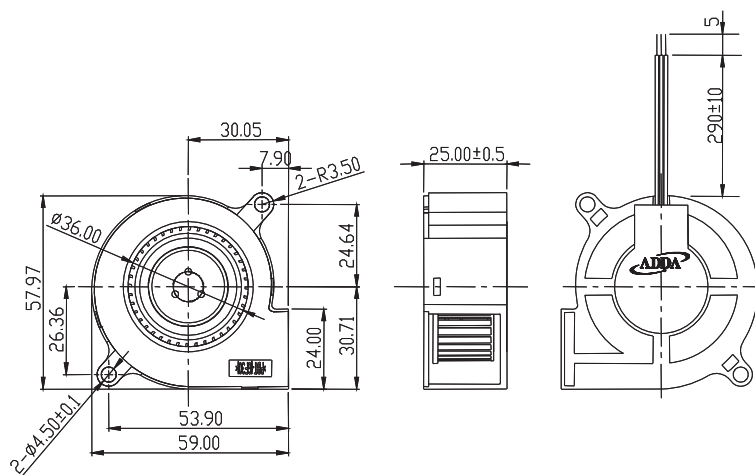

AB6025 SERIES

External Dimensions



Frame: Plastic(UL:94V-0)
Impeller: Plastic(UL:94V-0)
Lead wire: UL1007AWG24

Specifications(Nominal)

*: Noise is measured at the distance of one (1) meter from the axis of intake.

Bearing type: ◎=Ball ※=Sleeve ●=Hypro bearing

Frame size (mm)	Model No.	Bearing System Type	Rated Voltage (VDC)	Current (A)	Power (W)	Rated Speed (rpm)	Maximum AirFlow (CMM) (CFM)	Maximum Pressure (InAq) (mmAq)	*Noise Level (dB/A)	Weight (g)
60x60x25	AB06012DB250300	◎	12	0.05	0.60	2300	0.122 4.30	0.160 4.06	21.5	45.6
	AB06012LB250300	◎	12	0.09	1.03	2800	0.150 5.30	0.290 7.37	28.5	
	AB06012MB250300	◎	12	0.13	1.50	3300	0.178 6.30	0.380 9.65	34.5	

Specifications subject to change without notice.

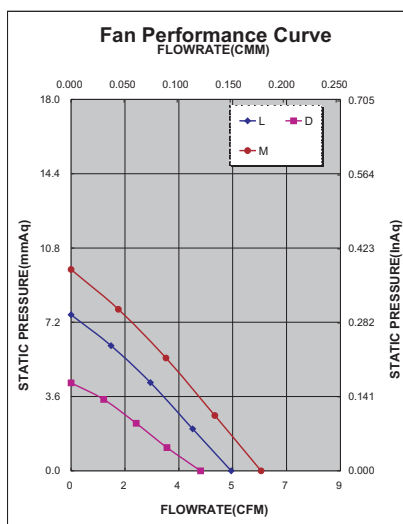

*Motor protective circuit and third lead wire functions

0	1	2	3	4	6	7	8	9	A	B
	✓		✓							

*Safety approvals

UL®	UL®	SP®	UL®	CE
✓	✓		✓	✓