

EWCONNECTOR
 TEL:+86-755-33514075
 FAX:+86-755-22142154
 http://www.ewconn.com

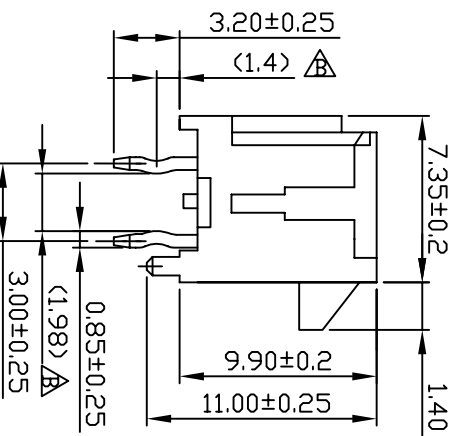
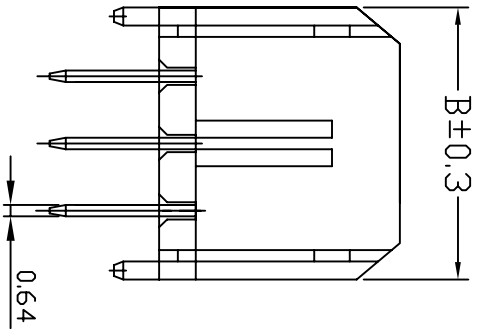
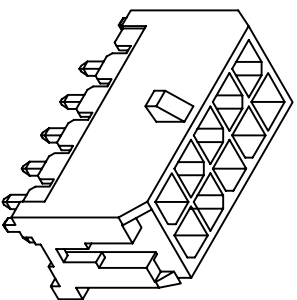
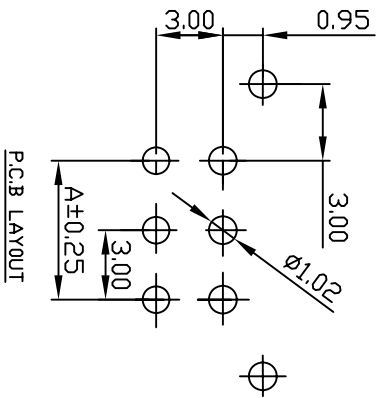
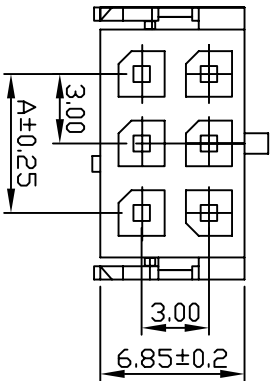

SPECIFICATIONS

Current rating: 5A AC, DC
 Voltage rating: 250V AC, DC
 Temperature range: -40°C ~ +105°C
 Insulation resistance: 1000MΩ/min.
 Withstanding voltage: 1500V AC/ minute.
 Contact resistance: 20mΩ/ max.
 MATERIAL: NYLON46 UL94V-0
 Pin: Brass/Tin-Plated
 SUITABLE KR3000HF SERIES Housing
 MOQ:1,000PCS

REV	MODIFICATION	DATE	DRAW	APPROVE
B	增加打 位尺寸要求	09.24	EDWIN	

PART NO.	Dimension mm	
	A	B
C3000VD20130P440	----	6.65
C3000VD20230P440	3.0	9.65
C3000VD20330P440	6.0	12.65
C3000VD20430P440	9.0	15.65
C3000VD20530P440	12.0	18.65
C3000VD20630P440	15.0	21.65
C3000VD20730P440	18.0	24.65
C3000VD20830P440	21.0	27.65
C3000VD20930P440	24.0	30.65
C3000VD21030P440	27.0	33.65
C3000VD21130P440	30.0	36.65
C3000VD21230P440	33.0	39.65

EWCONNECTOR

E-World Electronic Industry Ltd

.0	±0.25	MX3.0 DIP Dual Row Vertical Wafer
.00	±0.15	
.000	±0.08	
P/N:EWWB3001-WR-2*XP		

Drawn by:	Revised by:	Approved by:
EDWIN		
Date: 2009-12-14	Date:	Date:

3RD ANGLE'S	UNIT	m/m	SCALE	NONE	REV.	B	DRAWING NO:	30003120013
-------------	------	-----	-------	------	------	---	-------------	-------------

1 2 3 4 5 6 7 8 9