

 **FB-1**

*3D Filament Auto Feeder  
(3DFilament Buffer)*

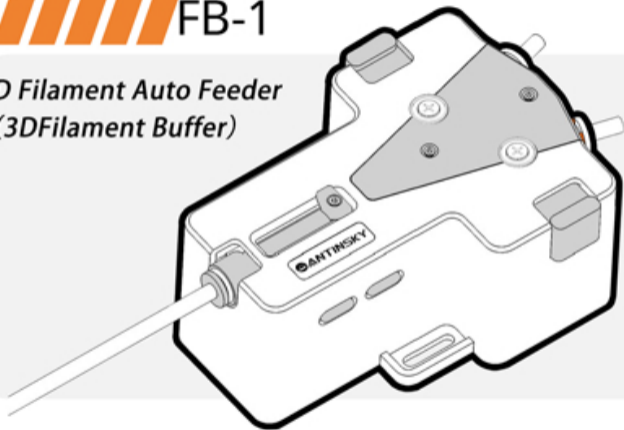

**USER MANUAL**

## 1 BEFORE USING

- Before using the product, please carefully read this manual and keep it properly.
- This product is used for 3D printer filament buffer and continuation.
- When not using the product, please disconnect the power.
- If product fails, please contact the dealer for maintenance and do not attempt to repair it yourself.
- Please note that the pictures and instructions in this user manual may differ from the actual product.
- The content and pictures involved in this manual may be modified without notifying users.

## 2 PRODUCT PARAMETER

Product Name	3D Filament Auto Feeder	Product Size	110×75×46mm
Model	FB-1	Package Size	204×155×64mm
Input	DC5V 2A	Net Weight	160g
Rated Power	5W	Total Weight	290g
Filament	Φ1.75±0.05mm		
Filament	Suitable for hard filaments such as PLA, ABS, PETG, PA NOT suitable for flexible filaments like TPU		
Teflon Tube	Φ4×2mm or Φ4×2.2mm. It is not recommended for Φ4×3mm		

### 3 PART LIST



① Main Unit × 1



② USB Cable × 1



③ Velcro Strap × 1



④ Teflon Tube × 1

### 4 PRODUCT OVERVIEW



## 5 INSTALLATION STEP

### Step.1

Mount the product to the printer.  
You can secure it using the Velcro strap included in the accessory package or with the other screws.

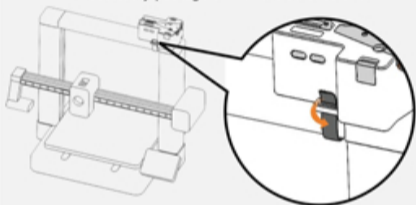

Note: Avoid installing on the moving surface of the printer to prevent collision during printing

### Step.2

Connect the product to the printer using the Teflon tube.  
Make sure there is enough tubing length.

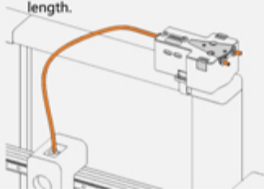

### Step.4

For continuous printing,  
insert the filament into  
the other port. It will  
automatically advance a  
short distance.

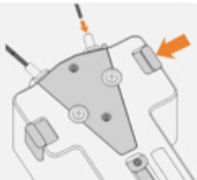

Note: When one of the filament is exhausted, the other filament will be automatically executed after 50s ( can be modified ) ,Do not operate manually while waiting.

### Step.3

Install the filament:  
Connect the USB to a DC5V adapter.

Press the slider and feed the filament simultaneously; the filament will automatically grip and feed through.

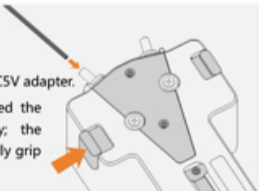

## 6 TIPS

### Filament Unloading

**Automatic Unloading :** During Printer unloading, the tube fully extends. Press the Unload Button to retract the filament.

**Manual Unloading (For Errors):** If the tube isn't fully extended, push it manually and press the Unload Button to retract the filament.

**After Unloading :** The device enters standby. Press the Load Button to resume feeding.



According to the actual situation of the printer to choose the filament port vertical cutting or bevel cutting:

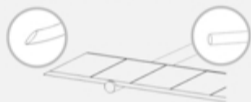

The vertical cutting will be more conducive to avoiding the alarm of the integrated cut-off sensor during the replenishment.

The bevel cutting is more conducive to allowing filament to pass into the extruder

During power recycling with dual filament loaded, the system prioritizes the left port as primary feed. Always use the left port as main feed channel.



### Cleaning and Maintenance

Regularly clean debris from the gear area: Remove the two screws on the panel and use a brush to clear away any debris.

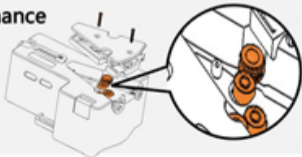

- RED LIGHT - 10s
- BLUE LIGHT - 50s
- R&B LIGHT - 90s



Press the feed and return buttons simultaneously for 5 seconds to switch the refill time.



Xiamen Antinsky Industry Co., Ltd.

[www.antinsky3d.com](http://www.antinsky3d.com)

[service@antinsky.com](mailto:service@antinsky.com)