

Independent
Development

MV-UBS130GM

USB2.0 has a simple structure, a variety of single-board modules, small size, which can effectively save product size, and is suitable for small instruments and small devices; no external power supply is required, easy to use, and high performance price ratio.

Application Industry :

It is suitable for factory automation, college experiments, logistics code scanning, package printing and textiles.



Product Features :

- USB2.0 interface, no need for external power supply, plug and play.
- Support 8bit to 12bit raw data output.
- Support external trigger, strobe synchronization.
- Support Windows, Linux and ARM Linux, Android system.
- With hardware frame buffer, support more than 32 cameras working at the same time.
- Custom data can be written in the camera.

Spectral Response Curve :

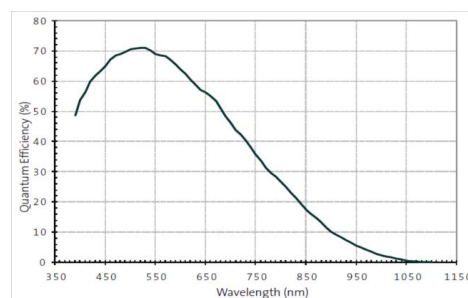

MV-UBS130GM

Mechanical Specifications :

unit:mm

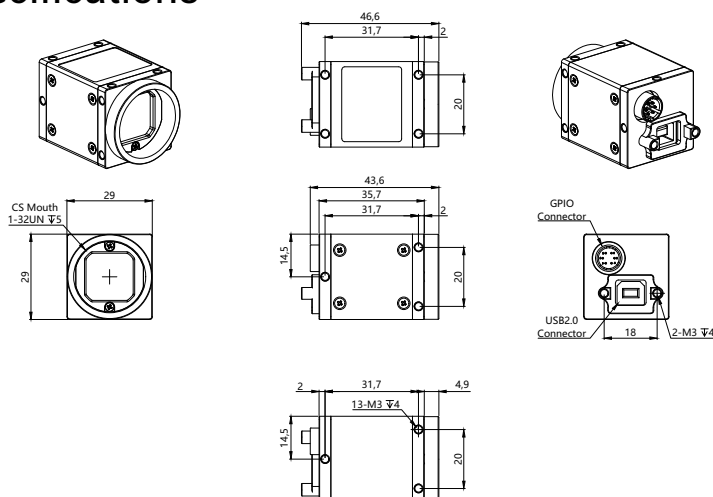

MV-UBS130GM-T

TECHNICAL PARAMETER

Specifications	Model	MV-UBS130GM
Sensor		1/3" CMOS
Sensor type		AR0135
Camera type		Mono
Pixel size		3.75umx3.75um
Effective pixels		1.2MP
Resolution @ frame rate		1280x960MAX@39fps
Exposure mode		Frame exposure
Sensitivity		85ke-/lux*sec @670nm
Signal to noise ratio		40.7dB
Dynamic range		71.1dB
GPIO		1way optically isolated input, 2 way optically isolated output
Output pixel width		12bit
AD width		12bit
Frame buffer		32MB
Exposure time range		0.019~18.2ms
Maximum gain (multiple)		4
User EEPROM		2KB
Video output format		Mono 8/12bit
Lens interface		C/CS port, providing adapter rings
Data interface		USB2. 0
Power supply		5V
Power		<2W
Boundary dimension		29(mm)X29(mm)X35.7(mm)(Lens base and rear shell interface are not included)
Weight		<75g
Working temperature		0~50°C
Working humidity		20~80%(No Condensation)
Storage temperature		-30~60°C
Storage humidity		20~95%(No Condensation)
Operating system		WINXP, WIN7 / 8/10 32 & 64-bit systems, Linux and ARM Linux drivers (customizable), Android platform drivers (customizable)
Drive program		DirectShow components Halcon special components Labview dedicated drive OCX components TWAIN components
Programming language		C/C++/C#/VB6/VB.NET/Delphi/BCB/Python/Java
Other functions		Support any size ROI custom resolution, contrast and gamma adjustment, saturation adjustment, white balance correction, black level correction, custom dead point coordinate correction,ISP image processing acceleration, 3D noise reduction, custom LUT table, frame rate adjustment, custom camera name, etc.

www.mindvision.com.cn



☎ 400 Tel:400-828-4478

✉ E-mail(Sales Department):sales@mindvision.com.cn

✉ E-mail(Technical Department):support@mindvision.com.cn

- 📍 South China Company: 5th Floor, Building 6, Chiayiyuan Science and Technology Park, Huaning Road, Longhua New District, Shenzhen
- 📍 Central China Company: Building 5D, Yida Chuangzhi Island, Dangui Road, Wangcheng Economic Development Zone, Changsha City
- 📍 East China Company: 9th Floor, Jizhi Business Plaza, Erquan East Road, Xishan District, Wuxi City, Jiangsu Province

-T Line Sequence Definition

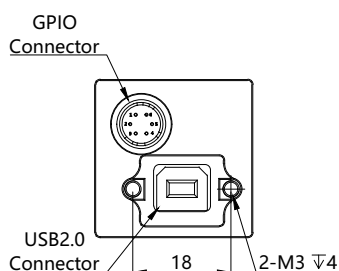

Port	Pin Number	Line Color	Signal Name	Signal Specification	Remark
Port A	1	Green	GP01+/STRB_OUT+	GP01 positive terminal/Strobe output positive terminal	Default is strobe output
	2	Yellow	GP01-/STRB_OUT-	GP01 negative terminal/Strobe output negative terminal	Default is strobe output
	3	White	GP11-/TRIG_IN+	GP11 positive terminal/Trigger input positive terminal	Default is trigger input
	4	Brown	GP11-/TRIG_IN-	GP11 negative terminal/Trigger input negative terminal	Default is trigger input
	5	Red	GP02+	GP02 positive terminal output	
	6	Black	GP02-	GP02 negative terminal output	

www.mindvision.com.cn



☎ 400 Tel:400-828-4478

✉ E-mail(Sales Department):sales@mindvision.com.cn

✉ E-mail(Technical Department):support@mindvision.com.cn

📍 South China Company: 5th Floor, Building 6, Chiayi Yuan Science and Technology Park, Huaning Road, Longhua New District, Shenzhen
 📍 Central China Company: Building 5D, Yida Chuangzhi Island, Dangui Road, Wangcheng Economic Development Zone, Changsha City
 📍 East China Company: 9th Floor, Jizhi Business Plaza, Erquan East Road, Xishan District, Wuxi City, Jiangsu Province