

*ADSW Single-Stage Single-Suction
Horizontal Centrifugal Pump*
ADSW型单级单吸卧式离心泵

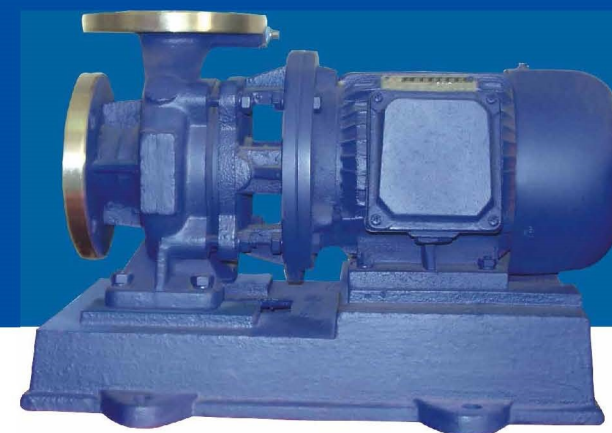

◇由于产品技术不断进步，艾德森集团保留修改设计的权利，恕不另行通知。ADSW1811
Due to constantly progressive technology ,Aidesen Group has the right to amend the design,without prior notice. ADS1811

南京艾德森水务有限公司

地址：南京市六合区雄州工业园陈吕路 8 号
邮编：211500
电话：025-57755199
传真：025-57750693
网址：www.lanshengroup.cn



南京艾德森水务有限公司



南京艾德森水务有限公司坐落于茉莉花的故乡南京六合雄州工业园，区位优势、交通便捷，景色怡人。南京艾德森水务有限公司依托国家环保骨干企业、国家级高新技术企业蓝深集团的先进管理模式、先进技术及工艺装备以及不断创新的精神，为产品开发设计、生产制造、质量控制、快速服务提供了强有力的保障。

南京艾德森水务有限公司是专业致力于环保文化，技术开发，集科研、设计、生产、内外销售、服务于一身。专业从事各类水泵、环保设备污水处理设备生产与销售。公司本着以质量求生存，以诚信求发展，以服务创效益为理念，为人类环境、水资源一直不懈努力……

Nanjing Aidesen Water Service Co., Ltd locates in Liuhe Xiongzhou Industrial Park in Nanjing, the hometown of jasmine flower where has pleasant scene; with excellent location, its traffic is convenient and fast. Advanced management modes, technologies and technological equipment, and spirit of continuous innovation from LANSHEN Group, the key enterprises on environmental protection and new high-tech enterprise in national level, provide strong guarantee for Nanjing Aidesen Water Service Co., Ltd on product development and design, manufacturing, quality monitoring and quick service.

Nanjing Aidesen Water Service Co., Ltd. devotes itself to environmental protection and technological development; it combines scientific research, design, production, sales and services together, professional engaging in production and sales of various water pumps, environmental protection equipment for sewage treatment. Striving for survival on the basis of quality and realizing development on the basis of reputation, company adopts the idea of creating benefit based on services, and makes unremitting endeavor to protect human environment and water resources.

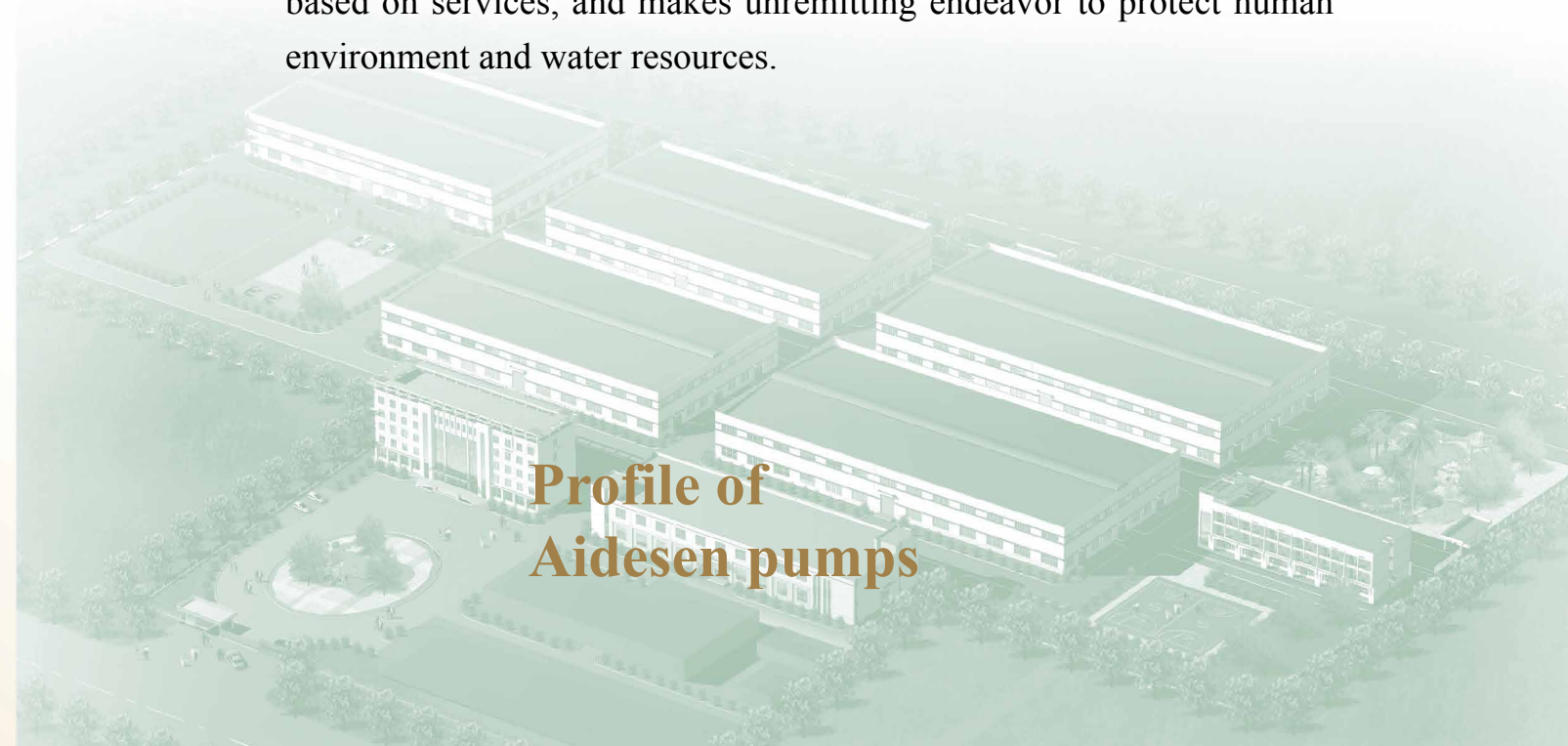

**Profile of
Aidesen pumps**

ADSW、ADSWR、ADSWH ADSWD 型泵主要性能参数与安装尺寸表
ADSW、ADSWR、ADSWH、ADSWD Houizontal Centrifugal Pump

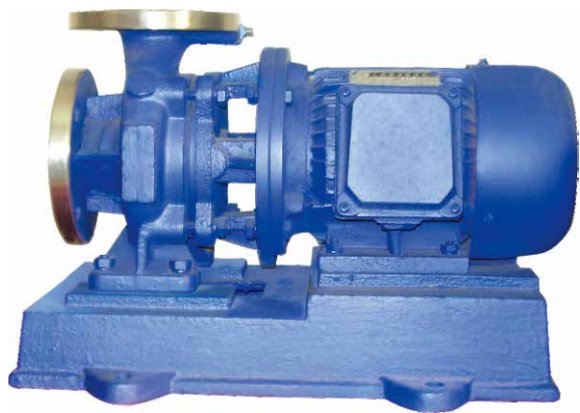

产品概述
OVERVIEW OF PRODUCT

ADSWR、ADSWH、ADSWD 系列单级单吸卧式离心泵是在参照本公司 ADS 系列立式离心泵基础上改进设计而成，其性能参数等同于 IS 系列泵，并符合 IS02858 要求，产品严格按有关要求组织生产，产品质量稳定，性能可靠，是代替 IS 型卧式泵、DL 型泵等常规产的新颖卧式离心泵。

流量范围: 1.5 ~ 1200m³/h, 扬程范围 8 ~ 150m, 分基本型、扩流型、A、B、C 切割型等 250 多种规格。根据流体介质和温度不同，设计制造成同性能参数的 ADSWR 型热水泵、ADSWH 型化工泵、ADSWD 低转速泵系列产品。

ADSW、ADSWR、ADSWH、ADSWD series single-stage single-suction horizontal-type centrifugal pumps are made by way of improving the edsing ofLS series vertical centrifugal pumps ofthis Co.with the performance parameters isentical to those ofIS series and in line with the requirements of IS02858.The preoeducts are preoduced strictly according to the relevant requirements,so they have a stable quality and reliable performance and are the brand-new ones instead ofmodel IS horizontal pump,model DL pump etc.ordinary pumps

They are divided into basic type,flow-expansion type A、B、Ccuttingtype etc. in more than 250 specifications and with a flow reange of 1.5~1200m³/h and a head range of 8~150m.And,per the different fluid media and temperatures,model WDSR hot-waterpump,moedIWDSHchemical pump,model ADSWD low speed pump etc. Series products are designed and manufactured and have the same performance parameters

产品特点
FEATURES OF PRODUCT

- 1、结构紧凑。该系列泵为卧式结构，机泵一体，外形美观，占地面积少，与普通卧式泵比较占地面积减少30%。
- 2、运行平稳、噪音低、组件同心度高。电机和泵直联，简化了中间结构，增强了运行的平稳性，叶轮具有良好的动静平衡，运行时无振动，改善了使用环境。
- 3、无渗漏。轴封采用耐磨硬质合金机械密封，解决了离心泵填料严重渗漏的问题，确保了运行场地干净整洁。
- 4、维修方便。该系列卧式泵为后开门式结构，无须拆卸管路，即可进行检修。

- 1.Compact structure.These series pumps have an integrally horizontal structure,beaustiful appearance and less area of occupied land,which,comparing with the ordinary ones,is reduced by 30%.
- 2.Stable running,low noise,high cincentricity of assembly.By the straight joint between the motor and the pump, the middle structure is made simpli-fied,thus enhancing the running stability,making the impeller of a good baiance of moving -resting,resulting in no vibration during running and improving the environment of use.
- 3.No leakage.Amechanical seal of antisepticcarbide alloy is used for the shaft sealing so as to get rid of the serious leakage of the fillings of centrifugal pumps and ensure the operating place clean and neat.
- 4.Convenient service.Service can be easily done without removing any pipeline because of the back -door structure.

主要用途
MAJOR PURPOSE

- 1、ADSW 型卧式离心泵，供输送清水及物理性质类似清水的其它液体之用。使用介质温度80℃以下。适用于工业和城市给排水、高层建筑增压送水、园林喷灌、消防增压、远距离输水、采暖、浴室冷暖气循环增压及设备配套等。
- 2、ADSWR 型卧式热水泵，适用于有供热系统的民用及企事业单位的建筑住房供暖及热水增压、循环、输送等生产工艺用热系统，如：电站、热电站、余热利用、冶金、化工、纺织、木材加工、造纸等工业锅炉高温热水，使用温度120℃以下。
- 3、ADSWH 型卧式化工泵，输送不含固体是颗粒具有腐蚀性其粘度似水的液体。适用于轻纺、石油、化工、冶金、电力、造纸、食品、制药和合成纤维等部门。使用温度-20℃~120℃。
- 4、ADSWD 型卧式低转速离心泵，供输送清水及物理性质类似清水的其它液体之用。使用介质温度80℃以下。适用于工业和城市给排水、高层建筑增压送水、园林喷灌、消防增压、远距离输水、采暖、浴室冷暖气循环增压及设备配套等。

- 1.ADSW series horizontal centrifugal pump is used to rtansport pure water and other liquids of the similar physical natre as pure water and suitable for water supply and drainage in industries and cities,boost water-feeding of high buildings、garedn irregation、fire-fighting boost、remote water-transpporation、warming、cold-hot water circulation and boost in bathrooms,and equipment completing as well.The temperature of the used medium is under 80℃.
- 2.ADSWR series horizontal hot-water pump is suitable for the warming,hot-water boost,circulation,transpoortation etc.heat-supply system of the buildings and houses in civil and enterprise units,such utilization,metallurgy,chemical industry,textile,wood process,paper-making etc.where there is a high-temperature hot-water supply system from industrial booilers.The used medium's temperature is under 120℃.
- 3.ADSWH series horizontal chemical pump is used to transport the lipuid containing no solid grain,of cornosivity and sa similar viscosity like water and suitable for light & textile industry,petroleum,chemistry,metallurgy,electric powre,paper-making,food,pharmacy,synthetic fibre etc. departments.The temperature is -20℃~120℃.
- 4.ADSWD series horizontal low speed centrifugal pump is used to rtansport pure water and other liquids of the similar physical natre as pure water and suitable for water supply and drainage in industries and cities,boost water-feeding of high buildings、garedn irregation、fire-fighting boo-st、remote water-transpporation、warming、cold-hot water circulation and boost in bathrooms,and equipment completing as well.The tempe-rature of the used medium is under 80℃.

ADSW、ADSWR、ADSWH、ADSWD 型号意义

ADSW、ADSWR、ADSWH、ADSWD MODEL MEANING

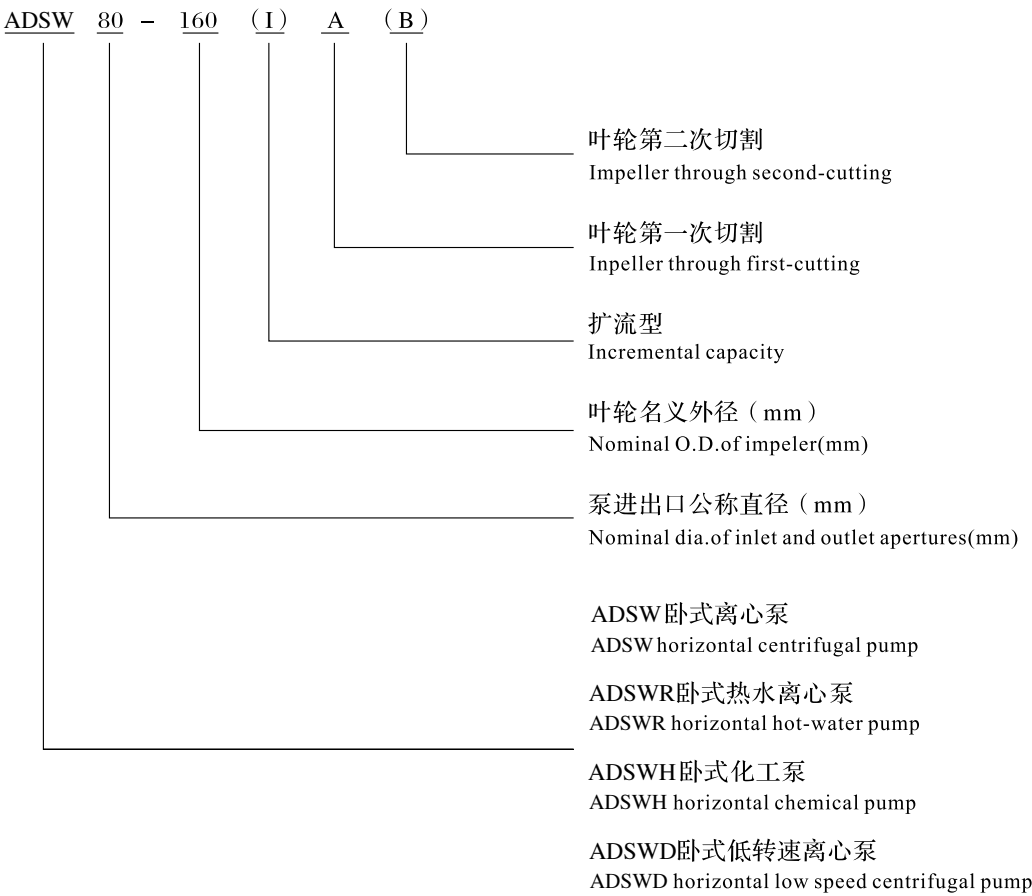

- 2.Proper medium:the medium for pure-water pumps should have no corrosive liquid and the volume of non-melting mediumsolid should not be over 0.1% of the unit volume and the graininess less than 0.2m.Please notify at oredr if the medium to be used with small grain.
- 3.No larger than 40℃ of the ambient temperature,no higher than 1000m of the above-sea level and no more than 95% of the relative humidity.

结构说明

STRUCTURE DESCRIPTION

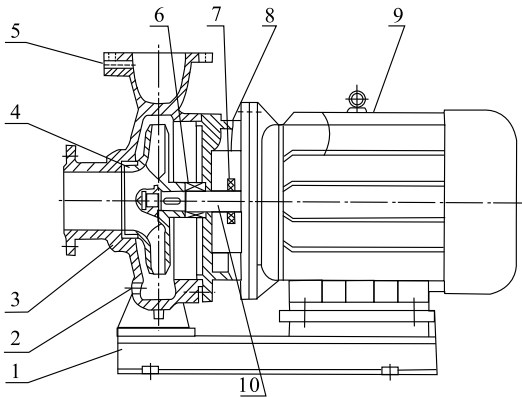

序号 No .	名称 Name
1	底座 Foundation
2	放水孔 Drainage hole
3	泵体 Pump casing
4	叶轮 Impeller
5	取压孔 Pressure tapping
6	机械密封 Mechanical seal
7	挡水圈 Water-bloching ring
8	端盖 End cover
9	电机 Motor
10	轴 Shaft

工作条件

WORKING CONDITIONS

- 1、泵系统最高工作压力≤1.6MPa，即泵吸入口压力+泵扬程≤1.6MPa，订货时请注明系统工作压力。当进口压力大于0.4MPa，或泵系统工作压力大于1.6MPa时，应在订货时另行提出，以便在制造时，泵的过流部分和联接部分采用铸钢材料。
- 2、适用介质：清水泵介质应无腐蚀性液体，介质固体不溶物，其体积不超过单位0.1%，粒度<0.2mm，如介质为带有细小颗粒的请在订货时说明。
- 3、周围环境温度不超过40℃，相对湿度不超过95%。

1.Max.working pressure of pump system is ≤1.6MPa,that is to say the pressure at the suction+the stroke≤1.6MPa,the pressure in static tests is 2.5 MPa,please notify the pressure for the system at work when ordering and it should be otherwise noted if the said pressure is larger than 1.6MPa so as to use cast steel material for the over-flow and joint parts.

ADSW SINGLE-STAGE SINGLE-SUCTION HORIZONTAL CENTRIFUGAL PUMP

AID SEN WATER

ADSW、ADSWR、ADSWH、ADSWD 型谱图

ADSW、ADSWR、ADSWH、ADSWD ATLAS OF STYLE

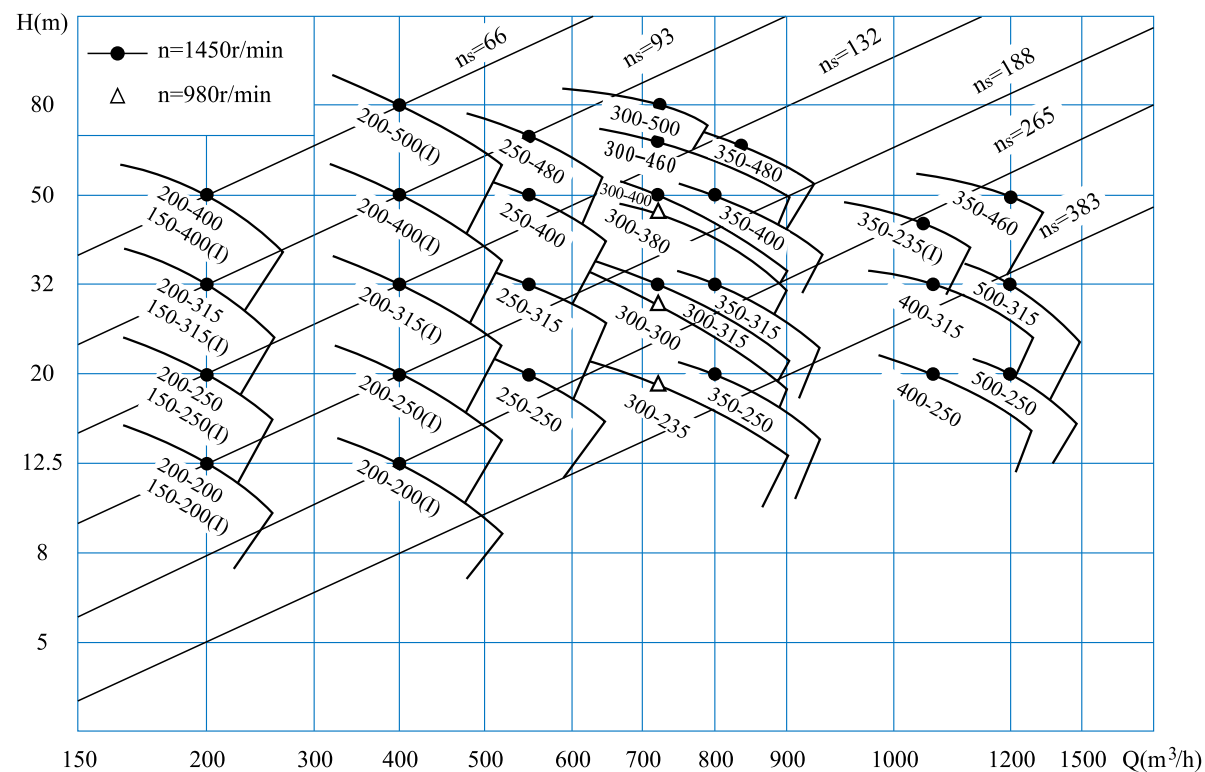
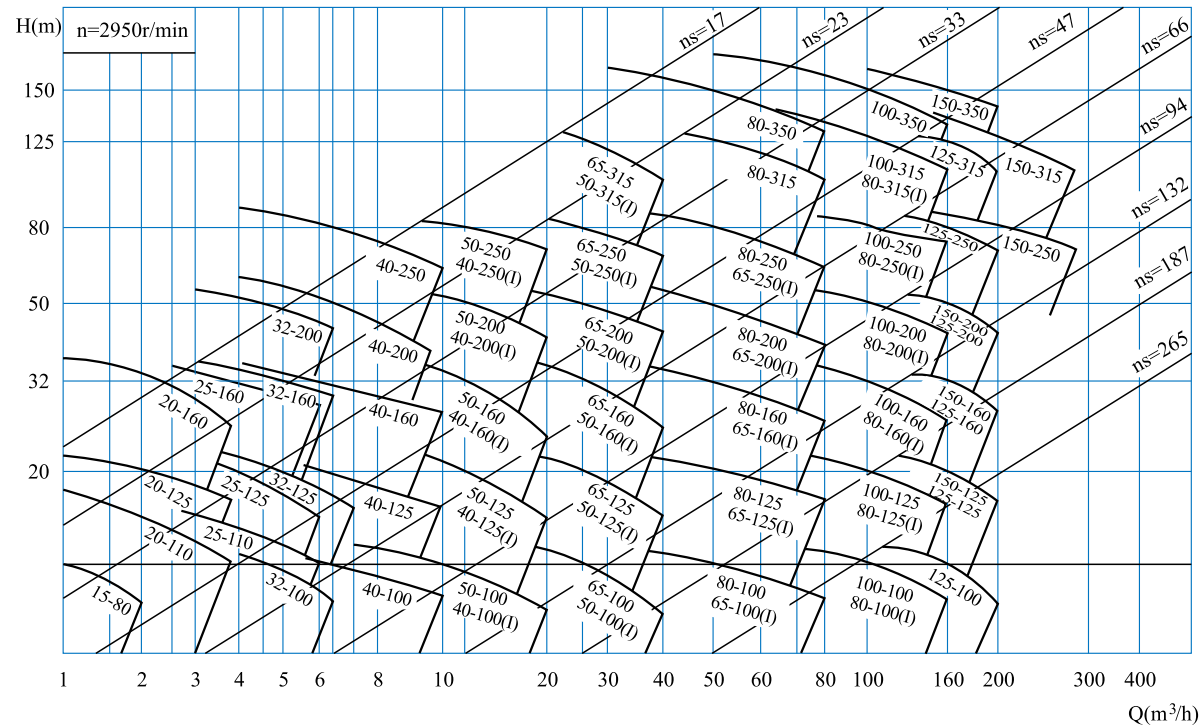

泵性能参数表

PUMP PERFORMANCE DATA

型 号 Type	流 量 Q Capacity		扬程 Head H (m)	效率 Eff. η (%)	电机 功率 Power P (kW)	转速 Speed n (r/min)	必需汽 蚀余量 (NPSH) _r (m)	重量 Weight (kg)
	(m³/h)	(L/s)						
25-110	2.8 4 5.2	0.78 1.11 1.44	16 15 13.5	34 42 41	0.55	2900	2.3	33
25-125	2.8 4 5.2	0.78 1.11 1.44	20.6 20 18	28 36 35	0.75	2900	2.3	37
25-125A	2.5 3.6 4.6	0.69 1.0 1.28	17 16 14.4	27 35 34	0.75	2900	2.3	37
25-160	2.8 4 5.2	0.78 1.11 1.44	32 32 30	24 32 33	1.5	2900	2.3	46
25-160A	2.6 3.7 4.9	0.72 1.03 1.36	28.5 28 26	22 31 29	1.1	2900	2.3	42
32-100	3.5 4.5 5.3	0.97 1.25 1.47	13.5 12.5 11.0	40 47 43	0.55	2900	2.3	37
32-100(I)	4.4 6.3 8.3	1.22 1.75 2.32	13.2 12.5 11.3	48 54 53	0.75	2900	2.0	40
32-125	3.5 6 6.5	0.97 1.39 1.80	22 20 18	40 44 42	0.75	2900	2.3	40
32-125A	3.1 4.5 5.8	0.86 1.25 1.61	17.6 16 14.4	39 43 41	0.75	2900	2.3	39
32-160	3.5 4.5 6	0.97 1.25 1.67	33 32 30	30 35 30	1.5	2900	2.3	51
32-160A	3.5 4.5 6	0.97 1.25 1.67	26.5 25 23	29 34 32	1.1	2900	2.3	45
32-160(I)	4.4 6.3 8.3	1.22 1.75 2.32	33.2 32 30.2	33 32 30	2.2	2900	2.3	55
32-200	3.5 4.5 5.5	0.97 1.25 1.53	51 50 48	27 32 30	3	2900	2.3	71
32-200A	3.9 4 4.2	1.08 1.11 1.17	41 40 38	26 31 29	3	2900	2.3	61
32-200(I)	4.4 6.3 8.3	1.22 1.75 2.32	50.5 50 48	26 33 35	4	2900	2.3	76
40-100	4.4 6.3 8.3	1.22 1.75 2.31	13.2 12.5 11.3	48 54 53	0.55	2900	2.3	34
40-100A	3.9 5.6 7.4	1.08 1.56 2.06	10.6 10 9	52	0.37	2900	2.3	25
40-125	4.4 6.3 8.3	1.22 1.75 2.31	21 20 18	41 46 43	1.1	2900	2.3	35
40-125A	3.9 5.6 7.4	1.08 1.56 2.06	17.6 16 14.4	40 45 41	0.75	2900	2.3	31
40-160	4.4 6.3 8.3	1.22 1.75 2.31	33 32 30	35 40 40	2.2	2900	2.3	50
40-160A	4.1 5.9 7.8	1.14 1.64 2.17	29 28 26.3	34 39 39	1.5	2900	2.3	44
40-160B	3.8 5.5 7.2	1.06 1.53 2.0	25.5 24 22.5	34 38 37	1.1	2900	2.3	37
40-200	4.4 6.3 8.3	1.22 1.75 2.31	51 50 48	26 33 32	4.0	2900	2.3	76
40-200A	4.1 5.9 7.8	1.14 1.64 2.17	45 44 42	26 31 30	3.0	2900	2.3	64
40-200B	3.7 5.3 7.0	1.03 1.47 1.94	38 36 34.5	25 29 28	2.2	2900	2.3	54
40-250	4.4 6.3 8.3	1.22 1.75 2.31	82 80 74	24 28 28	7.5	2900	2.3	108
40-250A	4.1 5.9 7.8	1.17 1.64 2.17	72 70 65	24 28 27	7.5	2900	2.3	100
40-250B	3.8 5.5 7.0	1.06 1.53 1.94	61.5 60 56	23 27 26	4.0	2900	2.3	80
40-100(I)	8.8 12.5 16.3	2.44 3.47 4.53	13.2 12.5 11.3	55 62 60	1.1	2900	2.3	36
40-100(I)A	8 11 14.5	2.22 3.05 4.03	10.6 9 8	54 60 58	0.75	2900	2.3	34

型 号 Type	流 量 Q Capacity		扬程 Head H (m)	效率 Eff. η (%)	电机 功率 Power P (kW)	转速 Speed n (r/min)	必需汽 蚀余量 (NPSH) _r (m)	重量 Weight (kg)
	(m³/h)	(L/s)						
40-125(I)	8.8 12.5 16.3	2.44 3.47 4.53	21.2 20 17.8	49 58 57	1.5	2900	2.3	40
40-125(I)A	8 11 14.5	2.22 3.05 4.03	17 16 14	48 57 56	1.1	2900	2.3	35
40-160(I)	8.8 12.5 16.3	2.44 3.47 4.53	33 32 30	45 52 51	3.0	2900	2.3	58
40-160(I)A	8.2 11.7 15.2	2.28 3.25 4.22	29 28 26	44 51 50	2.2	2900	2.3	49
40-160(I)B	7.3 10.4 13.5	2.38 2.89 3.75	23 22 20.5	43 50 49	1.5	2900	2.3	44
40-200(I)	8.8 12.5 16.3	2.44 3.47 4.53	51.2 50 48	38 46 46	5.5	2900	2.3	87
40-200(I)A	8.3 11.7 15.3	2.31 3.25 4.25	45 44 42	37 45 45	4.0	2900	2.3	76
40-200(I)B	7.5 10.5 13.8	2.08 2.92 3.83	37 36 34	36 44 44	3.0	2900	2.3	65
40-250(I)	8.8 12.5 16.3	2.44 3.47 4.53	81.2 80 77.5	31 40 38	11	2900	2.3	148
40-250(I)A	8.2 11.6 15.2	2.28 3.25 4.22	71 70 68	30 38 36	7.5	2900	2.3	98
40-250(I)B	7.6 10.8 14	2.11 3.0 3.89	61.4 60 58	29 37 35	7.5	2900	2.3	97
50-100	8.8 12.5 16.3	2.44 3.47 4.53	13.6 12.5 11.3	55 62 60	1.1	2900	2.3	38
50-100A	8 11 14.5	2.22 3.05 4.03	11 10 9	54 60 58	0.75	2900	2.3	37
50-125	8.8 12.5 16.3	2.44 3.47 4.53	21.5 20 17.8	49 58 57	1.5	2900	2.3	44
50-125A	8 11 14.5	2.22 3.05 4.03	17 16 14	48 57 56	1.1	2900	2.3	39
50-160	8.8 12.5 16.3	2.44 3.47 4.53	33 32 30	45 52 51	3.0	2900	2.3	60
50-160A	8.2 11.7 15.2	2.28 3.25 4.22	29 28 26	44 51 50	2.2	2900	2.3	52
50-160B	7.3 10.4 13.5	2.38 2.89 3.75	23 22 20.5	43 50 49	1.5	2900	2.3	48
50-200	8.8 12.5 16.3	2.44 3.47 4.53	52 50 48	38 46 46	5.5	2900	2.3	104
50-200A	8.3 11.7 15.3	2.31 3.25 4.25	45.8 44 42	37 44 45	4.0	2900	2.3	82
50-200B	7.5 10.6 13.8	2.08 2.94 3.83	37 36 34	38 44 40	3.0	2900	2.3	69
50-250	8.8 12.5 16.3	2.44 3.47 4.53	82 80 77.5	29 40 38	11	2900	2.3	163
50-250A	8.2 11.6 15.2	2.28 3.22 4.22	71.5 70 68	28 38 36	7.5	2900	2.3	116
50-250B	7.6 10.8 14	2.11 3.0 3.89	61.4 60 58	27 37 35	7.5	2900	2.3	114
50-100(I)	17.5 25 32.5	4.86 6.94 9.03	13.7 12.5 10.5	67 69 69	1.5	2900	2.5	43
50-100(I)A	15.6 22.3 29	4.3 6.19 8.1	11 10 8.4	65 68 67	1.1	2900	2.5	38
50-125(I)	17.5 25 32.5	4.86 6.94 9.03	21.5 20 18	60 68 67	3	2900	2.5	58
50-125(I)A	15.6 22.3 29	4.33 6.19 8.1	17 16 13.6	58 66 65	2.2	2900	2.5	50
50-160(I)	17.5 25 32.5	4.86 6.94 9.03	34.4 32 27.5	54 65 62	4	2900	2.5	74
50-160(I)A	16.4 23.4 30.4	4.56 6.5 8.44	30 28 24	54 62 59	4	2900	2.5	72

ADSW型单级单吸卧式离心泵

ADSW SINGLE-STAGE SINGLE-SUCTION HORIZONTAL CENTRIFUGAL PUMP

AIDENSENWATER

泵性能参数表

PUMP PERFORMANCE DATA

型 号 Type	流 量 Q Capacity		扬程 Head H (m)	效率 Eff. η (%)	电机 功率 Power P (kW)	转速 Speed n (r/min)	必需汽 蚀余量 (NPSH)r (m)	重量 Weight (kg)
	(m³/h)	(L/s)						
50-160(I)B	15.0 21.6 28	4.17 6.0 7.78	26 24 20.6	51 58 56	3	2900	2.5	61
50-200(I)	17.5 25 32.5	4.86 6.94 9.03	52.7 50 45.5	53 60 58	7.5	2900	2.5	113
50-200(I)A	16.4 23.5 30.5	4.56 6.53 8.47	46.4 44 40	49 58 54	7.5	2900	2.5	111
50-200(I)B	15.2 21.8 28.3	4.2 6.06 7.86	40 38 34.5	47 55 51	5.5	2900	2.5	104
50-250(I)	17.5 25 32.5	4.86 6.94 9.03	46.4 40 36.2	49 52 50	15	2900	2.5	180
50-250(I)A	16.4 23.4 30.5	4.56 6.53 8.47	71.5 70 67	45 51 47	11	2900	2.5	170
50-250(I)B	15 21.6 28	4.17 6.0 7.78	61 60 57.4	38 54 49	11	2900	2.5	170
50-315(I)	17.5 25 32.5	4.86 6.94 9.03	128 125 122	38 44 40	30	2900	2.5	313
50-315(I)A	16.6 23.7 31	4.61 6.58 8.6	115 113 112	37 43 40	22	2900	2.5	247
50-315(I)B	15.7 22.5 29.2	4.36 6.25 8.1	103 101 98	33 39 37	18.5	2900	2.5	217
65-100	17.5 25 32.5	4.86 6.94 9.03	13.7 12.5 10.5	67 69 68	1.5	2900	2.5	48
65-100A	15.6 22.3 29	4.3 6.19 8.1	11 10 8.4	65 68 67	1.1	2900	2.5	42
65-125	17.6 25 32.5	4.86 6.94 9.03	21.5 20 18	61 68 66	3	2900	2.5	60
65-125A	15.6 22.3 29	4.33 6.19 8.1	17 16 14.4	58 66 65	2.2	2900	2.5	51
65-160	17.5 25 32.5	4.86 6.94 9.03	34.4 32 27.5	54 63 60	4	2900	2.5	77
65-160A	16.4 23.4 30.4	4.56 6.5 8.44	30 28 24	54 59 59	4	2900	2.5	76
65-160B	15.0 21.6 28	4.17 6.0 7.78	26 24 20.6	51 58 56	3.0	2900	2.5	63
65-200	17.5 25 32.5	4.86 6.94 9.03	52.7 50 42.5	49 60 58	7.5	2900	2.5	110
65-200A	16.4 23.5 30.5	4.56 6.53 8.47	46.4 44 40	48 58 57	7.5	2900	2.5	109
65-200B	15.2 21.8 28.3	4.22 6.06 7.86	40 38 34.5	47 55 51	5.5	2900	2.5	101
65-250	17.5 25 32.5	4.86 6.94 9.03	82 80 76.5	39 52 50	15	2900	2.5	185
65-250A	16.4 23.5 30.5	4.56 6.5 8.47	7.5 70 67	47 51 48	11	2900	2.5	173
65-250B	15 21.6 28	4.17 6.0 7.78	61 60 57.4	43 50 46	11	2900	2.5	173
65-315	17.5 25 32.5	4.86 6.94 9.03	127 125 122	32 42 40	30	2900	2.5	325
65-315A	16.6 23.7 31	4.61 6.58 8.6	115 113 110	31 43 39	22	2900	2.5	258
65-315B	15.7 22.5 29.2	4.36 6.25 8.1	103 101 98	33 39 37	18.5	2900	2.5	229
65-100(I)	35 50 65	9.72 13.9 18.1	13.8 12.5 10	67 73 70	3.0	2900	3.0	65
65-100(I)A	31.3 44.7 58	8.7 12.4 16.1	11 10 8	66 72 69	2.2	2900	3.0	54
65-125(I)	35 50 65	9.72 13.9 18.1	22 20 17	67 72.5 70	5.5	2900	3.0	100
65-125(I)A	31.3 45 58	8.7 12.5 16.1	17.5 16 13.6	66 71 69	4	2900	3.0	80
80-100	35 50 65	9.72 13.9 18.1	13.8 12.5 10	67 73 70	3	2900	3.0	65
80-100A	31.3 44.7 58	8.7 12.4 16.1	11 10 8	66 72 69	2.2	2900	3.0	55
80-125	35 50 65	9.72 13.9 18.1	22 20 17	67 72.5 70	5.5	2900	3.0	100
80-125A	31.3 45 58	8.7 12.5 16.1	17.5 16 13.6	66 71 69	4	2900	3.0	80
80-160	35 50 65	9.72 13.9 18.1	35 32 28	63 71 70	7.5	2900	3.0	107
80-160A	32.7 46.7 61	9.1 13.0 16.9	30.6 28 24	62 70 69	7.5	2900	3.0	106
80-160B	30.3 43.3 56.33	8.4 12.0 15.6	26 24 21	61 69 68	5.5	2900	3.0	99
80-200	35 50 65	9.72 13.9 18.1	53.5 50 46	55 69 67	15	2900	3.0	177
80-200A	32.8 47 61	9.1 13.1 16.9	47 44 40	54 67 66	11	2900	3.0	166
80-200B	30.5 43.5 56.6	8.5 12.1 15.7	40.6 38 33.4	53 65 64	7.5	2900	3.0	116
80-250	35 50 65	9.72 13.9 18.1	83 80 72	52 62 59	22	2900	3.0	245
80-250A	32.5 46.7 61	9.0 13.0 16.9	73 70 63	51 60 58	18.5	2900	3.0	215
80-250B	30 43.3 56	8.3 12.0 15.6	62 60 54	50 58 57	15	2900	3.0	187
80-315	35 50 65	9.72 13.9 18.1	128 125 122	44 54 57	37	2900	3.0	360
80-315A	32.5 46.5 60.5	9.0 12.9 16.8	112 110 107	43 54 57	30	2900	3.0	342
80-315B	31 44.5 58	8.6 12.4 16.1	102 100 98	42 53 56	30	2900	3.0	342
80-315C	29 41 53.6	8.1 11.4 14.9	87 85 83	41 51 54	22	2900	3.0	277
80-350	35 50 60	9.72 13.9 16.7	156 150 140	53 54 52	55	2900	3.0	557

泵性能参数表

PUMP PERFORMANCE DATA

型 号 Type	流 量 Q Capacity		扬程 Head H (m)	效率 Eff. η (%)	电机 功率 Power P (kW)	转速 Speed n (r/min)	必需汽 蚀余量 (NPSH)r (m)	重量 Weight (kg)
	(m³/h)	(L/s)						
80-350A	30.8 44 52.8	8.56 12.2 14.7	148 142 135	45 51 50	45	2900	3.0	441
80-350B	28 40 46	7.78 11.1 12.8	142 135 128	39 48 46	37	2900	3.0	378
80-100(I)	70 100 130	19.4 27.8 36.1	14.0 12.5 11	66 76 75	5.5	2900	4.5	110
80-100(I)A	62.6 89 116	17.4 24.7 32.2	12 10 8.8	64 74 74	4	2900	4.5	88
80-125(I)	70 100 130	19.4 27.8 36.1	23.5 20 14	70 76 72	11	2900	4.5	164
80-125(I)A	62.6 89 116	17.4 24.7 32.2	19 16 11	68 74 65	7.5	2900	4.5	114
80-160(I)	70 100 130	19.4 27.8 36.1	36.5 32 24	70 76 65	15	2900	4.5	187
80-160(I)A	65.4 93.5 121	18.2 26.0 33.8	32 28 21	68 74 67	11	2900	4.5	175
80-160(I)B	60.6 86.6 112	16.8 24.1 31.3	27 24 18	66 72 65	11	2900	4.5	175
80-200(I)	70 100 130	19.4 27.8 36.1	54 50 42	65 74 73	22	2900	4.0	253
80-200(I)A	65.4 93.5 121	18.2 26.0 33.8	47.5 44 37	64 73 72	18.5	2900	4.0	221
80-200(I)B	61 87 113	16.9 24.2 31.4	41 38 32	62 71 70	15	2900	4.0	200
80-250(I)	70 100 130	19.4 27.8 36.1	87 80 68	62 71 68	37	2900	4.0	333
80-250(I)A	65.4 93.5 121	18.2 26.0 33.8	76 70 59.5	61 68 67	30	2900	4.0	315
80-250(I)B	61 87 113	16.9 24.2 31.4	65 60 51	60 66 66	30	2900	4.0	271
80-315(I)	70 100 130	19.4 27.8 36.1	132 125 114	55 67 66	75	2900	4.0	680
80-315(I)A	66.5 95 123	18.5 26.4 34.3	119 113 103	59 65 64	55	2900	4.0	537
80-315(I)B	63 90 117	17.5 25 32.5	106 101 92	58 65 63	45	2900	4.0	425
80-315(I)C	58 82 107	16.1 22.8 29.7	90 85 76	56 63 61	37	2900	4.0	370
100-100	70 100 130	19.4 27.8 36.1	13.6 12.5 11	66 76 75	5.5	2900	4.5	115
100-100A	62.6 89 116	17.4 24.7 32.2	11 10 8.8	64 74 74	4	2900	4.5	92
100-125	70 100 130	19.4 27.8 36.1	23.5 20 14	70 76 65	11	2900	4.5	173
100-125A	62.5 89 116	17.4 24.7 32.2	19 16 11	68 74 63	7.5	2900	4.5	120
100-160	70 100 130	19.4 27.8 36.1	36.5 32 24	70 76 65	15	2900	4.5	194
100-160A	65.4 93.5 121	18.2 26.0 33.8	32 28 21	68 74 67	11	2900	4.5	182
100-160B	60.6 86.6 112	16.8 24.1 31.3	27 24 18	67 72 65	11	2900	4.5	182
100-200	70 100 130	19.4 27.8 36.1	54 50 42	65 75 73	22	2900	4.0	248
100-200A	65.4 93.5 121	18.2 26.0 33.8	47.5 44 37	64 73 72	18.5	2900	4.0	216
100-200B	61 87 113	16.9 24.2 31.4	41 38 32	63 71 70	15	2900	4.0	195
100-250	70 100 130	19.4 27.8 36.1	87 80 68	62 71 68	37	2900	4.0	348

型 号 Type	流 量 Q Capacity		扬程 Head H (m)	效率 Eff. η (%)	电机 功率 Power P (kW)	转速 Speed n (r/min)	必需汽 蚀余量 (NPSH)r (m)	重量 Weight (kg)
	(m³/h)	(L/s)						
100-250A	65.4 93.5 121	18.2 26.0 33.8	76 70 59.5	61 68 67	30	2900	4.0	332
100-250B	61 87 113	16.9 24.2 31.4	65 60 51	59 66 65	30	2900	4.0	332
100-315	70 100 130	19.4 27.8 36.1	132 125 114	55 67 66	75	2900	4.0	695
100-315A	66.5 95 123	18.5 26.4 34.3	119 113 103	55 65 64	55	2900	4.0	552
100-315B	63 90 117	17.5 25.0 32.5	106 101 92	51 63 63	45	2900	4.0	442
100-350	60 100 120	16.7 27.8 33.3	153.6 150 142	72 57 74	90	2900	4.0	777
100-350A	61 87 113	16.9 24.2 31.4	145.6 142 134	75	75	2900	4.0	683
100-350B	58 82 107	16.1 22.8 29.7	138.6 135 127	75	55	2900	4.0	536
100-100(I)	96 160 192	26.7 44.4 53.3	14 12.5 10	64 73 70	11	2900	4.0	110
100-125(I)	96 160 192	26.7 44.4 53.3	24 20 14	62 74 69	15	2900	4.0	168
100-125(I)A	84 140 168	23.3 39 46.7	20 17 12	64 72 68	11	2900	4.0	160
100-160(I)	96 160 192	26.7 44.4 53.3	36 32 27	69 79 75	22	2900	4.0	210
100-160(I)A	84 140 168	23.3 39 46.7	32 28 23.5	66 76 72	18.5	2900	4.0	205
100-200(I)	96 160 192	26.7 44.4 53.3	54 50 46	65 77 75	37	2900	4.0	348
100-200(I)A	84 140 168	23.3 39.0 46.7	47.5 44 40.5	64 76 75	30	2900	4.0	332
100-200(I)B	60 138 170	23.6 38.3 47.2	40 37 34	63 75 75	30	2900	4.0	331
100-250(I)	96 160 192	26.7 44.4 53.3	83 80 72	65 77 74	55	2900	4.0	560
100-250(I)A	84 140 168	23.3 39 46.7	75 72 65	60 72 69	45	2900	4.0	540
100-250(I)B	60 100 120	16.7 27.8 33.3	68 65 58	70	37	2900	4.0	520
125-100	96 160 192	26.7 44.4 53.3	13 12.5 12	82	11	2900	4.0	185
125-100A	86 143 172	23.9 39.7 47.8	10.4 10 9.6	77	7.5	2900	4.0	130
125-125	96 160 192	26.7 44.4 53.3	22.6 20 17	80	15	2900	4.0	227
125-125A	86 143 172	23.9 39.7 47.8	18 16 13.6	77	11	2900	4.0	215
125-160	96 160 192	26.7 44.4 53.3	36 32 28	78	22	2900	4.0	272
125-160A	90 150 180	25 41.7 50	31.5 28 24.5	76	18.5	2900	4.0	215
125-160B	83 138 166	21.7 38.3 46.1	27 24 21	73	15	2900	4.0	182
125-200	96 160 192	26.7 44.4 53.3	55 50 46	77	37	2900	4.0	386
125-200A	90 150 180	25 41.7 50	48.4 44 40.5	76	30	2900	4.0	365
125-200B	83 138 166	21.7 33.3 46.1	41.3 37.5 34.5	75	22	2900	4.0	302
125-250	96 160 192	26.7 44.4 53.3	87 80 73	75	55	2900	4.0	562

ADSW型单级单吸卧式离心泵

ADSW SINGLE-STAGE SINGLE-SUCTION HORIZONTAL CENTRIFUGAL PUMP

AIDASEN WATER

泵性能参数表

PUMP PERFORMANCE DATA

型 号 Type	流 量 Q Capacity		扬程 Head H (m)	效率 Eff. η (%)	电机 功率 Power P (kW)	转速 Speed n (r/min)	必需汽 蚀余量 (NPSH) _r (m)	重量 Weight (kg)
	(m³/h)	(L/s)						
125-250A	90 150 180	25 41.7 50	76 70 64	74	45	2900	4.0	457
125-250B	83 138 166	21.7 33.3 46.1	65 60 55	73	37	2900	4.0	404
125-315	96 160 192	26.7 44.4 53.3	133 125 119	70	90	2900	4.0	756
125-315A	90 150 180	25 41.7 50	117 110 104	70	75	2900	4.0	651
125-315B	86 143 172	23.9 39.7 47.8	106 100 95.2	69	75	2900	4.0	646
150-125	96 160 192	26.7 44.4 53.3	22.6 24 17	66 76 76	15	2900	4.0	236
150-125A	90 150 180	25 41.7 50	18 16 13.6	77	11	2900	4.0	226
150-160	96 160 192	26.7 44.4 53.3	35 32 28	72 78 76	22	2900	4.0	294
150-160A	90 150 180	25.0 41.7 50.0	31.5 28 24.5	71 76 73	18.5	2900	4.0	252
150-160B	84 140 168	23.3 38.9 46.7	27 24 21	67 73 72	15	2900	4.0	231
150-200	96 160 192	26.7 44.4 53.3	55 50 46	77	37	2900	4.0	410
150-200A	90 150 180	25 41.7 50	48.4 44 40.5	76	30	2900	4.0	385
150-200B	83 138 166	21.7 33.3 46.1	41.3 37.5 34.5	75	22	2900	4.0	315
150-250(I)	120 200 240	33.3 55.6 66.7	87 80 72	65 74 74	75	2900	4.0	761
150-250(I)A	112 187 224	31.1 51.9 62.2	76 70 63	64 75 73	55	2900	4.0	614
150-250(I)B	104 173 208	26.9 48.1 57.8	65 60 54	63 74 72	45	2900	4.0	509
150-315(I)	120 200 240	33.3 55.6 66.7	133 125 120	72 75 73	110	2900	4.5	1029
150-315(I)A	112 187 224	31.1 51.9 62.2	116 110 105	57 74 72	90	2900	4.5	767
150-315(I)B	104 173 208	28.9 48.1 57.8	100 95 91	55 72 70	75	2900	4.5	746
150-350	96 160 192	26.7 44.4 53.3	153.6 150 138	69 70 67	110	2900	4.5	1040
150-350A	105 150 180	29.2 41.7 50	152 142 130	68 69 65	90	2900	4.5	777
150-350B	98 140 168	27.2 38.9 46.7	110 101 90	63 67 60	75	2900	4.5	756
150-200(I)	140 200 260	38.9 55.6 72.2	13.8 12.5 10.6	68 78 78	15	1450	3.0	278
150-200(I)A	125 176 232	34.7 49.7 64.6	11.5 10 8.5	66 76 76	11	1450	3.0	263
150-250(I)	140 200 260	38.9 55.6 72.2	21.8 20 17	73 80 77	18.5	1450	3.0	355
150-250(I)A	129 184 240	35.8 51.1 66.7	18.5 17 14.4	72 78 76	15	1450	3.0	315
150-250(I)B	117 167 217	32.5 46.4 60.4	15.2 14 12	70 76 74	11	1450	3.0	294
150-315(I)	140 200 260	38.9 55.6 72.2	33.8 32 28	70 78 73	30	1450	3.5	462
150-315(I)A	131 187 243	36.4 51.9 67.5	29.5 28 24.5	69 77 77	22	1450	3.5	378
150-315(I)B	121 173 225	33.6 48.1 62.3	25 24 21	69 76 75	18.5	1450	3.5	368

型 号 Type	流 量 Q Capacity		扬程 Head H (m)	效率 Eff. η (%)	电机 功率 Power P (kW)	转速 Speed n (r/min)	必需汽 蚀余量 (NPSH) _r (m)	重量 Weight (kg)
	(m³/h)	(L/s)						
150-400(I)	140 200 260	38.9 55.6 72.2	53 50 46	68 75 71	45	1450	3.5	620
150-400(I)A	131 187 243	36.4 51.9 67.5	46.6 44 38.3	67 74 70	37	1450	3.5	578
150-400(I)B	122 174 226	33.9 48.3 62.9	40 38 33	64 73 70	30	1450	3.5	546
150-400(I)C	112 160 208	31.3 44.4 57.8	34 32 28	64 71 69	22	1450	3.5	515
200-200	140 200 260	38.9 55.6 72.2	13.8 12.5 10.6	67 75 78	15	1450	3.0	404
200-200A	125 179 232	34.7 49.7 64.6	11 10 8.5	66 76 76	11	1450	3.0	383
200-250	140 200 260	38.9 55.6 72.2	21.8 20 17	73 80 77	18.5	1450	3.0	450
200-250A	129 184 240	35.8 51.2 66.7	18.5 17 14.4	72 78 76	15	1450	3.0	438
200-250B	117 167 217.5	32.5 46.4 60.4	15.2 14 12	70 76 75	11	1450	3.0	404
200-315	140 200 260	38.9 55.6 72.2	33.8 32 28	70 78 78	30	1450	3.5	578
200-315A	131 187 243	36.4 51.9 67.5	29.5 28 24.5	69 77 77	22	1450	3.5	483
200-315B	121 173 225	33.6 48.1 62.5	25.5 24 20.5	69 76 75	18.5	1450	3.5	462
200-400	140 200 260	38.9 55.6 72.2	53 50 46	68 75 71	45	1450	3.5	620
200-400A	131 187 243	36.4 51.9 67.5	46.6 44 38.3	67 74 70	37	1450	3.5	578
200-400B	122 174 226	33.9 48.3 62.9	40 38 33	64 73 70	30	1450	3.5	546
200-400C	112 160 208	31.3 44.4 57.8	34 32 28	64 71 69	22	1450	3.5	515
200-200(I)	280 400 520	77.8 111 144	13.4 12.5 10.5	70 80 79	22	1450	4.0	452
200-200(I)A	250 358 465	69.4 99.4 129	11.2 10 8.5	68 78 77	18.5	1450	4.0	452
200-250(I)	280 400 520	77.8 111 144	22.2 20 14	75 80 72	30	1450	4.0	525
200-250(I)A	250 358 465	69.4 99.4 129	18 16 11.2	73 78 70	22	1450	4.0	431
200-250(I)B	226 322 419	62.8 89.4 116	14.4 13 9.3	70 75 67	18.5	1450	4.0	420
200-315(I)	280 400 520	77.8 111 144	36 32 26	73 80 75	55	1450	4.0	756
200-315(I)A	262 374 486	72.8 103 135	31.5 23 23	72 79 74	45	1450	4.0	651
200-315(I)B	242 346 450	67.2 96.1 125	27 24 19.5	71 78 73	37	1450	4.0	599
200-400(I)	280 400 520	77.8 111.4 144	54.5 50 39	75 81 77	75	1450	4.0	1008
200-400(I)A	262 374 486	72.8 103 135	48 44 34	74 80 76	75	1450	4.0	893
200-400(I)B	242 346 450	67.2 96.1 125	41.4 38 29.6	72 78 74	55	1450	5.0	746
200-400(I)C	224 320 416	62.2 88.9 115	34.9 32 25	70 76 72	45	1450	5.0	635
200-500(I)	280 400 520	77.8 111.1 144.4	85 80 70	76 78 76	132	1450	4.0	1254
200-500(I)A	262 374 486	72.8 103.9 135	74.4 70 61.2	75 77 75	110	1450	4.0	1184

泵性能参数表

PUMP PERFORMANCE DATA

型 号 Type	流 量 Q Capacity		扬程 Head H (m)	效率 Eff. η (%)	电机 功率 Power P (kW)	转速 Speed n (r/min)	必需汽 蚀余量 (NPSH) _r (m)	重量 Weight (kg)
	(m³/h)	(L/s)						
200-500(I)B	242 346 450	67.2 96.1 125	63.8 60 52.5	74 76 74	90	1450	4.0	1088
200-500(I)C	224 320 416	62.2 88.9 115.6	53.2 50 43.8	73 75 73	75	1450	4.0	980
250-250	350 550 650	97.2 152.8 180.5	22 20 16	78 82 81	45	1450	5.0	620
250-250A	300 500 600	83.3 139 166.7	18.3 17 14	76 80 80	37	1450	5.0	550
250-315	350 550 650	97.2 152.8 180.5	34 32 28	76 80 79	75	1450	5.0	915
250-315A	300 500 600	83.3 139 166.7	29.5 28 24	74 78 77	55	1450	5.0	840
250-315B	260 450 520	72.2 125 144.4	25 24 20	70 74 72	45	1450	5.0	695
250-400	400 550 670	111.1 152.8 186.7	54.5 50 39	75 78 80	110	1450	5.0	1557
250-400A	365 500 600	101.4 138.9 166.7	47 44 35	74 77 79	90	1450	5.0	1055
250-400B	325 450 530	90.3 125 147.2	41.2 38 34.2	73 76 78	75	1450	5.0	910
250-480	400 550 670	111.1 152.8 186.7	76 70 63	75 76 78	160	1450	5.0	1545
250-480A	365 500 600	101.4 138.9 166.7	65 60 54	74 75 77	132	1450	5.0	1355
250-480B	325 450 530	90.3 125 147.2	55 50 42	73 74 74	90	1450	5.0	1055
250-500	400 550 660	111.1 152.8 186.7	84 80 70	68 76 71	200	1450	5.5	1880
250-500A	368 506 607	102.2 140.6 168.6	75 71 62.5	67 75 70	160	1450	5.5	1680
250-500B	339 466 559	94.2 129.4 155.2	66.5 63.5 55.5	65 73 68	132	1450	5.5	1452
300-235	540 720 900	150 200 250	20.5 18 15.0	77 81 74	55	1450	5.0	1135
300-235A	450 600 720	125 166.7 200	17.2 15 12.5	74 75 77	45	1450	5.0	1040
300-235B	420 540 650	116.7 150 181	14.3 12.8 10.5	73 78 70	37	1450	5.0	900
300-250	540 720 900	150 200 250	22.5 20 17	80 83 84	55	1450	5.0	1370
300-250A	450 600 720	136 166 200	19.5 17 14	75 81 76	45	1450	5.0	1190
300-300	540 720 900	150 200 250	32 28 23	82 75 75	75	1480	5.0	1930
300-300A	450 600 720	125 166 200	27.5 24 20	75 80 75	75	1480	5.0	1725
300-300B	420 540 650	116.7 150 181	24 21 17	78 75 71	55	1480	5.0	1550
300-235	480 720 900	133.3 200 250	20 18 15.5	77 81 74	55	980	5.0	1135
300-235A	438 607 821	121.7 182.5 228.1	16.5 15 13	75 79 72	45	980	5.0	1040
300-300	480 720 900	133.3 200 250	31 28 25	77 81 77	75	980	5.0	1370
300-300A	444 666 833	123.3 185 231.4	26.5 24 21.5	76 80 76	75	980	5.0	1370
300-300B	415 623 779	115.3 173.1 216.4	23 21 18.5	79 84 82	79	980	5.0	1190
300-380	480 720 900	133.3 200 250	48 44 34	76 84 82	132	980	5.0	1930
300-380A	444 666 833	123.3 185 231.4	41.4 38 30	78 84 81	110	980	5.0	1725
300-380B	400 614 767	113.6 170.6 213.1	35 32 25	75 82 75	80	980	5.0	1550

型 号 Type	流 量 Q Capacity	
-------------	-------------------	--

ADSW型单级单吸卧式离心泵

ADSW SINGLE-STAGE SINGLE-SUCTION HORIZONTAL CENTRIFUGAL PUMP

AIDASEN WATER

泵安装尺寸图表

PUMP DIMENSION TABLE

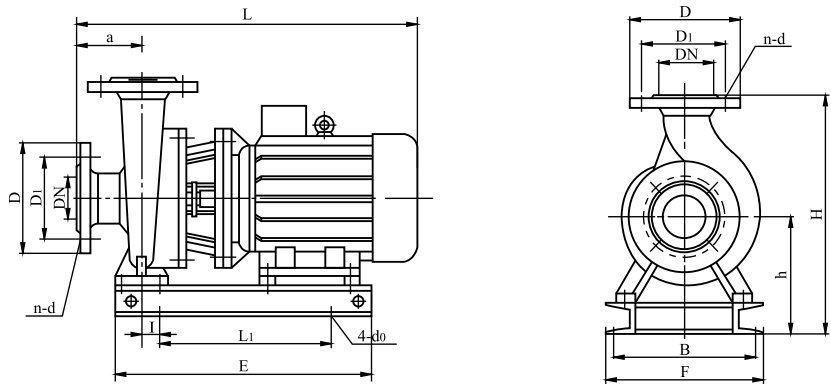

型 号 Type	外形 尺寸 Outline dimensionas				安 装 尺 寸 Installation dimensionas						进 出口 法 兰 尺 寸 Inlet-outlet flange dimensionas							
	L	H	E	F	a	h	L1	B	I	4-d0	DN	D	D1	n-d				
25-110	450	334	440	450	80	194	250	310	8	φ 16	φ 25	φ 115	φ 85	4- φ 14				
25-125	450	334	440	450	80	194	250	310	8									
25-125A	450	334	440	450	80	194	250	310	8									
25-160	480	355	490	390	85	210	270	340	8									
25-160A	460	355	440	450	85	210	250	310	8									
32-100	420	336	440	450	90	194	250	310	8	φ 16	φ 32	φ 140	φ 100	4- φ 14				
32-125	445	336	440	450	90	194	250	310	8									
32-125A	445	336	440	450	90	194	250	310	8									
32-160	470	370	490	390	95	210	270	340	8									
32-160A	470	370	490	390	95	210	270	340	8									
32-160(I)	470	336	490	390	85	194	270	340	8									
32-200	540	412	500	390	90	242	285	340	8									
32-200A	455	412	490	390	90	242	270	340	8									
32-200(I)	540	412	490	390	90	285	270	340	8									
40-100	442	306	440	450	80	181	250	310	11						φ 16	φ 40	φ 150	φ 110
40-100A	442	306	440	450	80	181	250	310	11									
40-125	442	332	440	450	80	192	250	310	11									
40-125A	442	332	440	450	80	192	250	310	11									
40-160	490	374	490	390	85	214	270	340	7									
40-160A	470	374	490	390	85	214	270	340	15									
40-160B	440	374	440	450	85	214	250	310	11									
40-200	560	414	500	390	90	242	285	340	19									
40-200A	530	414	500	390	90	242	285	340	15									
40-200B	510	414	490	390	90	242	270	340	7									
40-250	610	486	500	450	90	280	350	390	12									
40-250A	610	486	500	450	90	280	350	390	12									
40-250B	550	472	500	450	90	260	350	390	5									
40-100(I)	450	322	440	450	80	180	250	310	10	φ 18								
40-100(I)A	450	322	440	450	80	180	250	310	10									
40-125(I)	470	345	450	360	80	190	250	310	16									
40-125(I)A	445	345	440	450	80	190	250	310	16									
40-160(I)	540	375	490	390	85	210	270	340	15									
40-160(I)A	540	375	490	390	85	210	270	340	7	φ 16								
40-160(I)B	525	375	490	390	85	210	270	340	7									
40-200(I)	610	440	590	450	85	260	350	390	26									
40-200(I)A	550	420	500	390	85	240	285	340	21									
40-200(I)B	530	420	500	390	85	240	285	340	17									
40-250(I)	750	505	670	460	100	280	400	410	15	φ 18								
40-250(I)A	650	505	590	450	100	280	350	390	18									
40-250(I)B	505	505	590	450	100	280	350	390	18									
50-100	440	332	440	450	80	192	250	310	10	φ 16	φ 50	φ 165	φ 125	4- φ 18				
50-100A	440	332	440	450	80	192	250	310	10									

泵安装尺寸图表

PUMP DIMENSION TABLE

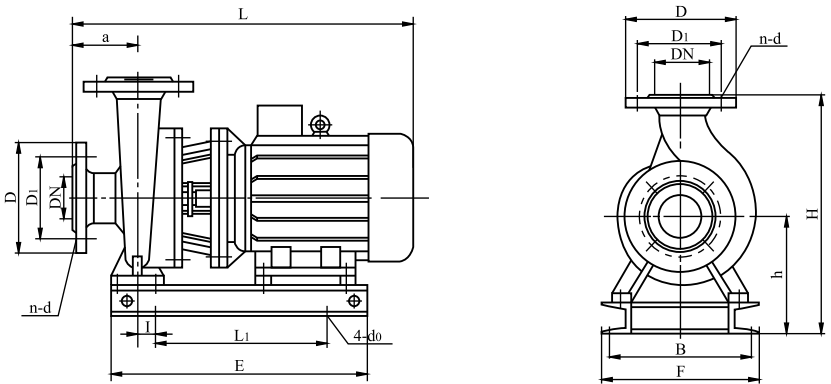

型 号 Type	外形尺寸 Outline dimensionas				安 装 尺 寸 Installation dimensionas						进出口法兰尺寸 Inlet-outlet flange dimensionas			
	L	H	E	F	a	h	L1	B	I	4-d0	DN	D	D1	n-d
50-125	470	340	450	360	80	190	250	310	16	φ 18	φ 50	φ 165	φ 125	4- φ 18
50-125A	455	340	440	450	80	190	250	310	16					
50-160	525	377	490	390	80	210	270	340	15					
50-160A	485	377	490	390	80	210	270	340	7					
50-160B	460	377	490	390	80	210	270	340	5					
50-200	610	446	550	390	80	265	340	350	26					
50-200A	550	422	500	390	80	245	285	340	21					
50-200B	532	422	500	390	80	245	285	340	17					
50-250	760	501	670	490	100	280	400	430	15					
50-250A	650	501	550	400	100	280	340	350	18					
50-250B	650	501	550	400	100	280	340	350	18					
50-100(I)	470	352	450	360	80	195	250	310	15					
50-100(I)A	450	352	440	450	80	195	250	310	11					
50-125(I)	540	356	480	360	90	188	290	300	18					
50-125(I)A	513	362	450	360	90	195	250	310	11					
50-160(I)	552	400	500	390	100	215	285	340	22					
50-160(I)A	532	400	500	390	100	215	285	340	17					
50-160(I)B	502	400	490	390	100	265	270	340	14					
50-200(I)	630	456	550	390	100	265	340	350	0					
50-200(I)A	630	456	550	390	100	265	340	350	0					
50-200(I)B	630	456	550	390	100	265	340	350	0					
50-250(I)	745	526	670	490	100	286	410	430	14					
50-250(I)A	745	526	670	490	100	286	410	430	14					
50-250(I)B	745	526	670	490	100	286	410	430	14					
50-315(I)	950	592	680	410	105	325	500	370	12	φ 18	φ 65	φ 185	φ 145	4- φ 18
50-315(I)A	845	592	610	410	105	325	500	370	12					
50-315(I)B	825	592	610	410	105	325	500	370	12					
65-100	465	352	450	360	85	195	250	310	15					
65-100A	440	352	440	450	85	195	250	310	11					
65-125	523	356	480	360	85	188	290	300	18					
65-125A	493	372	490	390	85	195	270	340	11					
65-160	552	395	500	390	100	214	285	340	22					
65-160A	552	395	500	390	100	214	285	340	17					
65-160B	532	395	490	390	100	214	270	340	14					
65-200	630	456	550	390	100	265	340	350	0					
65-200A	630	456	550	390	100	265	340	350	0					
65-200B	630	456	550	390	100	265	340	350	0					
65-250	745	526	670	490	100	296	400	430	14					
65-250A	745	526	670	490	100	296	400	430	14					
65-250B	745	526	670	490	100	296	400	430	14					
65-315	950	596	700	410	105	325	500	370	12					

ADSW型单级单吸卧式离心泵

ADSW SINGLE-STAGE SINGLE-SUCTION HORIZONTAL CENTRIFUGAL PUMP

AIDASEN WATER

泵安装尺寸图表

PUMP DIMENSION TABLE

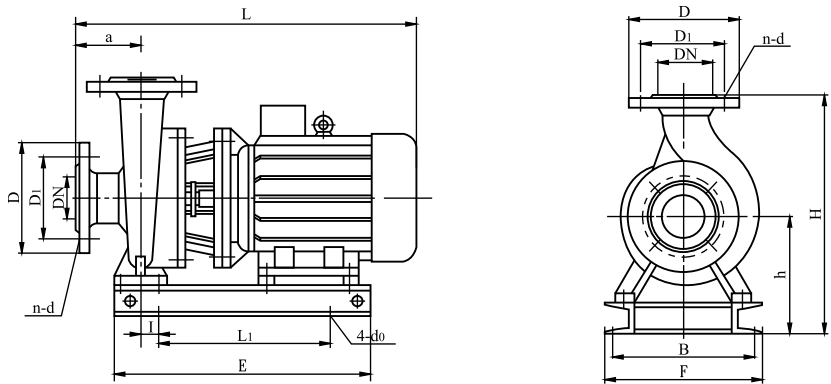

型 号 Type	外形尺寸Outline dimensionas				安 装 尺 寸 Installation dimensionas						进出口法兰尺寸 Inlet-outlet flange dimensionas			
	L	H	E	F	a	h	L1	B	I	4-d0	DN	D	D1	n-d
65-315A	845	582	610	410	105	325	500	370	12	φ 18	φ 65	φ 185	φ 145	4- φ 18
65-315B	825	582	610	410	105	325	500	370	12					
65-100(I)	545	376	490	390	100	216	270	340	18					
65-100(I)A	505	376	490	390	100	216	270	340	11					
65-125(I)	630	436	550	400	105	232	340	350	27					
65-125(I)A	570	422	500	390	105	212	285	340	22					
65-160(I)	640	465	550	400	100	265	270	340	10					
65-160(I)A	640	465	550	400	100	265	270	340	10					
65-160(I)B	640	465	550	400	100	265	340	350	10					
65-200(I)	748	486	670	460	100	276	400	410	24					
65-200(I)A	748	486	670	460	100	276	400	410	24					
65-200(I)B	638	486	550	400	100	276	340	350	25					
65-250(I)	830	546	670	490	125	296	400	430	21					
65-250(I)A	810	546	670	490	125	296	400	430	19					
65-250(I)B	765	546	670	490	125	296	400	430	19					
65-315(I)	1040	560	720	350	125	325	600	310	30					
65-315(I)A	935	560	700	350	125	325	600	310	30					
65-315(I)B	890	560	650	350	125	325	500	310	30					
80-100	545	412	480	360	100	212	290	300	18	φ 18	φ 80	φ 200	φ 160	8- φ 18
80-100A	505	412	490	390	100	212	270	340	11					
80-125	630	446	550	400	95	242	340	350	27					
80-125A	567	422	500	390	95	224	270	340	22					
80-160	640	466	550	400	100	260	340	350	10					
80-160A	640	466	550	400	100	260	340	350	10					
80-160B	640	466	550	400	100	260	340	350	10					
80-200	748	486	670	490	100	276	400	410	24					
80-200A	748	486	670	490	100	276	400	410	24					
80-200B	638	486	550	400	100	276	340	350	25					
80-250	830	546	730	560	125	296	450	470	21					
80-250A	810	546	670	490	125	296	400	430	19					
80-250B	765	546	670	460	125	296	400	410	19					
80-315	957	640	720	410	135	345	540	370	5					
80-315A	957	640	720	410	135	345	540	370	5					
80-315B	957	640	720	410	135	325	540	370	5					
80-315C	852	640	600	410	135	340	460	370	6					
80-350	957	686	720	410	135	370	540	370	5					
80-350A	957	686	720	410	135	370	540	370	5					
80-350B	957	686	720	410	135	370	540	370	5					
80-100(I)	640	491	500	400	105	266	340	350	20					
80-100(I)A	580	491	500	390	105	266	285	340	20					
80-125(I)	760	481	670	490	105	276	400	410	15					
80-125(I)A	660	491	550	400	105	276	340	350	20					
80-160(I)	750	524	670	490	110	276	400	410	17					
80-160(I)A	750	524	670	490	110	276	400	410	17					

泵安装尺寸图表

PUMP DIMENSION TABLE

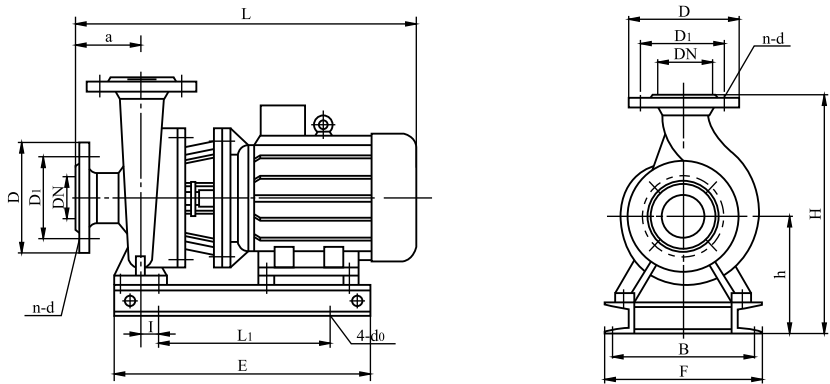

型 号 Type	外形 尺寸Outline dimensionas				安 装 尺 寸 Installation dimensionas						进 出口 法 兰 尺 寸 Inlet-outlet flange dimensionas							
	L	H	E	F	a	h	L1	B	I	4-d0	DN	D	D1	n-d				
80-160(I)B	750	524	550	400	110	276	340	350	17	φ 18	φ 80	φ 200	φ 160	8- φ 18				
80-200(I)	820	506	730	560	100	286	450	470	23									
80-200(I)A	800	506	670	530	100	265	400	430	23									
80-200(I)B	760	506	670	490	100	265	400	430	19									
80-250(I)	940	600	715	410	125	321	520	370	12	φ 22								
80-250(I)A	940	600	715	410	125	321	520	370	12									
80-250(I)B	940	600	715	410	125	321	520	370	12									
80-315(I)	1149	746	910	410	130	450	660	370	30									
80-315(I)A	1149	760	840	410	130	375	640	370	5									
80-315(I)B	1149	676	770	410	130	350	560	370	11									
80-315(I)C	1109	676	735	410	130	350	540	370	0	φ 18					φ 100	φ 220	φ 180	8- φ 18
100-100	650	491	500	400	105	266	340	350	20									
100-100A	650	491	500	390	105	266	285	340	20									
100-125	760	491	670	490	105	276	400	410	15									
100-125A	660	491	550	400	105	276	340	350	20									
100-160	750	524	670	490	110	276	400	410	17									
100-160A	750	524	670	490	110	276	400	410	17									
100-160B	750	524	670	490	110	276	400	410	17									
100-200	820	526	730	560	100	296	450	470	23									
100-200A	800	526	670	530	100	296	400	430	23									
100-200B	760	526	670	490	100	296	400	410	19									
100-250	940	600	715	410	125	321	520	370	12		φ 22							
100-250A	940	600	715	410	125	346	520	370	12									
100-250B	940	600	715	410	125	346	520	370	12									
100-315	1149	746	910	560	125	450	660	520	30									
100-315A	1149	700	840	450	125	375	640	410	5									
100-315B	1149	676	770	450	125	360	560	410	11									
100-350	1210	790	960	500	130	420	700	460	30	φ 18								
100-350A	1665	790	900	500	130	420	660	460	30									
100-350B	1090	765	830	450	130	396	600	410	30									
100-100(I)	740	491	560	335	105	276	400	295	20									
100-125(I)	740	491	560	335	105	276	400	295	20									
100-125(I)A	740	491	560	335	105	276	400	295	20									
100-160(I)	850	546	620	360	105	296	440	320	23	φ 22								
100-160(I)A	830	546	620	360	105	296	440	285	23									
100-200(I)	940	576	715	410	125	326	520	370	12									
100-200(I)A	940	576	715	410	125	326	520	370	12									
100-200(I)B	875	616	700	360	125	326	500	320	12									
100-250(I)	1140	690	850	490	125	390	660	450	15									
100-250(I)A	1070	666	770	450	125	366	660	410	15	φ 22								
100-250(I)B	1000	620	750	410	125	320	660	370	15									
125-100	783	526	575	330	125	266	420	295	7									
125-100A	683	526	485	330	125	266	320	295	12	φ 22	φ 125	φ 250	φ 210	8- φ 18				

泵安装尺寸图表

PUMP DIMENSION TABLE

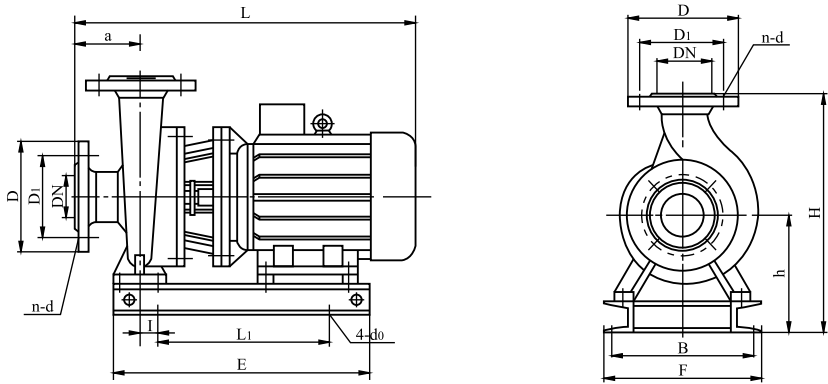

型 号 Type	外形尺寸 Outline dimensionas				安装尺寸 Installation dimensionas						进出口法兰尺寸 Inlet-outlet flange dimensionas			
	L	H	E	F	a	h	L1	B	I	4-d0	DN	D	D1	n-d
125-125	783	554	575	330	125	266	420	295	7	φ 19	φ 125	φ 250	φ 210	8- φ 18
125-125A	783	554	575	330	125	266	420	295	7					
125-160	848	554	620	360	125	296	440	320	21					
125-160A	828	554	620	360	125	296	440	320	19					
125-160B	783	554	575	360	125	296	420	320	7					
125-200	936	600	720	410	125	320	500	370	6					
125-200A	936	600	720	410	125	320	500	370	6					
125-200B	831	586	645	370	125	306	500	330	7					
125-250	1143	670	815	490	155	370	500	450	5					
125-250A	1070	660	740	440	150	345	500	400	10					
125-250B	1000	620	740	410	150	320	500	370	7					
125-315	1205	746	960	500	145	420	600	460	25					
125-315A	1155	746	900	500	145	420	600	460	30					
125-315B	1155	746	900	450	145	420	600	410	30					
150-125	783	525	575	330	125	266	420	295	7	φ 22	φ 150	φ 285	φ 240	8- φ 22
150-125A	783	525	575	330	125	266	420	295	7					
150-160	848	554	620	360	125	296	440	320	21					
150-160A	828	554	620	330	125	296	440	295	19					
150-160B	783	554	575	330	125	296	420	295	7					
150-200	936	690	740	410	115	346	540	370	6					
150-200A	936	690	740	410	115	346	540	370	6					
150-200B	831	586	645	410	115	316	460	370	7					
150-250(I)	1175	750	890	560	145	396	680	520	20					
150-250(I)A	1095	720	820	510	145	396	640	470	5					
150-250(I)B	1010	695	750	450	145	396	540	410	21					
150-315(I)	965	778	750	630	145	400	600	590	15					
150-315(I)A	935	778	750	550	140	426	600	510	15					
150-315(I)B	1155	806	720	550	135	426	600	510	10					
150-350	1205	746	940	410	135	396	720	370	25					
150-350A	1205	746	940	410	135	396	720	370	25					
150-350B	1205	746	940	410	135	396	720	370	25					
150-200(I)	845	696	640	410	145	366	440	370	12					
150-200(I)A	845	696	640	410	145	366	440	370	12					
150-250(I)	865	715	650	410	145	366	440	370	12					
150-250(I)A	845	715	640	410	145	366	440	370	16					
150-250(I)B	800	715	600	410	145	366	400	370	15					
150-315(I)	960	806	745	510	135	426	600	470	8					
150-315(I)A	865	780	720	510	135	406	600	470	22					
150-315(I)B	865	780	680	510	135	406	400	470	22					
150-400(I)	1020	866	780	510	155	461	600	470	11					
150-400(I)A	980	866	760	510	155	461	600	470	10					
150-400(I)B	980	866	760	510	155	461	600	470	8					
150-400(I)C	875	846	720	510	155	430	500	470	8					

泵安装尺寸图表

PUMP DIMENSION TABLE

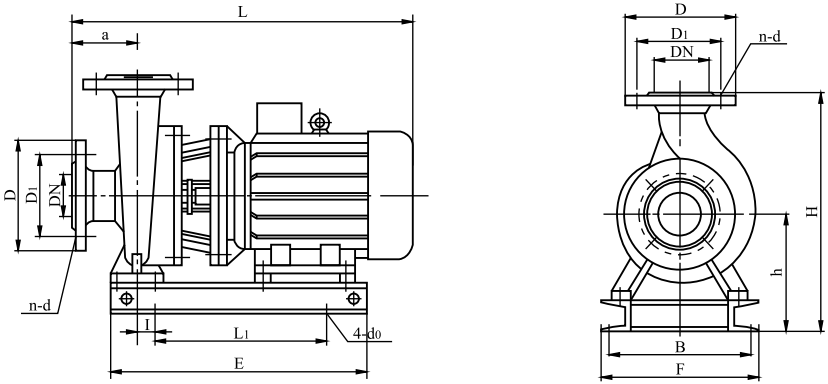

型 号 Type	外形尺寸 Outline dimensionas				安装尺寸 Installation dimensionas						进出口法兰尺寸 Inlet-outlet flange dimensionas			
	L	H	E	F	a	h	L1	B	I	4-d0	DN	D	D1	n-d
200-200	845	696	720	410	145	366	440	370	16	φ 22	φ 200	φ 340	φ 295	12- φ 22
200-200A	845	696	720	410	145	366	440	370	16					
200-250	905	746	690	410	185	376	460	370	12					
200-250A	885	746	650	410	185	376	460	370	16					
200-250B	840	746	600	410	185	376	460	370	15					
200-315	980	816	745	510	165	426	600	470	8					
200-315A	925	816	720	510	165	426	600	470	8					
200-315B	900	791	680	510	165	406	500	470	22					
200-400	1020	886	780	510	155	461	600	470	11					
200-400A	980	886	750	510	155	461	600	470	10					
200-400B	980	886	745	510	155	461	600	470	8					
200-400C	875	866	705	510	155	436	480	470	8					
200-200(I)	925	796	720	510	150	406	500	470	5					
200-200(I)A	885	796	680	510	150	406	440	470	16					
200-250(I)	990	826	760	510	164	426	520	470	8					
200-250(I)A	885	806	720	510	164	406	480	470	8					
200-250(I)B	865	806	680	510	164	406	420	470	12					
200-315(I)	1150	880	870	560	152	461	620	520	12					
200-315(I)A	1060	865	790	560	168	461	600	520	8					
200-315(I)B	1040	880	770	560	168	461	520	520	8					
200-400(I)	1255	896	1000	560	168	461	760	520	15					
200-400(I)A	1190	896	935	560	168	461	700	520	12					
200-400(I)B	1120	896	865	560	168	461	640	520	8					
200-400(I)C	1035	896	795	560	168	461	580	520	3					
200-500(I)	1345	1080	1120	680	145	536	800	630	5					
200-500(I)A	1268	1116	1065	680	145	536	760	630	5					
200-500(I)B	1180	1096	1020	680	145	516	760	630	5					
200-500(I)C	1180	1096	995	680	145	516	760	630	5					
250-250	1110	906	820	510	210	461	580	470	8					
250-250A	1085	906	800	510	210	461	580	470	8					
250-315	1290	975	950	600	225	476	700	560	12					
250-315A	1220	920	900	600	225	476	640	560	12					
250-315B	1105	875	860	600	225	476	580	560	12					
250-400	1300	1030	1070	630	200	496	760	590	15					
250-400A	1220	1010	1020	630	200	476	680	590	12					
250-400B	1220	1000	980	630	200	476	680	590	12					
250-480	2200	1164	1155	660	215	564	860	620	18					
250-480A	1600	1164	1130	660	215	564	860	620	5					
250-480B	1510	1164	1060	660	215	564	780	620	10					
250-500	1775	1185	1380	670	200	535	1000	620	-30					
250-500A	1590	1185	1300	670	200	530	920	620	-30					
250-500B	1550	1185	1250	670	200	530	900	620	-30					

ADSW型单级单吸卧式离心泵

ADSW SINGLE-STAGE SINGLE-SUCTION HORIZONTAL CENTRIFUGAL PUMP

AIDASEN WATER

泵安装尺寸图表

PUMP DIMENSION TABLE

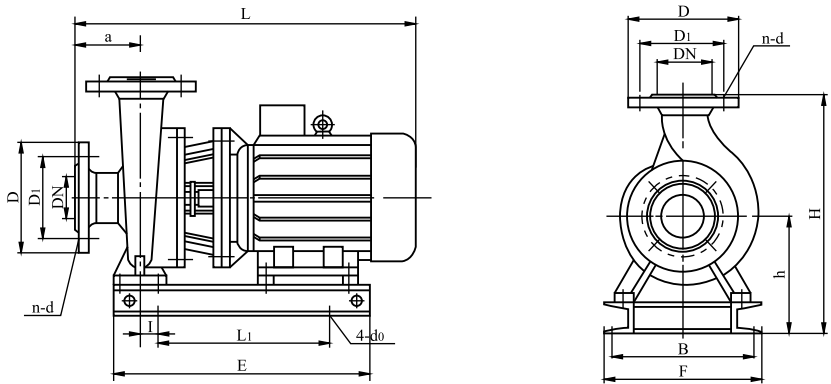

型 号 Type	外形尺寸 Outline dimensionas				安装尺寸 Installation dimensionas						进出口法兰尺寸 Inlet-outlet flange dimensionas			
	L	H	E	F	a	h	L1	B	I	4-d0	DN	D	D1	n-d
300-235	1280	1150	930	720	280	560	740	680	16	φ 22	φ 300	φ 460	φ 410	12- φ 26
300-235A	1160	1150	850	720	280	545	680	680	16					
300-235B	1160	970	830	720	245	545	700	680	30					
300-250	1340	995	930	720	245	545	900	680	30					
300-250A	1270	970	850	720	245	545	700	680	30					
300-300	1340	1075	1080	720	260	560	700	680	20					
300-300A	1270	1045	980	720	260	560	680	680	22					
300-300B	1155	1000	900	720	260	560	640	680	20					
300-380	1780	1320	1450	810	260	585	1150	770	25					
300-380A	1780	1320	1450	810	260	585	1150	770	25					
300-380B	1720	1170	1300	810	260	585	1000	770	25					
300-315	1380	1090	1160	610	260	400	840	570	16					
300-315A	1330	1025	1100	610	260	400	800	570	16					
300-315B	1255	1025	1050	690	260	370	740	570	20					
300-400	1570	1164	1090	660	280	549	780	620	25					
300-400A	1470	1164	1050	660	280	549	780	680	25					
300-460	1770	1180	1240	730	280	530	1000	680	25					
300-460A	1770	1180	1240	730	280	530	1000	680	25					
300-460B	1450	1180	1220	730	280	530	1000	680	25					
300-500	1668	1225	1400	810	280	475	1200	770	12					
300-500A	1555	1225	1350	810	280	475	1160	770	12					
300-500B	1478	1180	1350	810	280	425	1160	770	12					
300-500C	1356	1088	1220	810	280	425	1000	770	12					
300-235(I)	1610	1178	1220	720	250	572	800	680	20					
300-235(I)A	1610	1178	1220	720	250	572	800	680	20					
350-250	1350	1020	1100	690	280	370	800	650	20	φ 22	φ 350	φ 520	φ 470	12- φ 26
350-250A	1280	1020	1000	690	280	370	700	650	20					
350-315	1400	1050	1090	690	280	400	840	650	20					
350-315A	1320	1050	1050	690	280	400	800	650	20					
350-315B	1320	1050	1050	690	280	400	800	650	20					
350-400	1510	1210	1195	660	280	549	880	620	20					
350-400A	1450	1210	1175	660	280	549	800	620	20					
350-400B	1400	1210	1100	660	280	549	750	620	20					
350-460	1920	1250	1370	780	280	480	1100	730	25					
350-460A	1920	1250	1370	780	280	480	1100	730	25					
350-480	1720	1250	1400	780	280	480	1100	730	25					
350-480A	1680	1250	1400	780	280	480	1100	730	25					
350-480B	1560	1250	1300	780	280	480	1050	730	20					
400-250	1450	1132	1100	730	290	578	800	680	20					
400-315	1720	1132	1160	730	290	578	900	680	20					
500-250	1700	1160	1400	880	380	540	1100	840	20					
500-315	1750	1160	1400	880	380	540	1100	840	20	φ 26	φ 400	φ 580	φ 525	16- φ 26
										φ 26	φ 500	φ 715	φ 650	20- φ 30

ADSWD 泵性能参数表

ADSWD PUMP PERFORMANCE DATA

型 号 Type	流 量 Q Capacity		扬程 Head H (m)	效率 Eff. η (%)	电机 功率 Power P (kW)	转速 Speed n (r/min)	必需汽 蚀余量 (NPSH)r (m)	重量 Weight (kg)	型 号 Type	流 量 Q Capacity		扬程 Head H (m)	效率 Eff. η (%)	电机 功率 Power P (kW)	转速 Speed n (r/min)	必需汽 蚀余量 (NPSH)r (m)	重量 Weight (kg)
	(m³/h)	(L/s)								(m³/h)	(L/s)						
40-160	2.2 3.2 4.2	0.61 0.89 1.17	8.3 8 7.5	39	0.37	1450	2.3	46	65-125	8.75 12.5 16.3	2.4 3.5 4.5	5.4 5 4.5	66	0.37	1450	2.5	55
40-200	2.2 3.2 4.2	0.61 0.89 1.17	12.8 12.5 12	31	0.55	1450	2.3	56	65-160	8.75 12.5 16.3	2.4 3.5 4.5	8.6 8 6.88	61	0.55	1450	2.5	65
40-250	2.2 3.2 4.2	0.61 0.89 1.17	20.5 20 18.5	27	1.1	1450	2.3	80	65-200	8.75 12.5 16.3	2.4 3.5 4.5	13.2 12.5 11.4	58	1.1	1450	2.5	73
40-250A	2.0 3.0 3.9	0.56 0.83 1.08	18 17.5 16.3	27	0.75	1450	2.3	70	65-200A	8.2 11.8 15.3	2.3 3.3 4.3	11.6 11 10	56	0.75	1450	2.5	65
40-250B	1.9 2.8 3.5	0.53 0.78 0.97	15.4 15 14	26	0.55	1450	2.3	60	65-250	8.75 12.5 16.3	2.4 3.5 4.5	20.5 20 19.1	50	2.2	1450	2.5	105
40-125(I)	4.4 6.3 8.2	1.2 1.75 2.3	5.3 5.0 4.5	56	0.25	1450	2.3	45	65-250A	8.2 11.7 15.3	2.3 3.3 4.3	17.9 17.5 16.8	49	1.5	1450	2.5	95
40-160(I)	4.4 6.3 8.2	1.2 1.75 2.3	8.3 8.0 7.5	50	0.55	1450	2.3	55	65-250B	7.5 10.8 14	2.1 3 3.9	15.3 15 14.4	48	1.1	1450	2.5	85
40-200(I)	4.4 6.3 8.2	1.2 1.75 2.3	12.8 12.5 12	44	0.75	1450	2.3	65	65-315	8.75 12.5 16.3	2.4 3.5 4.5	32 31.2 30.5	41	4	1450	2.5	130
40-250(I)	4.4 6.3 8.2	1.2 1.75 2.3	20.3 20 19.4	39	1.5	1450	2.3	90	65-315A	8.3 11.9 15.5	2.3 3.3 4.3	28.8 28 27.5	41	4	1450	2.5	130
40-250(I)A	4.1 5.8 7.6	1.1 1.6 2.1	17.8 17.5 17	37	1.1	1450	2.3	80	65-315B	7.85 11.3 14.6	2.2 3.1 4	25.8 25.3 24.5	38	3	1450	2.5	115
40-250(I)B	3.8 5.4 7	1.1 1.5 1.9	15.4 15 14.5	36	0.75	1450	2.3	70	65-125(I)	17.5 25 32.5	4.86 6.94 9.03	5.5 5 4.25	72	0.75	1450	3.0	70
50-125	4.4 6.3 8.2	1.2 1.75 2.3	5.3 5 4.45	56	0.25	1450	2.3	45	65-160(I)	17.5 25 32.5	4.86 6.94 9.03	8.75 8 7	71	1.1	1450	3.0	78
50-160	4.4 6.3 8.2	1.2 1.75 2.3	8.3 8 7.5	51	0.55	1450	2.3	55	65-200(I)	17.5 25 32.5	4.86 6.94 9.03	13.4 12.5 11.5	67	2.2	1450	3.0	98
50-200	4.4 6.3 8.2	1.2 1.75 2.3	13 12.5 12	45	0.75	1450	2.3	65	65-200(I)A	16.4 23.5 30.5	4.56 6.53 8.47	11.8 11 10	65	1.5	1450	3.0	88
50-250	4.4 6.3 8.2	1.2 1.75 2.3	20.5 20 19.4	39	1.5	1450	2.3	90	65-250(I)	17.5 25 32.5	4.86 6.94 9.03	20.8 20 18	60	3	1450	3.0	128
50-250A	4.1 5.8 7.6	1.14 1.45 1.9	17.9 17.5 17	37	1.1	1450	2.3	80	65-250(I)A	16.3 23.4 30.5	4.53 6.5 8.47	18.3 17.5 15.8	58	3	1450	3.0	125
50-250B	3.8 5.4 7	1.06 1.5 1.94	15.4 15 14.5	36	0.75	1450	2.3	70	65-250(I)B	15 21.7 28	4.17 6.03 7.78	15.5 15 13.5	56	2.2	1450	3.0	115
50-125(I)	8.75 12.5 16.3	2.4 3.5 4.5	5.38 5 4.5	66	0.37	1450	2.5	55	65-315(I)	15 25 30	4.17 6.94 8.33	32.5 32 31.5	50	5.5	1450	3.0	190
50-160(I)	8.75 12.5 16.3	2.4 3.5 4.5	8.6 8 6.88	63	0.55	1450	2.5	65	65-315(I)A	14 23 28	3.89 6.39 7.78	28 27.5 27.4	49	4	1450	3.0	170
50-200(I)	8.75 12.5 16.3	2.4 3.5 4.5	13.2 12.5 11.4	58	1.1	1450	2.5	73	65-315(I)B	12.1 20.2 24.3	3.36 5.61 6.75	21.5 21 20.6	48	4	1450	3.0	155
50-200(I)A	8.2 11.8 15.3	2.3 3.3 4.3	11.6 11 10	56	0.75	1450	2.5	65	80-125	17.5 25 32.5	4.86 6.94 9.03	5.5 5 4.25	71	0.75	1450	3.0	70
50-250(I)	8.75 12.5 16.3	2.4 3.5 4.5	20.5 20 19.1	51	2.2	1450	2.5	105	80-160	17.5 25 32.5	4.86 6.94 9.03	8.75 8 7	69	1.1	1450	3.0	78
50-250(I)A	8.2 11.7 15.3	2.3 3.3 4.3	17.9 17.5 16.8	50	1.5	1450	2.5	95	80-200	17.5 25 32.5	4.86 6.94 9.03	13.4 12.5 11.5	67	2.2	1450	3.0	98
50-250(I)B	7.5 10.8 14	2.1 3 3.9	15.3 15 14.4	49	1.1	1450	2.5	85	80-200A	16.4 23.5 30.5	4.56 6.53 8.47	11.8 11 10	65	1.5	1450	3.0	88
50-315(I)	8.75 12.5 16.3	2.4 3.5 4.5	32 31.5 30.5	43	4	1450	2.5	130	80-250	17.5 25 32.5	4.86 6.94 9.03	20.8 20 18	60	3	1450	3.0	128
50-315(I)A	8.3 11.9 15.5	2.3 3.3 4.3	28.8 28 25	42	4	1450	2.5	130	80-250A	16.3 23.4 30.5	4.53 6.5 8.47	18.3 17.5 15.8	59	3	1450	3	125
50-315(I)B	7.85 11.3 14.6	2.2 3.1 4.1	25.8 25.5 24.5	38	3	1450	2.5	115	80-250B	15 21.7 28	4.17 6.03 7.78	15.5 15 13.5	58	2.2	1450	3	120

ADSW型单级单吸卧式离心泵

ADSW SINGLE-STAGE SINGLE-SUCTION HORIZONTAL CENTRIFUGAL PUMP

AIDASEN WATER

ADSWD 泵性能参数表

ADSWD PUMP PERFORMANCE DATA

型 号 Type	流 量 Q Capacity		扬程 Head H (m)	效率 Eff. η (%)	电机 功率 Power P (kW)	转速 Speed n (r/min)	必需汽 蚀余量 (NPSH)r (m)	重量 Weight (kg)
	(m³/h)	(L/s)						
80-315	17.5 25 32.5	4.86 6.94 9.03	32.5 32 30.5	53	5.5	1450	3	190
80-315A	16.3 23.3 30.3	4.53 6.47 8.42	28 27.5 26.8	52	4	1450	3	190
80-315B	15.5 22.3 29	4.31 6.19 8.06	25.5 25 24.5	51	4	1450	3	170
80-125(I)	35 50 65	9.72 13.9 18.1	5.88 5 3.5	74	1.5	1450	4.5	93
80-160(I)	35 50 65	9.72 13.9 18.1	9.13 8 6	74	2.2	1450	4.5	105
80-160(I)A	32.7 46.8 60.5	9.08 13 16.8	8 7 5.3	72	1.5	1450	4.5	98
80-200(I)	35 50 65	9.72 13.9 18.1	13.5 12.5 10.5	72	3	1450	4	130
80-200(I)A	32.7 46.8 60.5	9.08 13 16.8	11.9 11 9.25	71	3	1450	4	125
80-250(I)	35 50 65	9.72 13.9 18.1	21.8 20 17	69	5.5	1450	4	185
80-250(I)A	32.7 46.8 60.5	9.08 13 16.8	19 17.5 14.9	67	4	1450	4	165
80-250(I)B	30.5 43.5 56.5	8.47 12.1 15.7	16.3 15 12.8	65	3	1450	4	150
80-315(I)	35 50 65	9.72 13.9 18.1	33 31.3 28.5	66	11	1450	4	280
80-315(I)A	33.3 47.5 61.5	9.25 13.2 17.1	29.8 28.3 25.8	64	7.5	1450	4	230
80-315(I)B	31.5 45 58.5	8.75 12.5 16.3	26.5 25.3 23	64	7.5	1450	4	225
100-125	35 50 65	9.72 13.9 18.1	5.88 5 3.5	75	1.5	1450	4.5	80
100-160	35 50 65	9.72 13.9 18.1	9.13 8 6	75	2.2	1450	4.5	85
100-160A	32.7 46.8 60.5	9.08 13 16.8	8 7 5.3	73	1.5	1450	4.5	80
100-200	35 50 65	9.72 13.9 18.1	13.5 12.5 10.5	74	3	1450	4	115
100-200A	32.7 46.8 60.5	9.08 13 16.8	11.9 11 9.25	72	3	1450	4	110
100-250	35 50 65	9.72 13.9 18.1	21.8 20 17	70	5.5	1450	4	175
100-250A	32.7 46.8 60.5	9.08 13 16.8	19 17.5 14.9	68	4	1450	4	150
100-250B	30.5 43.5 56.5	8.47 12.1 15.7	16.3 15 12.8	65	3	1450	4	135
100-315	35 50 65	9.72 13.9 18.1	33 31.3 28.5	66	11	1450	4	260
100-315A	33.3 47.5 61.5	9.25 13.2 17.1	29.8 28.3 25.8	64	7.5	1450	4	220
100-315B	31.5 45 58.5	8.75 12.5 16.3	26.5 25.3 23	63	7.5	1450	4	215
100-125(I)	48 80 96	13.3 22.2 26.7	5.5 5 4.3	76	2.2	1450	3	100
100-160(I)	48 80 96	13.3 22.2 26.7	9 8 7	74	4	1450	3	105
100-200(I)	48 80 96	13.3 22.2 26.7	13.8 12.5 11.5	73	5.5	1450	3	150

型 号 Type	流 量 Q Capacity		扬程 Head H (m)	效率 Eff. η (%)	电机 功率 Power P (kW)	转速 Speed n (r/min)	必需汽 蚀余量 (NPSH)r (m)	重量 Weight (kg)
	(m³/h)	(L/s)						
100-200(I)A	45 75 90	12.5 20.8 25	12 11 10	72	4	1450	3	130
100-250(I)	48 80 96	13.3 22.2 26.7	22 20 18.3	72	7.5	1450	2.8	190
100-250(I)A	45 75 90	12.5 20.8 25	19 17.5 16	71	7.5	1450	2.8	185
100-250(I)B	41.5 69 83	11.5 19.2 23	16.3 15 13.8	70	5.5	1450	2.8	175
100-315(I)	48 80 96	13.3 22.2 26.7	33.3 32 29.8	67	15	1450	2.5	295
100-315(I)A	45 75 90	12.5 20.8 25	29.3 27.5 26	66	11	1450	2.5	270
100-315(I)B	43 72 86	11.9 20 23.9	26.5 25 23.8	65	11	1450	2.5	265
100-400(I)	60 100 120	16.67 22.78 33.33	52 50 48.5	65	30	1450	3	375
100-400(I)A	56.4 94 113	15.67 26.11 31.39	46 44 43	65	22	1450	3	295
100-400(I)B	52.3 87 105	14.53 24.17 29.17	39 38 37	64	18.5	1450	3	257
125-160	48 80 96	13.3 22.2 26.7	9 8 7	76	3	1450	3	140
125-200	48 80 96	13.3 22.2 26.7	13.8 12.5 11.5	75	5.5	1450	3	190
125-200A	45 75 90	12.5 20.8 25	12.1 11 10.1	74	4	1450	3	170
125-250	48 80 96	13.3 22.2 26.7	21.8 20 18.3	74	7.5	1450	2.8	200
125-250A	45 75 90	12.5 20.8 25	19 17.5 16	73	7.5	1450	2.8	215
125-250B	41.5 69 83	11.5 19.2 23.8	16.3 15 13.8	72	5.5	1450	2.8	220
125-315	48 80 96	13.3 22.2 26.7	33.3 32 29.8	69	15	1450	2.5	325
125-315A	45 75 90	12.5 20.8 25	29.3 27.5 26	68	11	1450	2.5	305
125-315B	43 71.5 86	11.9 19.9 23.9	26.5 25 23.8	67	11	1450	2.5	300
125-250	60 100 120	16.7 27.8 33.3	21.8 20 18	74	11	1450	4	310
125-250A	56 93.5 112	15.6 26 31.1	19 17.5 15.8	73	7.5	1450	4	275
125-250B	52 86.5 104	14.4 24 28.9	16.3 15 13.5	72	7.5	1450	4	270
125-315	60 100 120	16.7 27.8 33.3	33.3 32 30	74	15	1450	4	340
125-315A	56 93.5 112	15.6 26 31.1	29 27.5 26.3	73	15	1450	4	335
125-315B	52 86.5 104	14.4 24 28.9	25 23.8 22.8	71	11	1450	4	315
125-400	60 100 120	16.7 27.8 33.3	52 50 48.5	53 65 67	30	1450	3	390
125-400A	56 94 112	15.6 26.1 31.1	45.8 44 42	64	22	1450	3	370
125-400B	52 87 104	14.4 24.2 28.9	39 37.5 36	62	18.5	1450	3	350

ADSWD 泵安装尺寸图表

ADSWD PUMP DIMENSION TABLE

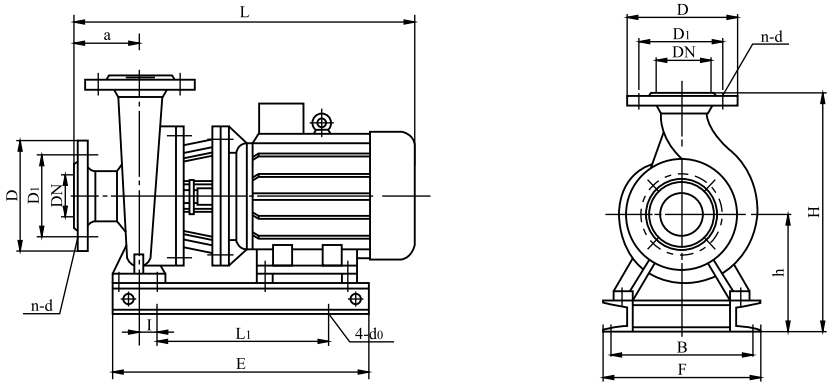

型 号 Type	外形尺寸 Outline dimensionas				安 装 尺 寸 Installation dimensionas						进 出 口 法 兰 尺 寸 Inlet-outlet flange dimensionas			
	L	H	E	F	a	h	L1	B	I	4-d0	DN	D	D1	n-d
40-160	425	374	320	250	85	224	240	215	7	φ 14	φ 40	φ 150	φ 110	4- φ 14
40-200	450	414	350	250	85	252	240	215	9					
40-250	480	496	360	330	90	376	240	295	12					
40-250A	460	496	350	330	90	376	240	295	12					
40-250B	445	472	340	330	90	352	240	295	5					
40-125(I)	372	340	240	205	80	204	180	170	16					
40-160(I)	385	367	310	250	80	224	200	215	15					
40-200(I)	455	436	340	260	85	276	220	240	26					
40-250(I)	515	490	410	330	100	296	260	295	15					
40-250(I)A	496	490	400	330	100	296	260	295	18					
40-250(I)B	485	490	385	330	100	296	260	295	18					
50-125	372	350	240	205	80	204	180	170	16	φ 18	φ 50	φ 165	φ 125	4- φ 18
50-160	385	377	310	250	80	224	200	215	15					
50-200	455	446	340	260	80	276	220	220	26					
50-250	515	501	410	330	100	296	260	295	15					
50-250A	495	501	400	330	100	296	260	295	18					
50-250B	485	501	385	330	100	296	260	295	18					
50-125(I)	450	362	345	220	90	204	200	185	18					
50-160(I)	452	437	350	275	100	252	200	240	22					
50-200(I)	488	446	360	275	100	276	240	240	0					
50-200(I)A	457	446	345	275	100	276	240	240	0					
50-250(I)	582	526	410	300	100	296	260	295	14					
50-250(I)A	554	526	380	330	100	296	260	295	14					
50-250(I)B	532	526	360	330	100	296	240	295	14					
50-315(I)	620	572	420	410	105	325	280	370	12					
50-315(I)A	605	572	400	410	105	325	260	370	12					
50-315(I)B	605	572	400	410	105	325	260	370	12					
65-125	450	372	345	220	85	204	200	185	18	φ 18	φ 65	φ 185	φ 145	4- φ 18
65-160	452	477	350	275	100	252	200	240	22					
65-200	488	456	360	275	100	276	240	240	0					
65-200A	457	456	345	275	100	276	240	240	0					
65-250	582	536	410	330	100	296	260	295	14					
65-250A	554	536	380	330	100	296	260	295	14					
65-250B	532	536	360	330	100	296	240	295	14					
65-315	620	582	420	410	105	325	280	370	12					
65-315A	605	582	400	410	105	325	260	370	12					
65-315B	605	582	400	410	105	325	260	370	12					

ADSWD 泵安装尺寸图表

ADSWD PUMP DIMENSION TABLE

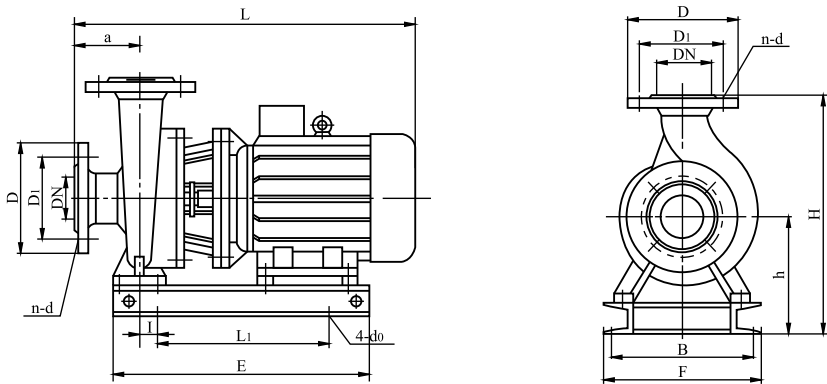

型 号 Type	外形尺寸 Outline dimensionas				安 装 尺 寸 Installation dimensionas						进出口法兰尺寸 Inlet-outlet flange dimensionas			
	L	H	E	F	a	h	L1	B	I	4-d0	DN	D	D1	n-d
65-125(I)	472	446	330	250	105	248	240	215	27	Φ 18	Φ 65	Φ 185	Φ 145	4- Φ 18
65-160(I)	498	486	345	290	100	276	240	250	10					
65-200(I)	542	486	370	275	100	276	240	235	24					
65-200(I)A	525	486	340	275	100	276	240	235	24					
65-250(I)	630	546	420	335	125	296	280	295	21					
65-250(I)A	615	546	400	335	125	296	260	295	19					
65-250(I)B	572	546	375	335	125	296	260	295	19					
65-315(I)	682	686	500	410	130	371	340	370	5					
65-315(I)A	682	686	500	410	130	371	340	370	5					
65-315(I)B	620	686	425	410	130	371	280	370	5					
80-125	472	446	330	250	95	248	240	215	27	Φ 18	Φ 80	Φ 200	Φ 160	8- Φ 18
80-160	498	486	345	290	100	276	240	250	10					
80-200	542	486	370	275	100	276	240	235	24					
80-200A	525	486	340	275	100	276	240	235	24					
80-250	630	546	420	335	125	296	280	295	21					
80-250A	615	546	400	335	125	296	260	295	19					
80-250B	572	546	375	335	125	296	260	295	19					
80-315	682	686	500	410	135	371	340	370	5					
80-315A	682	686	500	410	135	371	340	370	5					
80-315B	620	686	425	410	135	371	280	370	5					
80-125(I)	540	491	400	290	105	276	260	250	15					
80-160(I)	552	524	410	290	110	276	260	250	17					
80-160(I)A	526	524	380	290	110	276	260	250	17					
80-200(I)	562	526	425	325	100	296	280	285	23					
80-200(I)A	562	526	425	325	100	296	280	285	23					
80-250(I)	640	616	440	360	125	346	280	320	12					
80-250(I)A	626	616	415	360	125	346	260	320	12					
80-250(I)B	626	616	415	360	125	346	260	320	12					
80-315(I)	780	686	540	410	130	371	400	370	30					
80-315(I)A	746	686	515	410	130	371	360	370	5					
80-315(I)B	746	686	515	410	130	371	360	370	11					
100-125	540	491	400	290	105	276	260	250	15	Φ 18	Φ 100	Φ 220	Φ 180	8- Φ 18
100-160	552	524	410	290	110	276	260	250	17					
100-160A	526	524	380	290	110	276	260	250	17					
100-200	562	526	425	325	100	296	280	285	23					
100-200A	562	526	425	325	100	296	280	285	23					
100-250	640	616	440	360	125	346	280	320	12					

ADSWD 泵安装尺寸图表

ADSWD PUMP DIMENSION TABLE

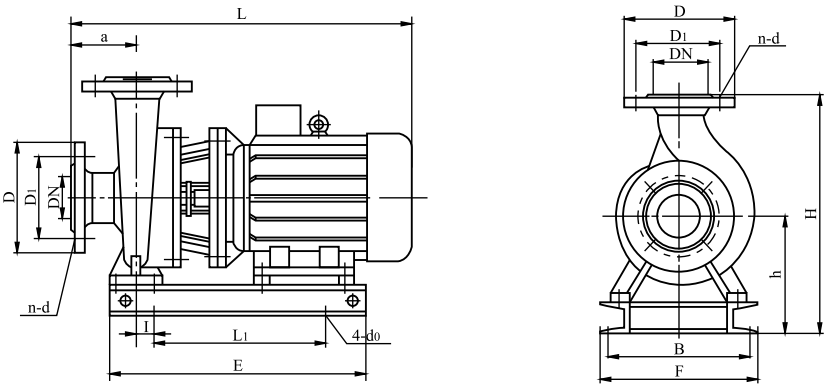

型 号 Type	外形尺寸 Outline dimensionas				安 装 尺 寸 Installation dimensionas						进出口法兰尺寸 Inlet-outlet flange dimensionas			
	L	H	E	F	a	h	L1	B	I	4-d0	DN	D	D1	n-d
100-250A	626	616	415	360	125	346	260	320	12	Φ 18	Φ 100	Φ 220	Φ 180	8- Φ 18
100-250B	626	616	415	360	125	346	260	320	12					
100-315	780	686	540	410	130	371	400	370	30					
100-315A	746	686	515	410	130	371	360	370	5					
100-315B	746	686	515	410	130	371	360	370	11					
100-125(I)	587	554	400	330	105	296	260	295	7					
100-160(I)	608	554	420	330	105	296	280	295	21					
100-200(I)	656	616	485	370	125	346	320	330	6					
100-200(I)A	656	616	485	370	125	346	320	330	6					
100-250(I)	802	636	540	370	125	346	400	330	5					
100-250(I)A	756	636	515	370	125	346	360	330	10					
100-250(I)B	756	636	515	330	125	346	360	330	7					
100-315(I)	835	705	580	410	130	375	420	370	25					
100-315(I)A	785	705	530	410	130	375	380	370	30					
100-315(I)B	785	705	530	410	130	375	380	370	30					
100-400(I)	980	776	730	510	125	420	600	470	30					
100-400(I)A	880	756	680	510	125	420	600	470	30					
100-400(I)B	860	756	680	510	125	400	450	470	30					
125-160	608	554	420	330	125	296	280	295	21	Φ 19	Φ 125	Φ 250	Φ 210	8- Φ 18
125-200	656	616	485	370	125	346	320	330	6					
125-200A	656	616	485	370	125	346	320	330	6					
125-250	802	636	540	370	150	346	400	330	5					
125-250A	756	636	515	370	150	346	360	330	10					
125-250B	756	636	515	330	154	346	360	330	7					
125-315	835	705	640	410	145	375	500	370	25					
125-315A	785	705	610	410	145	375	500	370	30					
125-315B	785	705	610	410	145	375	500	370	30					
125-250	828	736	570	410	145	396	420	370	20					
125-250A	778	736	540	410	145	396	420	370	5					
125-250B	778	736	540	410	145	396	420	370	21					
125-315	842	824	600	510	135	375	440	470	15					
125-315A	785	806	560	510	135	375	420	470	15					
125-315B	785	806	560	510	135	375	420	470	10					
125-400	980	776	730	510	125	420	600	470	30					
125-400A	880	776	680	510	125	420	600	470	30					
125-400B	860	756	680	510	125	400	600	470	30					

故障原因及排除方法 FAILURES CAUSES AND TROUBLESHOOTING

故障现象 Failure	可能产生的原因 Possible causes	排除方法 Troubleshooting
1、水泵不出水 No water from the pump	<div>a、进水口阀门未打开，进出口管路阻塞，叶轮流道阻塞</div> <div>b、电机运行方向不对，电机缺相转速很慢</div> <div>c、吸入管漏气</div> <div>d、泵没灌满液体，泵腔内有空气</div> <div>e、进口供水不足，吸程过高，底阀漏水</div> <div>f、管路阻力过大，泵选型不当</div> <div>a.Both inlet and outlet valves not opened,both inlet and outlet pipelines blocked,impeller' s flow-path blocked</div> <div>b.Uncorrect diredtion of motor' s running ,motor lack of phase and rotating speed very slow</div> <div>c.Air lesks from the suction pipe</div> <div>d.Pump not full of liquid,air exists inside of its cavity</div> <div>e.Water supply at inlet not enough,too high suction stroke,water leaks out of foot valve</div> <div>f.Too big resistance on pipeline,uncorrect selection of pump model</div>	<div>a、检查、去除阻隔塞物</div> <div>b、调整电机转向，坚固电机接线</div> <div>c、拧紧各密封面，排除空气</div> <div>d、打开泵上盖或打开排气阀，排尽空气</div> <div>e、停机检查、调整（并网自来水管和带吸程使用易出现此现象）</div> <div>f、减少管路弯道，重新选泵</div> <div>a.Check and get rid of the blocking matters</div> <div>b.Ajust the direction.tighten motor' s wirings</div> <div>c.Screw down cpver or exhaust valve to let air out copmletely</div> <div>d.Open pump cpver or exhaust valve to let air out completely</div> <div>e.Stop and check,adjust(this sitution is easy to occru for the water pipes in parallel network and use with suction stroke)</div> <div>f.Reduce bend-paths on pipeline,select pump</div>
2、水泵流量不足 Insufficient flow quantity of pump	<div>a、先按1原因检查</div> <div>b、管道、泵流道或叶轮部分阻塞，水垢沉积，阀门开度不足</div> <div>c、电压偏低</div> <div>d、叶轮磨损</div> <div>a. Check per the cuases in NO.1 first</div> <div>b.Pipeline,pump flow-path or impeller partially blocked,water-dirt deposited, valve not enough opened</div> <div>c.Volage too low</div> <div>d.Impeller worn out</div>	<div>a、先按1排除</div> <div>b、去除阻塞物，重新调整阀门开度</div> <div>c、稳压</div> <div>d、更换叶轮</div> <div>a.Troubleshoot per No.1 first</div> <div>b.Get rid of blocking matters,adjust the opening of valve</div> <div>c.Stabilize it</div> <div>d.Replace it</div>
3、功率过大 Power too heavy	<div>a、超过额定流量使用</div> <div>b、吸程过高</div> <div>c、泵轴承磨损</div> <div>a.Used with rated flow quantity surpsassed</div> <div>b.Too high suction srtoke</div> <div>c.Pump bearing worm out</div>	<div>a、调节流量，关小出口阀门</div> <div>b、降低</div> <div>c、更换轴承</div> <div>a.Adjust flow quantity,close outlet valve a bit</div> <div>b.Lower it</div> <div>c.Replace it</div>
4、杂音振动 Noise vibration	<div>a、管路支撑不稳</div> <div>b、液体混有所体</div> <div>c、产生汽蚀</div> <div>d、轴承损坏</div> <div>e、电机超载运行</div> <div>a. Pipiline unstably supported</div> <div>b.Liquid mixed with air</div> <div>c.Vapour corrosion produced</div> <div>d.Bearing worn out</div> <div>e.Motor voerloaded running</div>	<div>a、稳固管路</div> <div>b、提高吸入压力、排气</div> <div>c、降低真空度</div> <div>d、更换轴承</div> <div>e、调整按5</div> <div>a. Make it stable</div> <div>b.Raise suction pressure,exgaust</div> <div>c.Lower the vacuum</div> <div>d.Replace it</div> <div>e.Adjust per No.5</div>
5、电机交换 Motor heated	<div>a、流量过大，超载运行</div> <div>b、局部摩擦</div> <div>c、电机轴承损坏</div> <div>d、电压不足</div> <div>a.Too heavy flow quantity,overloaded running</div> <div>b.Partial friction</div> <div>c.Motor' s bearign damaged</div> <div>d.Voltage not enough</div>	<div>a、关小出口阀门</div> <div>b、检查排除</div> <div>c、更换轴承</div> <div>d、稳压</div> <div>a. Close outlet valve a bit</div> <div>b.Check and get rid of it</div> <div>c.Replace it</div> <div>d.Stabilize it</div>
6、水泵漏水 Water drops from the pump	<div>a、机械密封磨损</div> <div>b、泵体砂孔或破裂</div> <div>c、密封面不平整</div> <div>d、安装螺栓松懈</div> <div>a.Mechanicel seal worn out</div> <div>b.Sand-hole or breakdown with pump casing</div> <div>c.Seal-face not flat</div> <div>d.Mounting bolt loose</div>	<div>a、更换</div> <div>b、焊补或更换</div> <div>c、修整</div> <div>d、紧固</div> <div>a.Replace it</div> <div>b.Weld it or replace</div> <div>c.Flatten it</div> <div>d.Tighten it</div>

管路损耗参考表

管径	流量									
	1	2	4	6	8	10				
25	32.7	13.0								
38	3.5	14					15	20		
50	0.8	3.1	13				25	30	40	50
65		1.6	3.2	7.1	13	20			60	70
75		0.4	0.8	3.3	5.9	9.6				
100			0.23	0.8	1.3	2.1	6.8	8.6	13	19.4
125				0.23	0.4	0.63	1.3	2.7	4.1	5.9
150					0.16	0.26	0.58	1.1	1.6	2.3
175						0.11	0.27	0.5	0.74	1.05
200							0.13	0.26	0.37	0.53
250								0.07	0.12	0.18
300									0.07	0.12
									0.19	0.27
									0.37	0.49
									0.61	0.76
									0.9	1.1
									1.3	1.5
									1.5	1.8
									2.0	2.4
									2.4	2.7
									2.7	3.0

直管摩擦损失简表（供估计用）100m直管损失米数
以新铸铁管为标准，旧管加倍。

一定管路直径之最大流量限制

管路直径 (mm)	最大流量 (L/S)	最大流速 (m/s)	管路直径 (mm)	最大流量 (L/S)	最大流速 (m/s)
25	1	2.04	125	30.0	2.44
38	2.5	1.69	150	43.0	2.45
50	4.17	2.12	175	60.0	2.49
65	6.67	2.01	200	83.3	2.69
75	10.0	2.26	250	133.0	2.72
100	18.4	2.33	300	192.0	2.71

注：超过此限使管路损失显著增加。

阀及弯管折合直管长度（每个）

种类	折合直管直径倍数	备注
标准弯管	12	未畅开加倍
全开闸阀	25	
逆止阀	100	
底阀	100	部分堵塞加倍

注：例如100mm直径管，底阀折合100倍直径等于100×100=10000mm=10m
直径长度，假定流量为8L/S查上表，直管每100m损失1.3m，则10m损失
0.13m，即一个100mm底阀，流量为8L/S时，则损失扬程0.13m。